

RESOLUTION NO. 2023 - 82

A RESOLUTION AUTHORIZING THE ADMINISTRATION TO PURCHASE ONE (1) FIRE PARAMEDIC VEHICLE FROM BURGESS AMBULANCE SALES AT A STATE PURCHASE PRICE OF \$329,557.00, AND DECLARING AN EMERGENCY

WHEREAS, the City has been awarded a 2023 Community Development Block Grant (CDBG), and grant funds have been allocated in the amount of \$150,000.00 for the purchase of one (1) Fire Paramedic Vehicle; and

WHEREAS, in order to equip the Fire Department and expend the CDBG grant funds, the Fire Chief has solicited quotes for the assembly and purchase of a Fire Paramedic Vehicle from manufacturers authorized by the Ohio Department of Administrative Services aka the State Purchasing Program; and

WHEREAS, Burgess Ambulance Sales proposes to assemble and deliver one (1) Fire Paramedic Vehicle to the City of Parma Heights for a sum not to exceed Three Hundred and Twenty-Nine Thousand, Five Hundred and Fifty-Seven Dollars (\$329,557.00), as described in Exhibit "A", attached hereto and incorporated by reference; and

WHEREAS, Council may authorize the purchase pursuant to the State Purchasing Program without competitive bidding process based upon the authority granted to it in Article V Section 6 of the Charter, and Sections 145.08 and 145.09 of the Codified Ordinances.

NOW, THEREFORE, BE IT RESOLVED by the Council of the City of Parma Heights, County of Cuyahoga and State of Ohio:

Section 1: That the Administration is hereby authorized and directed to purchase from Burgess Ambulance Sales one (1) Fire Paramedic Vehicle and related safety equipment for the sum not to exceed \$329,557.00, as described in Exhibit "A", attached hereto and incorporated by reference.

Section 2: Council does hereby authorize the purchase pursuant to the State Purchasing Program without competitive bidding process pursuant to Article V Section 6 of the Charter, and Sections 145.08 and 145.09 of the Codified Ordinances.

Section 3: This Council finds and determines that all formal actions of this Council concerning and relating to the adoption of this Resolution were taken in an open meeting of this Council and that all deliberations of the Council and of any of its Committees comprised of a majority of the members of the Council that resulted in those formal actions were in meeting open to the public, in compliance with the law.

Section 4: This Resolution is declared to be an emergency measure necessary for the public peace, health and safety of the Municipality, and for the further reason it is necessary to place an immediate order to secure the vehicle and have the equipment installed for delivery for the efficient operation of the Fire Department; wherefore, this Resolution shall be in full force and effect immediately upon its passage by Council and approval by the Mayor.

PASSED: November 13, '23

Thomas Rounds
PRESIDENT OF COUNCIL

ATTEST: Barbara Alled
CLERK OF COUNCIL

November 13, 2023
APPROVED

FILED WITH
THE MAYOR: November 13, '23

Marie Gallo
MAYOR MARIE GALLO

EXHIBIT A



Parma Heights Fire Department
Attn: Matt Bernard

Dear Chief Bernard,

If you wish to purchase through Burgess Ambulance Sales (STS Contract #800749), the following is a proposal for 1 (one) 2023 Road Rescue Ultramedic Module Demonstrator, mounted on a Ford F550 4x4 Diesel Chassis for the sum of **\$329,557.00**. This price includes all applicable manufacturers rebates, as well as all of the standard and additional options listed in the enclosed work order.

All Road Rescue ambulances come with the standard Road Rescue warranty. Delivery will be in September or October of 2024. Please call me with any questions or concerns at 800-541-9518. This quote is valid for 30 days from the above date.

Thank You,

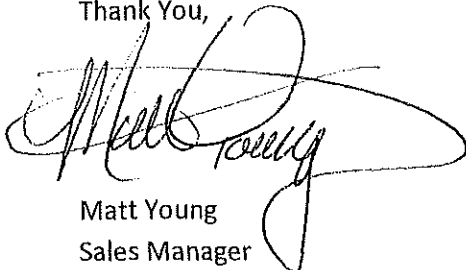

Matt Young
Sales Manager



BASI Demo
527 Wooster Road
Loudonville, OH 44842

Burgess Ambulance
Matt Young
527 Wooster Road
Loudonville, OH 44842
MJP

Rev. Date: 10/05/2023
Quote No: PINKED-0000
Job/Order No: 619163
10/06/2023 09:29:56

WO#: 619163

PART NO	S	DESCRIPTION	QTY	REF. NO
		== RR-Road Rescue Boilerplate - 1.017 11/12/21 ==		
		ORDER COORDINATOR		
00-00-0016		Order Coordinator - Mitchell Pettis- (321) 441-8035	1	BID INFORMATION
		INFORMATION		
00-01-0999		RR, Information - Scope, Purpose and Classification	1	
		WARRANTY		
00-02-8100		RR, Warranty, Documentation	1	
00-02-8200		RR, Warranty, Module Structural	1	00.02.8200-14
00-02-8300		RR, Warranty, Electrical, Standard System	1	00.02.8300-14
00-02-8400		RR, Warranty, Paint	1	0599997-14
00-02-8500		RR, Warranty, Conversion	1	00.02.8500-14
		== RR- Type 1 - UM 170" Module - 1.017 11/12/21 ==		
00-05-0103		RR, This unit built in accordance with KKK-A-1822F CN 10 Cabinet Requirements This unit as specified meets all requirements of KKK-A1822-F Change notice 10. All cabinets shall be labeled as to their capacity Rating.	1	
		01- CHASSIS REQUIREMENTS		
		FORD CHASSIS		
01-01-2632	U	RR, 2023 Ford F550, XLT 4X4, 193" W/B, 19,500 GVWR (Special Order) Estimated Auto throttle OEM Ford Dual Alternators OEM Ford Mirrors, OEM, Heated/Remote Cab seats OEM 40/20/40 split bench (Center removed) New for 2020- Sync 3 Enhanced voice recognition communication and entertainment system 8" LCD Capacitive Touch screen in center stack w/swipe Capability Pinch to Zoom capability AppLink 911 assist Apple carPlay and Android Auto Smart-charging USB-C Ports (2)	1	1.1.220D
01-02-0100		Domestic Chassis	1	
		CHASSIS OPTIONS		
		ALTERNATORS		
01-03-1001		Alternator - Standard OEM	1	9980003
		SUSPENSION		
01-07-0120		RR, Front Suspension, Ford F-Series (4x4)	1	
01-07-1009		RR, Front Sway Bar, OEM	1	
01-07-8007		RR, Rear Suspension, Liquid Spring- 2017+ F550, 19,500 GWV Dump feature to be activated by the left rear entry door being opened.	1	1.7.8018

PART NO	S	DESCRIPTION	QTY	REF. NO
		The rear suspension shall only lower the module when the vehicle is in neutral or park and the parking brake is set.		
01-07-9000		RR, Rear Suspension Dump, Override Switch, (1), Momentary Dump feature to be activated by the left rear entry door. Override switch to be on right rear entry door Safety Triggers: (1) Dump switch to be 'on' position (2) Vehicle Must be in Park (3) Emergency Brake must be set (4) Module is to be in the 'On' position (5) Open Street side rear entry door (6) If Electric O2 lift, Door to that comp. must be closed.	1	1.7.21.1
		HIGH IDLE		
01-13-1535		RR, Intermotive Module controllers, F series, Diesel ,2023+	1	1.13.15.35
		FRONT END ALIGNMENT		
01-17-7501		Front End Alignment, None- QC Check -Standard	1	
		CAB EXTERIOR OPTIONS		
01-19-0002		RR, Road Rescue Stainless Grille Logo, with Diamond grade Blue reflective backin Blue Diamond grade Reflective behind cut out.	1	1.19.0002
		OUTSIDE REAR VIEW MIRRORS		
01-20-0100		RR, Mirrors, OEM Standard	1	
		RR-CAB INTERIOR OPTIONS		
01-21-3500		RR, Insulation, Cab, Thinsulate in Cab Ceiling (STANDARD)	1	1.21.35.0
		RR-SAFETY OPTIONS		
		RR-TIRES / WHEELS		
01-23-4100		RR, Spare Tire Bracket, Delete Spare tire will be shipped loose.	1	
		WHEEL COVERS		
01-24-2003		RR, Wheel Covers, Phoenix w/ Lug Nut covers, F-Series	1	1.24.20.3
		BASE CONVERSION		
01-45-0608		RR, Conversion, Ultramedic, Type 1, 170 Module, Ford -23-1	1	
		02 - MODULE REQUIREMENTS		
02-01-1008		RR, Ultramedic, 170"L x 96"W Type 1 Module Ultramedic I - 170"L x 96"W Type I Aisle width to be 46". The interior headroom shall be 72"	1	2.1.7003.0
02-01-2100		RR, Interior Headroom, 72"	1	
02-01-9622		RR, Aisle Space, 46" , Ultramedic I	1	
		MATERIALS		
02-02-0070		RR, Sub floor Materials,	1	
02-02-0120		RR, Type I & Type III, Interior Materials	1	
02-02-1000		RR, Type I & Type III, Materials	1	
		03 - MODULE EXTERIOR		
		UNDERCOATING		
03-02-0200		RR, Undercoating Module (STANDARD)	1	3.2.2.0
		EXTERIOR MODULE CONSTRUCTION		
03-03-0005		RR, Exterior Module Construction Specifications	1	
03-03-1400		RR, Module Roof Radius, 3" High (STANDARD)	1	
03-03-1500		RR, Extreme Bonding Tape (STANDARD)	1	
03-03-1600		RR, Sub-floor Gusset Supports (STANDARD)	1	
03-03-1700		RR, One Piece Side Body Panels (STANDARD)	1	
03-03-1800		RR, Reinforce Rear Header (STANDARD)	1	
03-03-1900		RR, Single Sheet Module Roof Sheet (STANDARD)	1	

PART NO	S	DESCRIPTION	QTY	REF. NO
DROP SKIRTS				
03-03-2010		RR, Drop Curbside Fwd Body Skirt, 5", Add Double Step, Light Duty Chassis Drop Curbside Forward Body Skirt, Add Double Step ahead of the Curbside Wheelwell - Drop curbside forward body skirt a total of 5 Inches lower than the rearward skirt and Incorporate a Double Step in the Side Entry Step well. (Ultramedic, Promedic only)	1	3.3.20.0
03-03-2110		RR, Drop Street side Fwd Body Skirt, 5", Light Duty Chassis	1	3.3.21.0
FUEL FILLS & SPLASH PLATE				
03-03-8005		RR, Housing Fuel Fill, Pocket, Square	1	3.3.80.5
DEF FILL HOUSING AND SPLASH PLATE				
03-03-8402		RR, DEF Fill, Housing, For Ford F series	1	3.3.84.1
SUB-FLOOR SYSTEM				
03-04-0140		RR, 1 Inch Composite Floor Pan	1	
03-04-0160		RR, Composite Floor Material	1	
03-04-1700		RR, Sub-Floor Assembly, Installation	1	
03-04-1800		RR, Sub-Floor Assembly, 1/8" PVC	1	
MODULE ENTRANCE				
03-05-0100		RR, Module Access, CS Door standard location	1	
03-06-0100		RR, Entry Doors, Hidden Hinge, Seal on Door ,W/Push Button Fail Safe Latching This includes the Fail Safe Latching mechanisms on all three entrance doors.	1	3.6.40.0
03-06-0700		RR, Hold Open Rear Door, Polished Cast Aluminum, Pin & Slot Style	1	3.6.7.0
03-06-0800		RR, Hold Open, Curb Side Entry Door, Heavy Duty Gas Spring Curbside Door Restraint - Heavy Duty gas spring hold opens. - Attached by 1/4" x 20 SS Machine Screws with 1/4" x 20 Nut Inserts into Corner Gusset in Door Side entrance door to open to 90+ degrees. (STANDARD)	1	3.6.8.0
03-06-1013		RR, Entry Door Handles, Trimark Logo Chrome/Black (Interiors Located top of door) ***** Relocate the Standard Interior Side and Rear Entrance Door Paddle Handles and Lock Boxes to the TOP of the doors. With Push button Emergency Release top and bottom of each door.	1	3.6.80.0
03-06-1700		RR, Door Lubrication, Paddle Handles and Latches (STANDARD) Lubricate all Door Hardware - All paddle handles, latches, rods and springs shall be lubricated prior to delivery.	1	
03-06-2201		RR , Magnetic Entry Door Switches (STANDARD)	1	3.6.22.0
03-06-2202		RR, Door Panel Mounting Screws (STANDARD)	1	
03-06-4200		RR, Coil Cords for Electrical Circuits (STANDARD)	1	
03-06-6065		RR, Power Door Locks, Module Entry Doors,w/Hidden Switch Install power door locks in side and rear entrance doors. Includes (2) lock/unlock switches, one at side door and one at rear door. Also includes (1) hidden switch in FRONT GRILLE for unlock function only. System will be tied to OEM chassis power locks, both systems to operate independently. Does not include wireless remote. hidden switch to be located in the front GRILLE on the passenger's side.	1	3.6.66.0
03-06-6107		RR, Bracket to Move Stealth Switch from Standard Location Relocate the Stealth switch to OEM grille area - curb side See CA Drawings.	1	3.6.61.7

PART NO	S	DESCRIPTION	QTY	REF. NO
03-06-8010		RR, Inner Door Panel - Stainless Steel , Two Piece (STANDARD)	1	3.6.15.0
03-06-8011		RR, Lock Boxes, White Diamond Grade	1	3.6.40.1
		SIDE DOOR STEP		
03-08-2000		RR, Dual Side Entry Step Well, Increased Depth, Lower Grip, Upper Diamond Plate Increase the depth of stepwell inboard as far as sub structure permits. Side surfaces to be Diamond Plate. Step surface to be a combination of NFPA Diamond Plate and removable 9" Grip Strut insert. The Diamond Plate section of the floor to be supported with rigid foam floor insulation in the same manner as the module floor. The lower step with grip strut will include a drain hole with plug. The second step to be fabricated of NFPA Diamond Plate and installed so that the step surface is midway between the stepwell floor surface and the module floor surface making two equal steps into the vehicle.	1	3.8.20.0
03-08-3010		RR, Light, Side Entry Step well, LED, Whelen OS Mini, Clear	1	3.8.5.0
		WINDOWS		
03-09-0030		RR, Module Window Requirements	1	
		WINDOW- Side Entry Door		
03-09-1110		RR, Window, Side Entry Door, 18X18, Slider - Standard Glass	1	3.9.11.1
		WINDOW - Rear Entry Doors		
03-09-1210		RR, Window, Rear Entry Doors, (2) 18 x 24, Fixed, Standard Glass	1	3.9.12.1
		MODULE TO CHASSIS MOUNTING SYSTEM		
03-10-1100		RR, Module to chassis mounting system, Type 1 Ford Long WB	1	3.10.5000
03-11-2000		RR, Bellows, Connecting, Type I	1	
		REAR BUMPER AND REAR STEP CONSTRUCTION		
03-12-1800		RR, Rear Bumper, Recessed 9" Pocket, Flip-up	1	3.12.18.0
03-12-3020		RR, Bumper Pods, CPI Cast Aluminum w/RR Logo. (UM & UM-150) Cast Products Bumper Pods, High Polish Finish. Mounted on the outboard rear step bumper frame members. The CPI cast aluminum pod shall include a RR Logo embossed in the cast pattern on the step tread.	1	3.12.30.0
03-12-5600		RR, Tow Eyes, Rear Chrome with 6" x 6"x 6" Deep Box Mounted to Steel Reinforcement Plate bolted to the OEM Chassis Frame Rails. Tow Eyes to be Recessed In Rear Kick Panel in cast aluminum box's that are 6" x 6" x 6" deep. (Ultramedic, Promedic Only)	1	3.12.56.0
		INSULATION		
03-13-2220		RR, Whisper Quiet, Sound Dampening/Thermal Insulation Package (UM) Whisper Quiet - Sound Dampening/Thermal Insulation Package. (ULTRAMEDIC AND PROMEDIC)	1	3.13.22.0
		ELECTROLYSIS PREVENTION		
03-14-4000		RR, Electrolysis Prevention, Fluid Film Fluid Film is used at Every Point Where the Mounting Process has the Propensity to Break Paint (STANDARD)	1	
		COMBINATION RUB RAIL AND FENDER RING		
03-15-2000		RR, Rub Rail, Skirt Line and Fender Ring Extruded Black Rubber Rub Rail and Fender Ring - The lower body Rub Rail and Fender Ring to made of Black extruded rubber. The aluminum extrusion that the rubber rub rail and fender rings sets into for added strength will stand off of the exterior body with nylon spacer for ease of cleaning between the rub rail and the exterior body. The rub rail and fender ring assembly will then be through bolted to the lower body. The lower body rub rails will transition to the fender ring and will have polished aluminum corner caps. At each end of the rub rails there will be a polish aluminum end caps. The rubber rub rail extrusion to accept multiple selections of reflective vinyl color inserts.	1	3.15.20.0

PART NO	S	DESCRIPTION	QTY	REF. NO
03-15-5110		RR, White Scotchlite Insert for Rubber Rail	1	3.15.51.1
SPLASH GUARDS AND RUNNING BOARDS				
03-16-1521		RR, Running Boards, Diamond Plate, Type I , Ford 2017+	1	3.16.15.21
03-16-1800		RR, Mud Flaps, Rear, Black w/ Road Rescue Logo	1	3.16.18.0
		Heavy Duty Rubber Mud Flaps w/ RR Logo - Heavy Duty Rubber Mud Flaps to be bolted to the wheel liner behind the rear duals with 1/4" x 20 Stainless Steel bolts, washer and nylon locknut for ease of maintenance and repair (STANDARD)		
DRIP RAILS				
03-17-1000		RR, Drip Rails Polished Aluminum Drip Rails - Above All Doors, Entry and Compartment (Standard)	1	
03-18-1000		RR, Wheel well liners Aluminum Wheelwell Liners - Extending to Bottom of Skirt (Standard)	1	
CAB TO MODULE ACCESS				
03-19-1100		RR, Pass Thru Window, Type 1 Ford,GM or Dodge Includes a Lexan sliding window in the module. The window shall have a positive latch on the cab side.	1	3.19.49.0
03-19-1113		RR, Pass Thru Opening, Type I	1	3.19.11.0
LICENSE PLATE HOLDER				
03-20-0550		RR, Rear License Holder Location, Center Recessed in Bumper Pocket	1	3.20.5.5
EXTERIOR COMPARTMENT CONSTRUCTION				
04-01-0100		RR, Exterior Compartment Construction, Heavy Duty	1	
04-01-3000		RR, Door Sill Protection, Stainless Steel. Door Sill Protection - Install Stainless Steel sill protector on lower edge of all door frames to prevent paint damage. (STANDARD)	1	
EXTERIOR COMPARTMENT DOORS				
04-02-0100		RR, Compartment Door, Hidden Hinge, Seal on Door (UM)	1	4.2.100
04-02-0715		RR, Compartment Handles, Exterior, TriMark Logo Chrome/Black (UM) TriMark Two-Point Cast w/Polished Chrome Paddle Handle and Housing, Locking and Non-Locking, with floating cam - Mounted in CNC Cut Opening in Each Compartment Door Skin w/OEM Clamp Assembly. (STANDARD ULTRAMEDIC)	1	
04-02-0741		RR, Compartment Handle, TriMark Logo Chrome/Black, Paddle, Street side, locking For single doors or Leading doors Compartments #1, #2, and #4.	3	4.2.7.41
04-02-0746		RR, Compartment Handle, TriMark Logo Chrome/Black, Paddle, Street side, Non-Lock For Trailing doors on the street side. Compartments #2 or #4.	1	4.2.7.46
04-02-0751		RR, Compartment Handle, TriMark Logo Chrome/Black, Paddle, Curbside, locking For single doors or Leading doors on the curbside Compartments #6, #6.5, #8	2	4.2.7.51
04-02-0758		RR, Compartment Handle, TriMark Logo Chrome/Black ,Drop Door or Drawer, Locking For Drop down doors or drawers on either side of unit. Compartments #3 & #8.5	2	4.2.7.58
04-02-0850		RR, Compartment Door Locks, 2015 TriMark Compartment Door Handle Manual Locks. - All doors shall incorporate	1	

PART NO	S	DESCRIPTION	QTY	REF. NO
		double cut, non-directional tumbler assemblies that are keyed alike (STANDARD)		
04-02-0900		RR, Compartment Rotary Latches	1	
04-02-1000		RR, Compartment Door Nader Pin	1	
04-02-1200		RR, Compartment Door Lubrication, Door Handles and Latches	1	
04-02-1300		RR, Compartment Door Reflectors	1	4.2.13.0
		All exterior compartment doors shall have a red reflector mechanically attached to the lower outboard corner of the door.		
04-02-1500		RR, Compartment Door Switches, Magnetic	1	4.2.15.0
04-02-2010		RR, Compartment Door Panel, Inner, Diamond Plate	1	4.2.20.1
04-02-2500		RR, Compartment Door, Panel Mounting Screws	1	
04-02-5999		RR, Power Door Locks, Exterior Compartments	1	
04-02-6010		RR, Exterior Compartment #'s 1, 2, 4, 6 & 8, Only	1	4.2.61.0
04-02-6040		RR, Add Power Door Lock to #3 Comp.	1	4.2.64.0
04-02-6050		RR, Add Power Door Lock to #6.5 Comp.	1	4.2.65.0
04-02-7801		RR, Compartment Door, Gas Struts	1	
04-03-2300		RR, Compartment Lights, Exterior, Additional Flexible LED Strip (Per Comp)	1	4.3.23.1
		Additionally #3		
04-03-2400		RR, All Standard Compartment Lights, LED, Flexible Strip	1	4.3.24.0
		Two (2) Vertical strips in each exterior compartment installed, one (1) on each side of the opening. The compartment #1 lights will be also wired to Oxygen light switch in action area.		
		EXTERIOR COMPARTMENT INTERIOR		
04-04-1000		RR, Exterior Compartment, Interior Finish, Polyurethane Coated	1	
		Exterior Compartment Interior Polyurethane Rubberized Liner Color Choice.		
		Rubberized polyurethane coating applied to the surfaces of ALL exterior compartment walls and dividers. Does not include slide out battery tray or mounting angles. Battery Tray to be raw aluminum.		
		NOTE: If there is not a slide out battery compartment in the order the #3.5 exterior compartment area will be Polyurethane lined.		
04-04-1002		RR, Color, Light Gray	1	4.4.10.2
04-04-2000		RR, Exterior Compartment, Floor Matting "Turtle Tile"	1	4.4.20.0
		Compartments		
		#1		
		#2		
		#3		
		#4		
		#6		
		#6.5		
		#8		
04-04-2001		RR, Color, Black	1	4.4.20.1
		EXTERIOR COMPARTMENT SHELVING		
04-05-0001		RR, Exterior Compartment Shelving and Unistrut	1	
		All exterior shelving Unistrut shall be welded to the walls prior to any compartment wall finish. Where specified, exterior adjustable shelves shall be box pan formed of a minimum .125 inch Aluminum Diamond Plate and corners shall be welded. Shelves shall be infinitely adjustable, and securely mounted to heavy gauge aluminum Unistrut track. (Standard)		
04-05-1000		RR, Compartment Shelving, Diamond Plate	1	
		Diamond Plate Exterior Compartment Shelving. (STANDARD)		

PART NO	S	DESCRIPTION	QTY	REF. NO
COMPARTMENT #1 - STREETSIDE FWD				
04-06-0001		RR, Compartment #1, EXTERIOR	1	
04-06-0010		RR, Compartment #1, Electrical Storage #1 Compartment Electrical Storage - Recessed into the bulkhead side of compartment #1 shall be an enclosed area for the installation of miscellaneous electrical components. The aluminum cover for this area to be installed with 'J' molding The 'J' molding to be full length of panel on bottom and inboard side. Outboard side of panel to be secured with mechanical fasteners. (STANDARD)	1	4.6.11.0
04-06-0020		RR, Compartment #1, Full Height, Standard Configuration (UM)	1	4.6.12.0
04-06-1505		RR, Compartment #1, Shelf, Fixed L Shelf located above O2. See CA Drawings.	1	4.6.155.0
COMPARTMENT #2 - STREETSIDE FWD WHEELWELL				
04-07-0010		RR, Compartment #2, EXTERIOR	1	
04-07-0600		RR, Compartment #2, Standard Configuration, (UM) #2 Compartment to be directly behind the #1 compartment and below the interior action area shelf on the street side of the module. (STANDARD Ultramedic)	1	4.7.6.0
04-07-2610		RR, Compartment #2, Shelf Adjustable, First Shelf Standard (Ultramedic).	1	4.7.261.1
COMPARTMENT #3 - STREETSIDE WHEELWELL				
04-08-1000		RR, Compartment #3, EXTERIOR	1	
04-08-3320		RR, Compartment #3, Drawer, 8.5"H x AWAP, Raise CPR Seat #3 Compartment shall be directly over the wheel well on the street side of the module. The compartment door shall be attached to a slide out tray mounted with two slides.	1	4.8.332.0
COMPARTMENT #4 - STREETSIDE AFT				
04-09-0001		RR, Compartment #4, EXTERIOR	1	
04-09-3000		RR, Compartment #4, 3/4 Height, Standard Configuration Full Height #4 Compartment streetside rear of module with Interior Upper left #4 Cabinet - #4 Compartment to be full height to bottom of upper left #4 cabinet.	1	4.9.30.0
04-09-4505		RR, Compartment #4, Shelf Adjustable, First Shelf Approximately evenly spaced in the compartment with the other shelf. See CA Drawings.	1	4.9.451.1
04-09-4520		RR, Compartment #4, Shelf Adjustable, Additional, Each Approximately evenly spaced in the compartment with the other shelf. See CA Drawings.	1	4.9.452.0
COMPARTMENT #6 - CURBSIDE AFT				
04-11-0084		RR, Compartment #6, EXTERIOR	1	
04-11-0600		RR, Compartment #6, Standard Configuration (UM)	1	4.11.6.0
04-11-2060		RR, Compartment #6, Divider, Fixed (UM) Installed centered in the compartment.	1	4.11.456.0
04-11-4510		RR, Compartment #6, Shelf Adjustable, First shelf (1) Located from the divider to wall #3 at the bottom of the INT/EXT access.	1	4.11.451.0

PART NO	S	DESCRIPTION	QTY	REF. NO
		See CA Drawings.		
04-11-4520		RR, Compartment #6, Shelf Adjustable, Additional, Each (2) Approximately equally spaced from the bottom shelf to the top of the compartment from the divider to wall #3 in the INT/EXT access. See CA Drawings.	2	4.11.452.0
04-11-4625		RR, Compartment #6, Safety Bar across for Backboards 68" from floor height, Wall #1 to fixed divider polyurethane coated to match compartment.	1	4.11.4625
04-11-4631		RR, Compartment #6, Equipment Strap, Quick Release, Plastic Buckle, Each (1) equipment restraint strap with Plastic quick release buckle Location: Installed approximately mid height from wall #1 to the divider. See CA Drawings.	1	4.11.463.0
04-14-1425		RR, Compartment #8, EXTERIOR RR, Compartment #8, Reduced Height Door Exterior compartment #8 shall be the forward most compartment on the curbside of the module allowing interior / exterior access to the interior ALS cabinet. This compartment shall be per the size and configuration shown in the CA Drawings.	1	4.14.15.0
04-15-0400		RR, Compartment #8.5, EXTERIOR RR, Compartment #8.5, Drawer Style Battery Box Configuration Battery access door mounted slide out battery tray. The interior of the battery compartment to be made of POLYURETHANE COATED ALUMINUM. Battery Tray to be raw aluminum.	1	4.15.4.0
		INTERIOR TRIM AND FEATURES New Interior Trim - All cabinet and wall panel aluminum trim to be Gray anodized. (No Black trim to be used). All protective corner trim will be Opaque and will include a matching domed end cap. (STANDARD)		
		INTERIOR ADJUSTABLE SHELVES		
		INTERIOR TRIM		
05-05-1000		RR, Interior Trim, Standard	1	
		HEADLINER		
05-06-1100		RR-Ceiling Medical Device Rail (UM & UM-150)	1	5.6.11.0
05-06-1210		RR, Headliner, Vinyl Ceiling, No Seams (UM & UM-150)	1	5.6.12.0
05-06-1802		RR, Ceiling Medical Device Rail. White LED Strip Lights,(UM & UM-150)	1	5.6.18.0
05-06-1902		RR, Ceiling Medical Device Rail, Red/Amber LED Turn/Brake Strip Lights (UM & UM-	1	5.6.19.0
		FLOORING		
05-07-1000		RR, Flooring, Aluminum Floor/Wall Cove Molding (STANDARD)	1	5.7.5.0
05-07-1400		RR, Flooring, Stainless Steel Rear Threshold, 45 Degree Chamfered (STANDARD)	1	5.7.14.0
05-07-3000		RR, Flooring - Lonplate II Choice	1	
05-07-3002		RR, Color - 421 Mica	1	5.7.30.2
05-07-9895		RR, Floor, Curbside Stainless Steel Threshold, 4"wide,Safety Walk Anti-Skid Tap	1	5.7.61.0
		HEAD BUMPERS		
		BACKRESTS		
		Rear Entry Door Grab Handles		
05-10-1301		RR, Rear Entry Door Grab Handles, "L" Bars, 16" Anti-Microbial "L" Bars - 16" Anti-Microbial. 1.25" Diameter stainless steel "L" Bars	1	5.10.13.1

PART NO	S	DESCRIPTION	QTY	REF. NO
		mounted to each rear door. Approximately 16" wide by 26" high. Clear Anti-Microbial finish.		
		Side Entry Door Grab Handle		
05-10-1401		RR, Side Entry Door Grab Handle, "L" Bar - 19" Anti-Microbial "L" Bar - 19" Anti-Microbial. 1.25" Diameter stainless steel "L" Bars mounted to side entry door. Approximately 19" wide by 24" high. Clear Anti-Microbial finish.	1	5.10.14.1
		Ceiling Grab Rail - Center		
05-10-1903		RR, Ceiling Grab Rail, Center 108" Anti-Microbial	1	5.10.19.3
05-10-2201	S	RR, Ceiling Grab Rail, Curbside over CPR Seat 72" Anti-Microbial	1	5.10.22.1
05-10-2217		RR, Grab Rail, Vinyl Padding, Overhead, Over Cot	2	5.10.85.0
		IV FLUID HANGERS		
05-11-4000		RR, IV Hangers, CPI #IV2008 (STANDARD)	1	
05-11-4002		RR, IV Hangers, Quantity (2) <i>See CA Drawings.</i>	1	5.11.40.2
		LEFT STACK AND BULKHEAD AREA #1		
05-12-0010		RR, Interior Street side #1 - Left Stack and Bulkhead	1	
05-12-0200		RR, Upper Bulkhead Cabinet, Double Doors <i>Upper Bulkhead Electrical Cabinet, Double Doors</i> <i>- Install double hinged Kydex Thermoplastic or multi-spec (picked in the proper section of work order) doors with locking latch on the right hand door and center mullion on the left hand door on the standard upper bulkhead electrical cabinet.</i> <i>(STANDARD)</i>	1	5.12.20.0
05-12-02SR	U	Left Stack Venting <i>SR#2023361F</i> <i>(2) Fans on the left stack located per mechanical engineering design. The 12V fans to the left stack radio/inverter cabinet to help move heat generated by inverters and chargers. The fan on the door shall operate as intake and the other fan shall be exhaust. Cover the fans with louvers.</i> <i>Fans shall be wired ignition and shoreline hot.</i>	2	10156335
05-12-1610		RR, Left Stack, Storage Area #1, 45 Deg Angled, CN 10 Certified <i>A two section vertical cabinet shall be provided behind the attendant seat on the street side forward corner on a 45 degree bevel that includes the access doors to the cabinet. The lower cabinet door shall be aluminum with plastic laminate and the upper cabinet shall be a Single One Hand Operation hinged Polycarbonate door.</i>	1	5.12.1610
05-12-1640		RR, Bulkhead Cabinet, Lower (2) Rear Facing Doors The patient compartment shall include a lower bulkhead cabinet located between the existing vertical left storage/radio cabinet and the ALS cabinet. The cabinet shall include (2) hinged aluminum and Kydex Thermoplastic or multi-spec doors with locking latch, (1) adjustable shelf, and a solid surface countertop with retaining lip.	1	5.12.164.0
05-12-1810		RR, Shelf Adjustable, Left Stack, First Shelf <i>For C1.</i>	1	5.12.181.0
		ACTION WALL AREA #2		
05-13-0010		RR - INTERIOR STREETSIDE #2 - ACTION AREA	1	
05-13-0700		RR, Action Wall Area #2, Medical Device Rail	1	5.13.7.0
05-13-0802		RR, Cabinets, Upper Left U2 and U2.5, Std Configuration (UM), CN 10 Certified <i>- (2) Cabinets over Action Area with sliding doors and restocking feature.</i>	1	5.13.0802

PART NO	S	DESCRIPTION	QTY	REF. NO
		The forward UL #2 and the rearward UL #2.5 cabinets to include (1) adjustable shelf in each cabinet. The attendant switch panel and environmental controls to be built into a separate 6" high section below the Upper Left #2.5 cabinet and tilted slightly down for ease of accessibility to the attendant.. (STANDARD Ultramedic, Promedic)		
05-13-2200	S	RR Countertop, Forward & Rear action area, bulkhead counter, c/s work station	1	
05-13-2217		RR, Avonite New Concrete, 7842	1	5.13.22.17
RR-Interior Street side #3 - CPR Seat				
05-14-05SR	U	Streetside - CPR Seat, Fixed Lid Configuration SR#2023361F	1	10480094
		- The CPR seat shall include a fixed seat. The CPR seat shall include a 2" foam seat and backrest, the upper and lower sections will be padded on both sides for added protection.		
		NOTE: The CPR seat will have a fixed lid.		
05-14-2560		RR, CPR Seat, Seat Belt, 4 Point (Per4Max) Black, Change Notice 8-Compliant Above Lid mounted	1	5.14.102.31
05-14-4106		RR, CPR Seat, RR Backrest and Head Cushion, RR Logo, (1) Set, Royal Blue	1	5.14.28.6
RR, INTERIOR STREETSIDE #4 - REAR AREA				
05-15-1001		RR, Cabinet, Upper Left U4, Standard Configuration- CN 10 Certified Upper left U4 cabinet with sliding poly carbonate doors with spring loaded latching handles, restocking feature with spring loaded exterior integral latch and (1) adjustable shelf.	1	5.15.1020
SQUAD BENCH AREA				
05-16-0010		RR, INTERIOR CABINETS - SQUAD BENCH AREA	1	
05-16-00SR	U	Curbside Squad Bench - Two Piece Lid - (1) Hinged & (1) Fixed SR#2023361F	1	10363163
		The rear squad bench lid will be fixed and the forward lid will be hinged.		
		See CA drawings.		
05-16-0146		RR, Squad Bench, Curbside, One Piece Hinged Lid	1	5.16.50.1
05-16-0151		RR, Squad Bench, Medical Device Rail	1	
05-16-0153		RR, Squad Bench, Latch, Lid, Tri Mark,	1	5.16.60.2
05-16-0158		RR, Squad Bench, Seat Belts, Two 4-Point belts (Per4Max) Black, CN-8 Above the Lid Mounted	1	5.16.102.51
05-16-0176		RR, Squad Bench, RR Backrest and Head Cushion, RR Logo, (1) Set, royal Blue	2	5.14.28.6
05-16-01SR	U	Custom Cabinet - Head of Squad Bench SR#2023361F	1	10551175
		Custom cabinet at head end of Squad Bench area with one drawer, opening towards the bench - Notched out under the drawer for access to the waste & sharps drawer (drawer picked separately in the order). This cabinet will have an avonite counter top, with no retaining lip.		
		Drawer shall be 10" deep, and shall use 10" non locking slides. Face of the drawer to be finished with multispec or kydex (picked in the proper section of the order). Drawer shall use (1) round locking latch.		

PART NO	S	DESCRIPTION	QTY	REF. NO
05-16-8400		RR, Upper Squad Bench, Cabinet, 9"H, 72" Headroom ONLY There shall be a cabinet located above the squad bench. The cabinet will be approximately 9"H x 8-1/2"D and will be the same length as the squad bench. The cabinet shall be divided into two (2) separate sections by a fixed center divider. Each section will have 3/8" Lexan lift up doors with restocking feature and locking latches. Does not include shelves. The distance between the top of the squad bench cushion to the bottom of the cabinet cushion shall be a minimum of 43" in compliance with KKK-A-1822F requirements for head clearance.	1	5.16.84.0
05-16-9915		KKK Compliancy Regarding Overhead Cabinetry The inclusion of a cabinet over the squad bench or CPR seat on a unit with less than 72" headroom will result in the unit not meeting KKK specification requirements. The end user has been informed of the KKK requirements and this cabinet has been added at the request of, and according to the specifications of, the end user.	1	CABINETRY
		BIOHAZARD- RR, INTERIOR - BIOHAZARD		
05-17-2000		RR, Glove Butler(s)	1	
05-17-2100		RR, Glove Butler (3) Total, Over Curbside Entry, Drop down Door (3) Glove Butler II glove boxes installed above the side module entrance door inside a cabinet with drop down door and (2) locking latches. Door to be Kydex Thermoplastic or multi-spec covered and bottom hinged to tip out for restocking. Access holes to be cut in door for glove removal.	1	5.17.210.0
05-17-32SR	U	RR, Access, Waste & Sharps, Through Top, Head of Squad Bench SR#2023361F Combination Waste and Sharps storage area at head of squad bench. Waste and Sharps to be removable through a lift up lid. Lid to have a locking latch. Includes 8 quart waste container and 1.7 8 quart top loading sharps container. Sharps / Waste access setup in a drawer with 14" non locking slides, round southco locking latch, finish the face of the drawer with kydex thermoplastic or multispec (picked in the proper section of the order).	1	10321568
		CURBSIDE RIGHT STACK STORAGE #8		
05-18-0010		RR, INTERIOR CURBSIDE - RIGHT STACK STORAGE #8	1	
05-18-0600		RR, RF ALS, Upper Heater, A/C Unit, Standard Configuration (UM & UM-150)	1	
05-18-0810		RR, RF ALS, Stainless Steel Vents for Air Intake	1	
05-18-1010		RR, RF ALS, "A" Style Standard, CN 10 Certified (UM & UM-150)	1	5.18.1010
05-18-51SR	U	RR, U8, Drug Cabinet, 16" Dual Aluminum Doors, Interior Access SR#2023361F CABINET U8 - Below the top section area shall be a cabinet with a Kydex Thermoplastic or multi-spec covered, locking aluminum double doors that is hinged vertically the LH/RH. The height of the cabinet below the heat A/C shall be 16 in. high and will have (1) adjustable shelf. The RH door shall have (1) round locking latch, and the LH door shall have a center mullion. See CA Drawings.	1	
05-18-5326	S	RR, L8, Cabinet, ALS Gen II, OHO Polycarbonate Doors,(2) Adj Shelves, I/O CN10 CABINET L8 - The lower section of the right front ALS cabinet shall have interior and exterior access and shall contain (2) adjustable shelves. The double interior access doors shall be Gen II OHO polycarbonate double doors. The interior walls of this area to be lined with flooring material and	1	

PART NO	S	DESCRIPTION	QTY	REF. NO
		the floor of this section shall incorporate an angled stainless steel threshold designed to facilitate removal of equipment from the floor of the cabinet without catching on the lower frame edge.		
		ATTENDANT SEAT		
05-19-0500		RR, Attendant's Seat, EVS 1880, Child safety, Comfort, Per4Max Belt-Black	1	
05-19-0506		RR, Color - Royal Blue	1	5.19.5.6
05-19-6501		RR, Attendant's Seat Base, EVS Swivel 2 Pos	1	5.19.65.1
		RR-INTERIOR COLORS		
05-20-2000		RR, Multi-Spec Interior Surfaces	1	5.20.2000
05-20-2003		RR, Color, Arctic Blue #99-604	1	5.4.12.3
05-20-5300		RR, Upper Band Vinyl Color, Cabinets and Stitched Cushions Upper Band Vinyl Color Choice for cabinets and stitched cushions.	1	
05-20-5336		RR, Color, Royal Blue	1	5.20.53.36
05-20-5500		RR, Lower Band Vinyl Color, Vacuum Formed Cushions	1	
05-20-5536		RR, Color, Royal Blue	1	5.20.55.36
05-20-9850		RR, Poly carbonate Color Choice	1	
05-20-9851		RR, Poly carbonate, Gray 1/4" poly carbonate	1	5.20.9851
		RR-MISC. INTERIOR OPTIONS		
05-21-2520		RR, Security Lock (1) RCI Electric Lock w/ Remote Keypad ,For Hinged Door Locking top section of ALS Cabinet Keypad located near the U8 cabinet as shown on the CA Drawings.	1	5.21.252.0
05-21-5002		RR, Squad Bench & Lower Left, 11 Inch Brushed Stainless Kick panels There shall be a stainless steel kick panel on the face of the streetside lower left wall and curbside squad bench. The kick panel shall be approximately 11 inches high and shall run the full length of the squad bench and lower left wall.	1	5.21.51.0
05-21-7050		RR, Interior Access, #6 Compartment, w/ Hinged Poly carbonate Door, CN 10 Certif The patient compartment shall include a inside/outside access to the #6 compartment. The access opening will include an Gen II OHO Polycarbonate door with an integral latch. The access will be installed at the forward portion of the #6 compartment, and facing the aisle. The door will extend from the highest possible/practical point of the compartment down to the level of the squad bench lids and will be full width from compartment wall to divider. Exterior shelf retaining lip to be aligned with door opening.	1	5.21.7050
05-21-8500		RR, Cabinet Latch, Southco 2" Round, Stainless Locking, CN 10-Rated 10lb	17	5.21.85.0
06-01-0100		RR, General Wiring, General Harness	1	
		CAMERAS		
06-06-1016		RR, Camera - WHT Ext B/U, ZORG over Rear Doors for Ford F-series Install one (1)Zorg white IR color camera. Exterior mounted and connected to vehicle's OEM display.	1	6.6.1016
		RR-COMMUNICATION		
06-06-1601		RR, Two Way Radio Routing Path Cab to Module (STANDARD)	1	
06-06-1700		RR, Two Way Radio Pre wire, 12VDC Power & Ground (STANDARD) #8 gauge Red power and Black ground wiring will be labeled appropriately for future installation by a radio technician. The Black ground wire to be connected to a main ground point, the Red power wire to be left unconnected near a direct to battery connection point inside the power distribution cabinet. Both wires to route to the lower section of the Left	1	6.6.17.0

PART NO	S	DESCRIPTION	QTY	REF. NO
		Stack/Radio Cabinet and be of sufficient length to allow routing to the Cab Console as an alternate radio installation location. Wires to be labeled at both ends.		
06-06-3002		RR, Antenna UHF/VHF, (2) Bases and Cables #1 Antenna base location: Port 1 Coax termination: L1 Cabinet #2 Antenna base location: Port 2 Coax termination: L1 Cabinet	1	6.6.30.2
06-06-6000		RR, Radio Power, (1) 8 Gauge 12VDC Power/Ground The vehicle shall be equipped with (1) additional #8 gauge power and ground wire pair. The Black ground wire to be connected to a main ground point, the Red power wire to be left unconnected near a direct to battery connection point inside the power distribution cabinet. Both wires to route to the Cab Console. Wires to be labeled at both ends	1	6.6.60.0
		RADIO AND CLOCKS		
06-07-6500		RR, Clock, Digital Lacrosse Atomic, 12/24 Hour, Over Rear Doors	1	6.7.65.0
		07 - ELECTRICAL 12 VOLT DC		
07-00-0121		RR, Electrical System 12V, PC System, Type 1	1	
07-01-0010		RR, Crct Pwr Accs.,Ign/Shrline,1-20 amp 12VDC to 2 locs,W/O,PD9130 chrgr (1) 10 amp lead shall be coiled up behind the A./A panel for future use. (1) 10 amp lead shall be coiled up behind the drivers seat in the cab, for future use. Note: This code will be used when and additional battery charger has already been installed, the PD9130 will not be used with this option.	1	7.01.0010
07-02-1000		RR, Voltmeter - Standard	1	
07-02-1100		RR, Alarm,Low Voltage,With Buzzer and Indicator,in cab console	1	
07-03-1000		RR, Ammeter - for PC System	1	
		BATTERY SYSTEM		
07-04-5305		RR, Ignition Battery Shut off Timer, 5 minute,	1	7.4.53.5
07-05-0400		RR, Batteries, Type I UM/UM-150, Ford or Dodge Ram (2) OEM (1) Additional The two OEM batteries under the hood. One 700 CCA AC Delco additional battery shall be supplied by the manufacturer and located in the exterior compartment located below the right front ALS cabinet.	1	7.5.4.0
07-07-0400		RR, Module Disconnect, PC System	1	
07-08-0100		RR-Battery Ground	1	
07-09-6100		RR, Battery Charger Included with Inverter - See Inverter Picked.	1	
07-10-1000		RR, Power Outlets 12V, (2) Power Point Style, On with Ignition (1) outlet shall be mounted in the action area medical rail. (1) outlet shall be mounted above the top shelf in cabinet L8	1	7.10.10.0
07-10-5301		RR, (1) Additional 12V Outlet, Direct to Battery (1) Driver's Console driver's side forward next to siren.	1	7.10.53.1
07-10-7230		RR, Power Outlet, Kusmaul, USB Dual Port, 5VDC, 4.8 Amp, 091-219-5 Located in the cab switch panel per Electrical Engineering ignition hot standard	1	7.10.7230

PART NO	S	DESCRIPTION	QTY	REF. NO
		FRONT CONSOLE		
08-01-1601		RR, Console, Drivers Switch & Radio, PC System, CN11 Console shall be finished with black polyurethane coating. Engineering notice - Console has Havis C-ARM-102 (picked separately in the order). Console must be reduced in width to accommodate arm rests	1	8.1.16.0
08-01-4200		RR, Cup Holder, (2) Position Aluminum in the Cab, (Cups No Handles) Black plastic cup holders to be forward of the map box storage.	1	8.1.42.0
08-01-6050		RR, Armrest, (1) Side mount, Havis C-ARM-102 Installed on each side of the cab console.	2	8.1.6050
08-01-6210		RR, Clipboard/Map box, (3) Dividers Rear of the cup holders shall be a clipboard and map box storage with binning strips and lexan adjustable dividers.	1	8.5.51.0
08-02-0500		RR, Driver's Control Panel, Carbon Fiber Graphics w/Visual Display, Carling Rock Includes Carling rocker switches	1	
08-02-5510		RR, Door Open Indicators (PC Electrical System) Door Open Indicators - Magnetic Proximity Switches located at the top of the compartment door / jamb will activate a door open indicator on the driver's control panel and activate the corresponding Interior compartment light. (STANDARD).	1	
08-02-9100		RR, Map Light, Federal LED "Littlite" Gooseneck Light, 12", Fixed Mounted Mounted to the right side of the switch console there shall be a 12 inch Little Lite high intensity gooseneck light. It shall have switchable red and white LEDs and shall include a switch in the lamp base.	1	8.2.91.1
		ATTENDANT CONTROL PANEL		
08-03-0500		RR, Attendant's Control Panel, Carbon Fiber Graphics, Carling Includes Carling rocker switches	1	
08-04-3904		RR, Power Distribution, PC Board Electrical System 2015+ (UM & UM-150)	1	8.4.39.4
		09 - EMERGENCY Systems- Sirens, Speakers and Air Horns		
09-03-0020		RR, Warning Audible - Siren, Speakers, Air Horns- F-Series SIREN ELECTRONIC - CONTROL HEADS / AMPS	1	
09-03-1150		RR, Siren Electronic, Whelen 295HFSA7, Remote Head, California Compliant	1	9.3.35.0
		SIREN SPEAKERS		
09-03-2023		RR, Speakers, (2) CPI "Though-The-Bumper" for 2023-F-Series w/Fog Lts.	1	9.3.3.23
		AIR HORNS		
09-03-3090		RR, Air Horns, Buell, 10" & 12", Thru Bumper, Tank & Comp, F-Series NO Air horns thru center of Front bumper type 1 FORDS per ECN1820 Compressor on compt #2 ceiling in the upper left hand corner of the compartment- With expanded metal cover	1	9.3.110.4
09-03-6010		RR, Air Horns, Control Switch, Momentary Switch ILO std foot switch	1	9.3.140.0
09-05-0210		RR, Backup Alarm, No Cutoff	1	9.5.2.1
09-06-0200		RR, Emergency Sequencer/Load Manager	1	
		FRONT WARNING LIGHT CONFIGURATION		
09-50-1333		RR, Visual Warning Front Upper - (5) "Cool Bar" (2) Front Wall Configuration	1	

PART NO	S	DESCRIPTION	QTY	REF. NO
09-70-5310		<p style="text-align: center;">AUXILLARY EMERGENCY LIGHTS</p> <p>RR, Lights, Rear Chevron, Angled, LED Strip Lights in extruded channel, Per CAs #KFA-RR-CRA-1. Includes Chevron flasher set, KFA-CIO-01 Punch slots in the rear body panel to accommodate. LED colors will be combination Red/Amber.</p> <p>This feature is similar to the flashing rub rail lights. Requires special flasher with two separate left and right modules.</p> <p>The Top, middle, and Lower angled lights are to be solid RED LED's only when the OEM brakes are applied. This will override the emergency light function. This feature also applies when not in emergency mode.</p> <p>The (2) angled light above and below the center angled light are to be flash AMBER LED's only when the corresponding OEM turn signals are applied. This will override the emergency light function. This feature also applies when not in emergency mode.</p> <p>Red and Amber LED's are to be wired to master emergency lights and alternate Red then Amber.</p> <p>Chevron strip lights to be centered in reflective chevron stripes (if ordered).</p>	1	9.70.53.10
09-80-2110		<p>RR, Warning Light Flasher, Vanner 9860GCPE, PC System Only Vanner 9860GCPE Halogen/LED electronic flasher to power specified lights. Four flash Patterns avail.(Alternate flash, Triple burst, Quad burst, double burst.)</p> <p>Standard will be dual Burst Flash unless otherwise noted.</p>	1	9.80.19.0
09-95-1504		<p style="text-align: center;">WARNING LIGHTS LED Series - M9 (Flange Included)</p> <p>RR, Whelen M9 LED, w/Chrome Flange LED - WHITE (Internal Flasher)</p> <p>FRONT UPPER BODY LIGHTING Front Body - Upper Curbside Outer Front Body - Upper Center Front Body - Upper Street side Outer</p> <p>Internally flashed -Comet flash 75- Pri Only</p>	3	9.95.1504
09-95-1505		<p>RR, Whelen M9 LED, w/Chrome Flange - RED / Clear Lens (Internal Flasher)</p> <p>Front Body - Upper Curbside Inner Front Body - Upper Streetside Inner</p> <p>Internally flashed -Comet flash 75- Pri/Sec</p> <p>Front Body - Upper Curbside Corner Front Body - Upper Streetside Corner Streetside Body - Upper Forward Streetside Body - Upper Rear Curbside Body - Upper Forward Curbside Body - Upper Rear</p> <p>Internally flashed -Comet flash 75- Pri/Sec</p> <p>Rear Body - Upper Streetside Corner Rear Body - Upper Curbside Set to steady burn for brake override - flash thru 9860 Flasher- Pri/sec</p>	10	9.95.1505

PART NO	S	DESCRIPTION	QTY	REF. NO
09-95-2405		<p>LED Series - M7 (Flange included RR) RR, Light, Whelen M7 LED, w/Chrome Flange, Red, Clear Lens (Internal Flasher) FRONT FENDER INTERSECTION LIGHTING Front Fender Warning - Intersectors - LH Side Front Fender Warning - Intersectors - RH Side</p> <p>Internally flashed -Comet flash 75- Pri only</p> <p>REAR WHEEL WELL INTERSECTION LIGHTING Rear wheel well Warning - Intersectors - LH Side Rear wheel well Warning - Intersectors - RH Side</p> <p>Internally flashed -Comet flash 75- Pri/Sec</p>	4	9.95.2405
09-95-2407		<p>RR, Light, Whelen M7 LED, w/Chrome Flange, Amber, Clear Lens (Internal Flasher) MODULE REAR LIGHTING Rear Body - Upper Center</p> <p>Internally flashed -Comet flash 75- Pri/Sec</p>	1	9.95.2407
09-95-4712		<p>WHELEN ION WARNING LIGHTS (Flange Included) RR, Light, Whelen, ION, WIONSMCR, Red, Clear lens, w/chrome flange FRONT GRILLE LIGHTING Grille - LH Upper Corner Grille - RH Lower Corner</p> <p>Internally flashed -Comet flash 75 Phase 1 CS/ Phase 2 Streetside- Pri only</p> <p>See CA Drawings.</p>	2	9.95.4712
09-95-4716		<p>RR, Light, Whelen, ION, WIONSMCC, Clear, W/chrome flange FRONT GRILLE LIGHTING Grille - LH Lower Corner Grille - RH Upper Corner</p> <p>Internally flashed -Comet flash 75 Phase 1 Streetside/ Phase 2 CS- Pri only</p> <p>See CA Drawings.</p>	2	9.95.4716
09-95-9237		<p>Whelen 700 Light head Flanges / Options RR, Housings, Cast, 15 degree angled, M7, Intersection, 2017+ F-series, Pair</p>	1	9.95.9236.17
10-01-0002		<p>EXTERIOR AUTOMOTIVE LIGHTING RR, Tail Lights, Brake/Turn, Whelen M62-Series LED, Pair</p>	1	10.1.32.2
10-01-0007		<p>RR, Back-up Lights, Whelen M62BU, LED Rear, Pair</p>	1	10.1.66.2
10-01-2010		<p>ICC/MARKER LIGHTS RR, Marker/Clearance Lights, Front, Whelen OS Mini LED, Amber</p>	1	9.4.9.1
10-01-2110		<p>RR, Marker/Clearance Lights, Side and Rear, Whelen OS Mini LED, Red/Amber</p>	1	10.1.23.0
10-01-3002		<p>RR, Chrome Flange, (1) Whelen M6</p>	6	10.1.42.0
10-01-5020		<p>RR, Outboard Rear Flashers, Wired to OEM Brake Lights The outboard rear emergency flashers shall be wired to the OEM brake lights. These lights shall NOT function as brake lights when Emergency Flashers are on.</p>	1	
10-01-7300		<p>RR, Front Turn, Whelen M6-Series LED Amber Arrow w/Flange</p>	1	10.1.73.0

PART NO	S	DESCRIPTION	QTY	REF. NO
10-01-8010		RR, Relocate Brake/Tail & Backup Lights to rear Diamond Plate, Amber Turns above	1	10.1.60.0
FLOOD AND LOAD SYSTEMS				
10-02-1020		RR, Scene Lighting, (4) Whelen M9 Series Super LED	1	10.2.45.0
10-02-2040		RR, Rear Load Lights, (2) Whelen M7 Series Super LED, Gradient Scene Light	1	10.2.52.0
10-02-3010		RR, Lighting Operation, Side Scene, Rear Load & Back-Up Lights The electrical system shall be wired so that the rear module load lights and the lower back-up lights will operate when the rear doors are open, the switch on the front panel is activated, or when the vehicle is placed in reverse. With the module power switch "off", both the lower back-up lights and the upper load lights will operate when the vehicle is placed in reverse. The curbside scene lights will operate when the curbside door is opened.	1	
Cab Entry - Lighting				
11 - INTERIOR LIGHTING				
11-01-1400		RR, Dome Lights - (11) Kinequip 8" Round LED The interior lighting system shall consist of (11) Kinequip 8" Round LED Dome Lights fixtures in the following configuration: (3) Cot lights In the medical device rail over the primary cot (2) Bench lights over the squad bench (3) Dome lights Street side (1) Dome light Curbside over head of squad bench (1) Dome light Curbside rear (1) Dome Light over the walkway The four outside corner lights and the (1) light over the CPR seat area and the (1) over the walkway shall be designated module dome lights and be activated when the side or rear module entrance doors are opened or by a three-way circuit allowing these lights to be turned on and off from cab or module. The lights over the primary cot and squad bench shall have switches in the module that will allow independent high/low/off control.	1	11.1.40.0
11-01-9000		RR, Timer -15 minute- Restocking The vehicle shall be equipped with a momentary switch that will activate a fifteen minute timer, wired direct to battery, to allow operation of the module dome lights while the vehicle is off. The momentary switch shall be located on the curbside wall near the side entrance door in the medical device rail.	1	
SPOTLIGHTS / HANDHELD LIGHTS				
ATTENDANT LIGHT				
11-03-1500		RR, Attendant Light - LED Strip Under UL2-2.5 Cabinets, Action Wall	1	11.3.8.1
SHORELINE INLET				
12-01-5400		RR, Shoreline Inlet, Kussmaul Super Auto-Eject, 20A Shore Inlet, 20 AMP, Auto Eject ILOS. 20 AMP/125VAC shoreline inlet in lieu of standard 15 amp. Includes mating female connector body for inlet and 20 amp GFI circuit breaker combo in lieu of standard 15 amp. Install the breaker box installed behind the driver's seat.	1	12.1.54.0
12-01-6200		RR, Kussmaul, Eject,Cover,15 or 20A,White	1	12.1.62.0
12-01-9020		RR, GFI Box Location- Behind Driver's Seat	1	
12-02-0200		RR, Outlets, Interior, 125V-15A (1) Action Wall, (1) Right Stack (1) outlet shall be mounted on the action area medical rail (1) outlet shall be mounted above the top shelf in cabinet L8	1	12.2.2.0
12-02-2050		RR, Outlets, Interior, Each, Additional, 125V-15A, Action Area Wall Installed near the CPR side seat on the medical device rail. See CA Drawings.	1	12.2.50.0

PART NO	S	DESCRIPTION	QTY	REF. NO
BLOCKHEATERS				
12-02-4001		Block Heater - With OEM Plug This option does not include a switch. (STANDARD).	1	
INVERTER - 125VAC				
12-03-1110		RR, Inverter Charger - Vanner LifeSine, with charger indicator on Console Install the inverter in the interior L1 cabinet.	1	12.3.124.0
13 - ENVIRONMENTAL SYSTEMS				
ENVIROMENTAL CLIMATE CONTROL SYSTEM				
13-01-1200		RR, HVAC - Central Air Flow Discharge (UM & UM-150)	1	
13-01-2000		RR, Climate Control - (UM & UM-150)	1	
13-02-0100		RR, Exhaust Fan - 100 CFM Standard Location	1	13.2.20.0
HVAC BASE SYSTEM - HOSELINE				
13-02-5602		RR, HVAC Aux Front Wall Coolbar, Hoseline, Ford F-series PC Elec	1	13.2.56.2
13-02-5702		RR, Cover, Cool Bar, (5) M9 Series lights Drawing # 303347 (5) M9 series lights only. Note: Will be painted same color as the mount location on box front.	1	13.2.57.2
13-03-1000		RR, Return Air System	1	
13-03-2000		RR, Return Air Central Plenum	1	
13-03-3000		RR, Heat/AC Cabinet	1	
14 - MEDICAL SYSTEMS				
COT MOUNTING PROVISIONS				
14-01-1010		RR, Cot Mounting, Hardware	1	
14-01-1110		RR, Post & Wheel Cups, None	1	
14-01-1210		RR, Safety Hook, Ship Loose	1	
14-01-1220		RR, Safety Hook, Ferno with bolts, Shipped Loose.	1	14.1.12.1
14-01-1622		RR, Stryker Power Load/ Performance Load, Floor Plates and Wiring for Future Ins Additional floor structure for future installation of a Stryker #6390 Power-LOAD system or 9392 Performance Load. Includes pre-wire which will terminate under the attendant's seat	1	14.1.16.22
14-01-1926		RR, Cut Floor and Install Cot Mount Floor plate, 6390-700-001A For Powerload or Performance Load Cot mounts.	1	14.1.3093
14-01-4028		Center Mount	1	
OXYGEN AND AIR SYSTEMS				
14-02-0050		RR, O2 System, PC System	1	
14-02-1000		RR, O2 Cylinder Wrench	1	14.2.15.0
14-02-2000		RR, O2 Cylinder Bracket - Zico #QR-MV	1	14.2.16.0
14-02-3000		RR, O2 Control - Electric with Manual Bypass on Action Wall.	1	14.2.30.0
14-02-3160		RR, O2 Regulator, Wall Mount with 24" braided hose extension (PC)	1	14.2.67.0
14-02-4000		RR, O2 Outlets, Ohio Style, (2) Action Wall, (1) Squad Bench (2) O2 outlets in Action area medical device rail (1) O2 outlet CS Wall head of squad bench in medical device rail *** NOTE *** O2 outlets MUST be at least 12" from any 125V AC outlet.	1	14.2.31.0
14-02-4100		RR, O2 Outlet, Relocate (1) Action Wall Outlet to Ceiling See CA Drawings.	1	14.2.43.0
14-02-6120		RR, O2 Cylinder Holder, (2) FW-521 Universal, CN 10 Certified Installed at the head of the squad bench.	1	14.2.115.2

PART NO	S	DESCRIPTION	QTY	REF. NO
SUCTION SYSTEM				
14-03-1010		RR, Suction System, SSCOR On-Board Conforms to J3043 requirements	1	14.3.40.0
MISC MEDICAL				
14-04-1000		RR, Fire Extinguisher, 5# ABC w/ Mounting Bracket HD Amerex Bracket #861H with Amerex 5LB fire extinguisher. SHIPPED LOOSE	1	14.4.2.0
15 - PAINT / DECALS AND NOMENCLATURE PAINT AND FINISH				
15-00-0100		RR, Road Rescue Paint Process	1	15.1.30.0
15-01-2000		Module Paint, Single Color, OEM White	1	
Ford white: FA91:YZ				
15-01-5000		Cab Paint - Single Color, OEM White	1	
15-02-3001	S	RR, Fine Line Paint Edge	1	1251006
GRAPHICS AND LETTERING				
15-03-3900		RR, Badge Logos	1	
15-03-4000		RR, Logos and Model Name	1	
15-03-4001		RR, Ultramedic - Black Logos	1	15.3.40.1
15-04-1000		RR, Nomenclature Plaques. DIESEL.	1	15.4.1000
16-01-0200		RR, Owner's Manual	1	16.1.2.0
74-09-0099		Indemnification Statement The purchaser agrees to defend, indemnify and hold Rev Ambulance Group harmless from any claims, costs (including actual attorneys' fees), damages and liabilities caused in whole or in part by any alteration or modification of, or changes or additions to the purchased products OR use of product for purposes it was not designed or intended for.	1	
== Factory Ship Loose - EMS Equipment - 1.017 11/12/21 ==				



BURGESS DEMO F-550 4 X 4 ULTRAMEDIC PASS-THROUGH

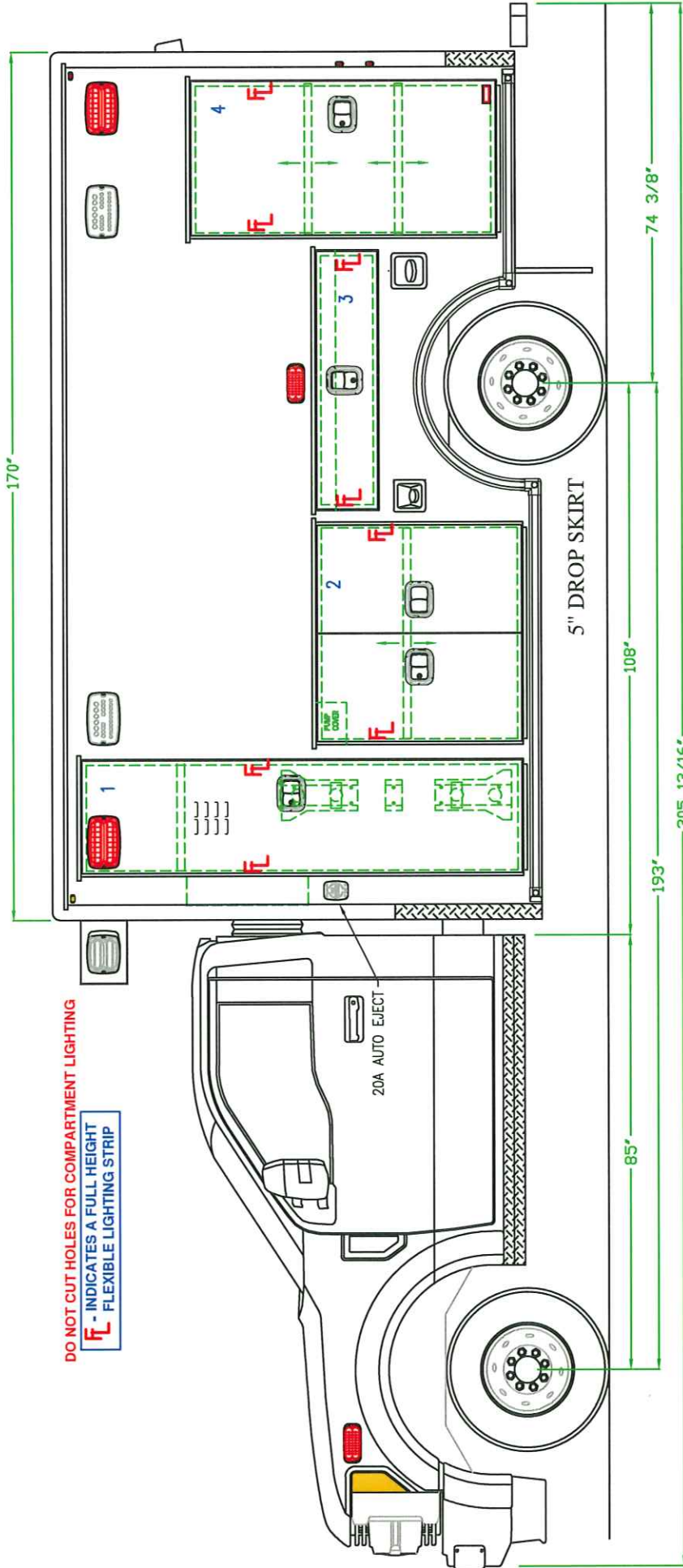

PROPRIETARY AND CONFIDENTIAL
THIS INFORMATION CONTAINED IN THIS DRAWING IS THE SOLE PROPERTY OF ROAD RESCUE ANY REPRODUCTION IN PART OR AS A WHOLE WITHOUT THE WRITTEN PERMISSION OF ROAD RESCUE IS PROHIBITED.

NOTES:
DETAILS ARE CONCEPTUAL ONLY LAYOUT AND ALL DIMENSIONS ARE APPROXIMATE AND SUBJECT TO MODIFICATION BY DESIGN ENGINEERING.

100R NO.	INTERIOR DIMENSIONS		NOTES	
	HEIGHT	WIDTH		DEPTH
1	86.50"	23.25"	22.00"	FIXED SHELF, DOOR LOUVERS, O2 STORAGE
2	40.50"	43.88"	21.25"	SPARE TIRE STORAGE
4	59.06"	31.00"	21.25"	(2) ADJ. SHELVES

Road Rescue 2737 N. Forsyth Rd. Winter Park, FL 32792
 PHONE 800-932-7077 FAX 800-513-2688
 DATE 06/21/2023 REVISION 1 08/08/2023

STREETSIDE EXTERIOR DETAIL

BID NUMBER 619163

SHEET 1 OF 10

SCALE REVISION 2 REVISION 3

NOTE: THIS DRAWING IS SUBJECT TO CHANGE PENDING ROAD RESCUE PRODUCTION ENGINEERING APPROVAL. © ROAD RESCUE ALL RIGHTS RESERVED.



BURGESS DEMO F-550 4 X 4 ULTRAMEDIC PASS-THROUGH

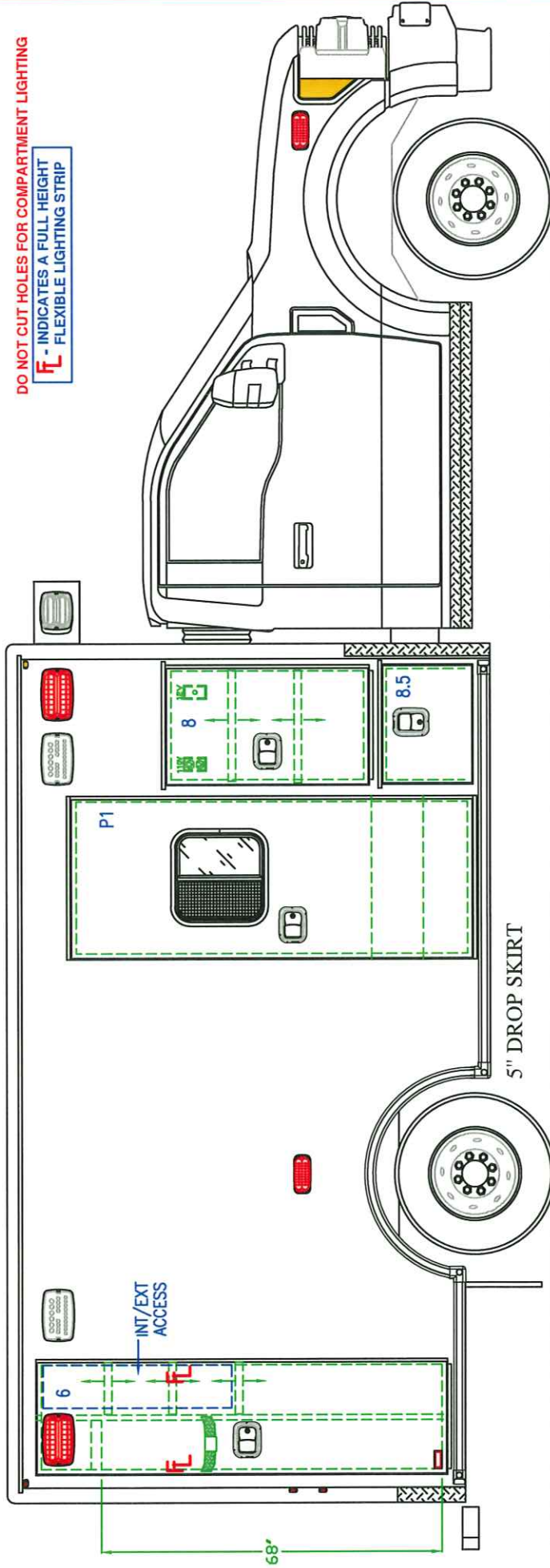

DOOR NO.	INTERIOR DIMENSIONS		DOOR DIMENSIONS		MISC. NOTES
	HEIGHT	WIDTH	HEIGHT	WIDTH	
6	81.50"	22.75"	40.00"	23.00"	(1) FIXED DIVIDER, (3) ADJ. SHELVES
8.5	17.50"	23.00"	80.00"	30.06"	BATTERY DRAWER
DETAILS ARE CONCEPTUAL ONLY LAYOUT AND ALL DIMENSIONS ARE APPROXIMATE AND SUBJECT TO MODIFICATION BY DESIGN ENGINEERING.					

PROPRIETARY AND CONFIDENTIAL
THIS INFORMATION CONTAINED IN THIS DRAWING IS THE SOLE PROPERTY OF ROAD RESCUE ANY REPRODUCTION IN PART OR AS A WHOLE WITHOUT THE WRITTEN PERMISSION OF ROAD RESCUE IS PROHIBITED.

Road Rescue 2737 N. Forsyth Rd Winter Park, FL 32792
 PHONE 800-932-7077 FAX 800-513-2688
 DATE 06/21/2023 REVISION 1 08/08/2023

Road Rescue CURBSIDE EXTERIOR DETAIL
 REVISION 2 REVISION 3 SCALE SHEET 2 OF 10

BID NUMBER 619163

NOTE: THIS DRAWING IS SUBJECT TO CHANGE PENDING ROAD RESCUE PRODUCTION ENGINEERING APPROVAL. © ROAD RESCUE ALL RIGHTS RESERVED.



BURGESS DEMO F-550 4 X 4 ULTRAMEDIC PASS-THROUGH

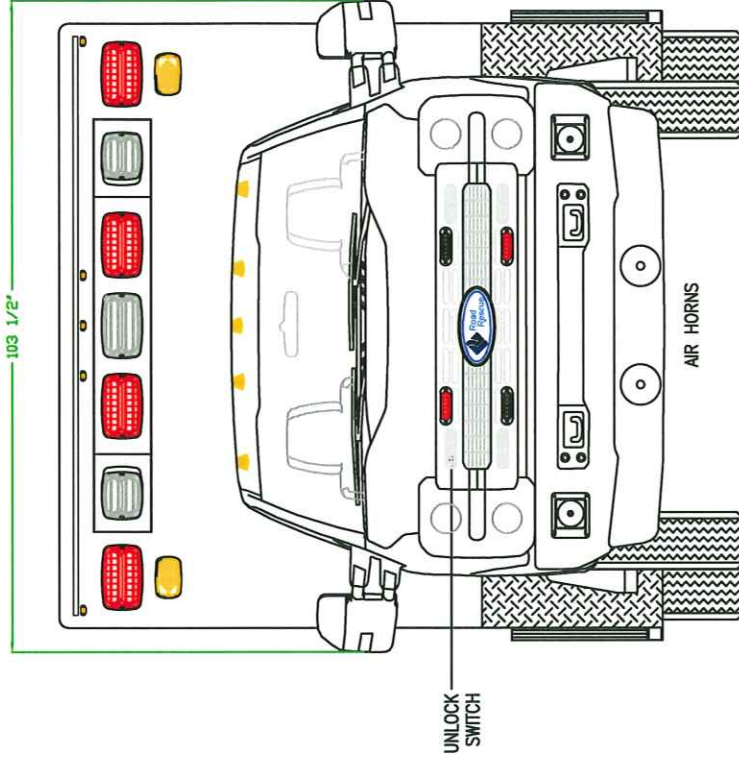
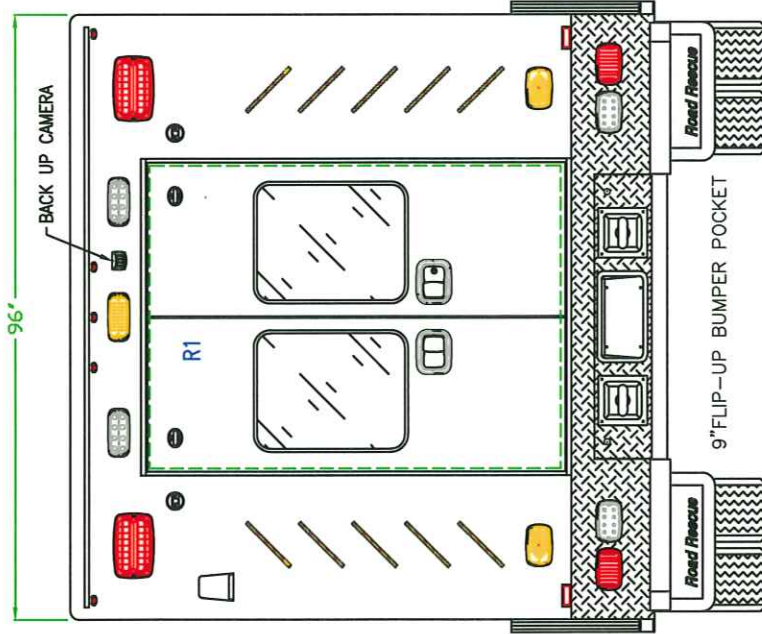

PROPRIETARY AND CONFIDENTIAL
THIS INFORMATION CONTAINED IN THIS DRAWING IS THE SOLE PROPERTY OF ROAD RESCUE ANY REPRODUCTION IN PART OR AS A WHOLE WITHOUT THE WRITTEN PERMISSION OF ROAD RESCUE IS PROHIBITED.

DETAILS ARE CONCEPTUAL ONLY LAYOUT AND ALL DIMENSIONS ARE APPROXIMATE AND SUBJECT TO MODIFICATION BY DESIGN ENGINEERING.

DOOR NO.	CLEAR OPENING HEIGHT	WIDTH	DEPTH	NOTES
R1	61.44"	50.25"	18" X 24"	FIXED TINTED WINDOWS

Road Rescue 2737 N. Forsyth Rd. Winter Park, FL 32792
 PHONE 800-932-7077 FAX 800-513-2688
 DATE 06/21/2023 REVISION 1 08/08/2023
 RAWN BY DG

FRONT & REAR EXTERIOR DETAIL

BID NUMBER 619163

SHEET 3 OF 10

SCALE REVISION 3

NOTE: THIS DRAWING IS SUBJECT TO CHANGE PENDING ROAD RESCUE PRODUCTION ENGINEERING APPROVAL. © ROAD RESCUE ALL RIGHTS RESERVED.



BURGESS DEMO F-550 4 X 4 ULTRAMEDIC PASS-THROUGH

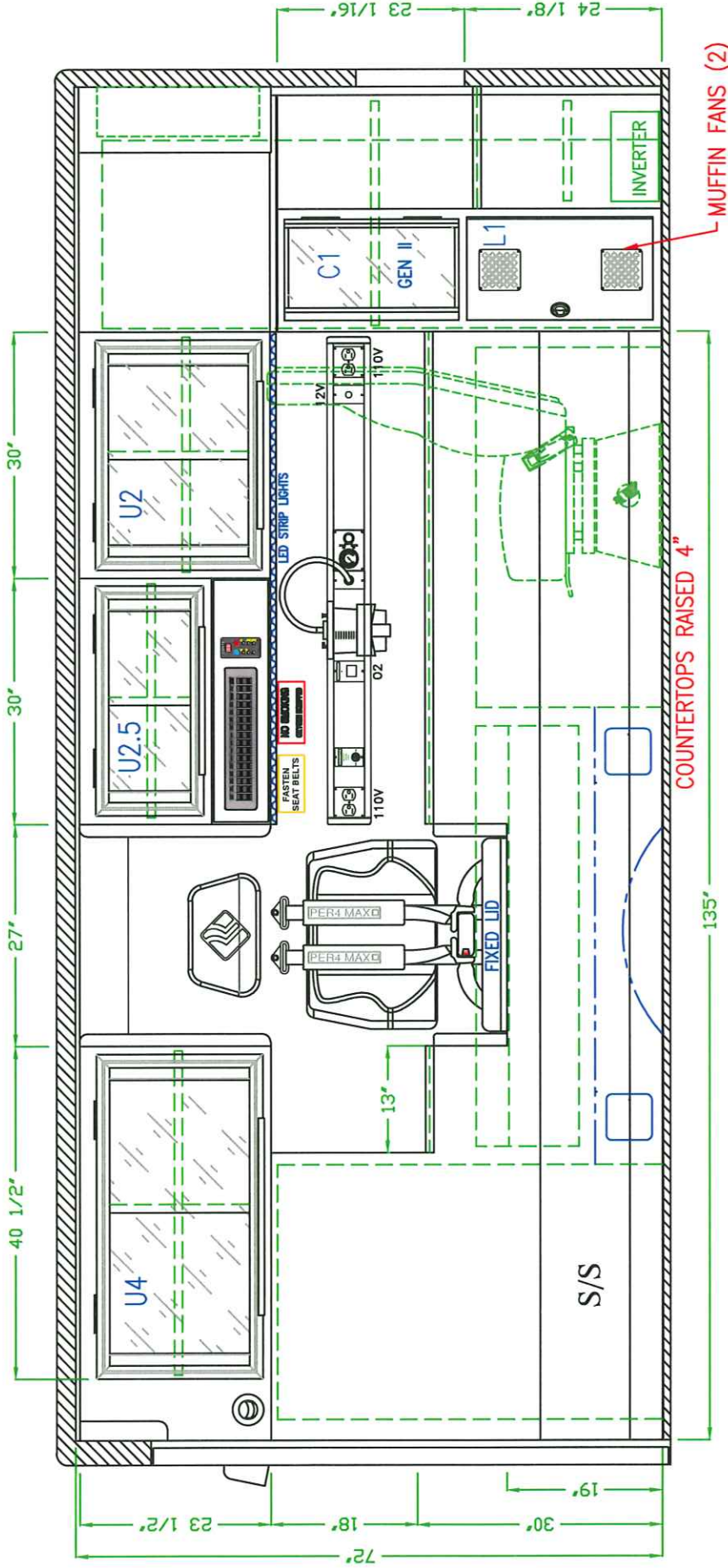

DOOR NO.	INTERIOR DIMENSIONS		DOOR NO.	INTERIOR DIMENSIONS		MISC. NOTES
	HEIGHT	WIDTH		HEIGHT	DEPTH	
C1	23.00"	28.50"	U4	23.50"	40.50"	SLIDING POLY DOORS, (1) ADJ. SHELF, RESTOCKING
L1	23.62"	28.50"				SINGLE ALUM. DOOR,
U2	23.50"	29.62"				SLIDING POLY DOORS, (1) ADJ. SHELF, RESTOCKING
J2.5	16.00"	29.62"				SLIDING POLY DOORS, (1) ADJ. SHELF, RESTOCKING

PROPRIETARY AND CONFIDENTIAL
THIS INFORMATION CONTAINED IN THIS DRAWING IS THE SOLE PROPERTY OF ROAD RESCUE ANY REPRODUCTION IN PART OR AS A WHOLE WITHOUT THE WRITTEN PERMISSION OF ROAD RESCUE IS PROHIBITED.

DETAILS ARE CONCEPTUAL ONLY. LAYOUT AND DIMENSIONS ARE APPROXIMATE AND SUBJECT TO MODIFICATION BY DESIGN ENGINEERING

Road Rescue
 2737 N. Forsyth Rd.
 Winter Park, FL 32792
 www.roadrescue.com PHONE 800-932-7077 FAX 800-513-2688

RAWN BY DATE 06/21/2023
 REVISION 1 08/08/2023

REVISION 2
 REVISION 3

SCALE SHEET 4 OF 10

BID NUMBER **619163**

STREETSIDE INTERIOR DETAIL

NOTE: THIS DRAWING IS SUBJECT TO CHANGE PENDING ROAD RESCUE PRODUCTION ENGINEERING APPROVAL. © ROAD RESCUE ALL RIGHTS RESERVED.



BURGESS DEMO F-550 4 X 4 ULTRAMEDIC PASS-THROUGH

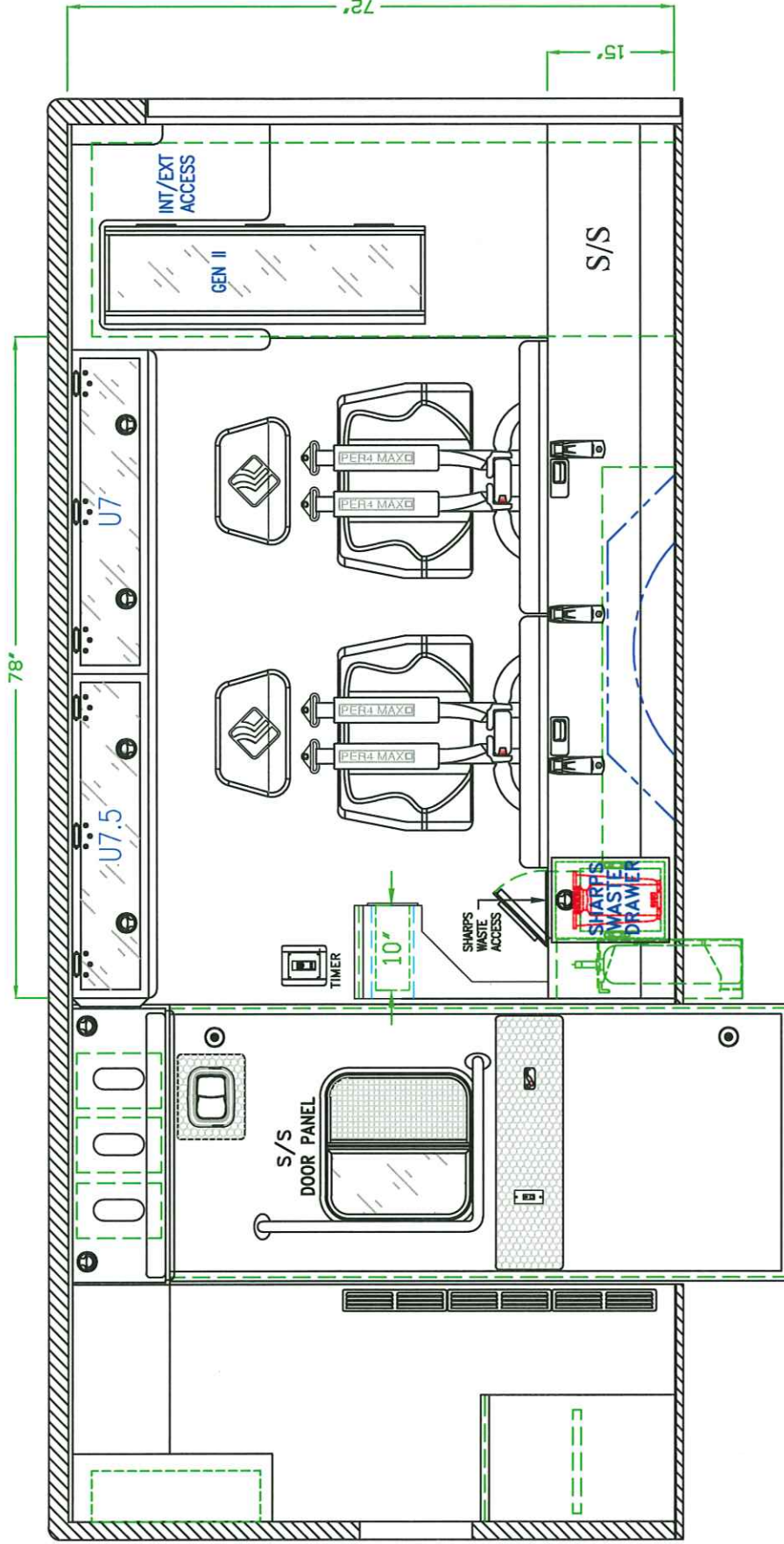

ROOM NO.	INTERIOR DIMENSIONS	NOTES		
NO.	HEIGHT	WIDTH	DEPTH	
U7	9.00"	40.00"	8.50"	LIFT UP POLY DOOR, RESTOCKING
J7.5	9.00"	38.00"	8.50"	LIFT UP POLY DOOR, RESTOCKING

PROPRIETARY AND CONFIDENTIAL
THIS INFORMATION CONTAINED IN THIS DRAWING IS THE SOLE PROPERTY OF ROAD RESCUE ANY REPRODUCTION IN PART OR AS A WHOLE WITHOUT THE WRITTEN PERMISSION OF ROAD RESCUE IS PROHIBITED.

DETAILS ARE CONCEPTUAL ONLY. LAYOUT AND DIMENSIONS ARE APPROXIMATE AND SUBJECT TO MODIFICATION BY DESIGN ENGINEERING

Road Rescue 2737 N. Forsyth Rd. Winter Park, FL 32792
 www.roadrescue.com PHONE 800-932-7077 FAX 800-513-2688

DATE 06/21/2023 REVISION 1 08/08/2023

RAWN BY DG

REVISION 2 REVISION 3 SCALE SHEET 5 OF 10

CURBSIDE INTERIOR DETAIL

BID NUMBER **619163**

NOTE: THIS DRAWING IS SUBJECT TO CHANGE PENDING ROAD RESCUE PRODUCTION ENGINEERING APPROVAL. © ROAD RESCUE ALL RIGHTS RESERVED.



BURGESS DEMO F-550 4 X 4 ULTRAMEDIC PASS-THROUGH

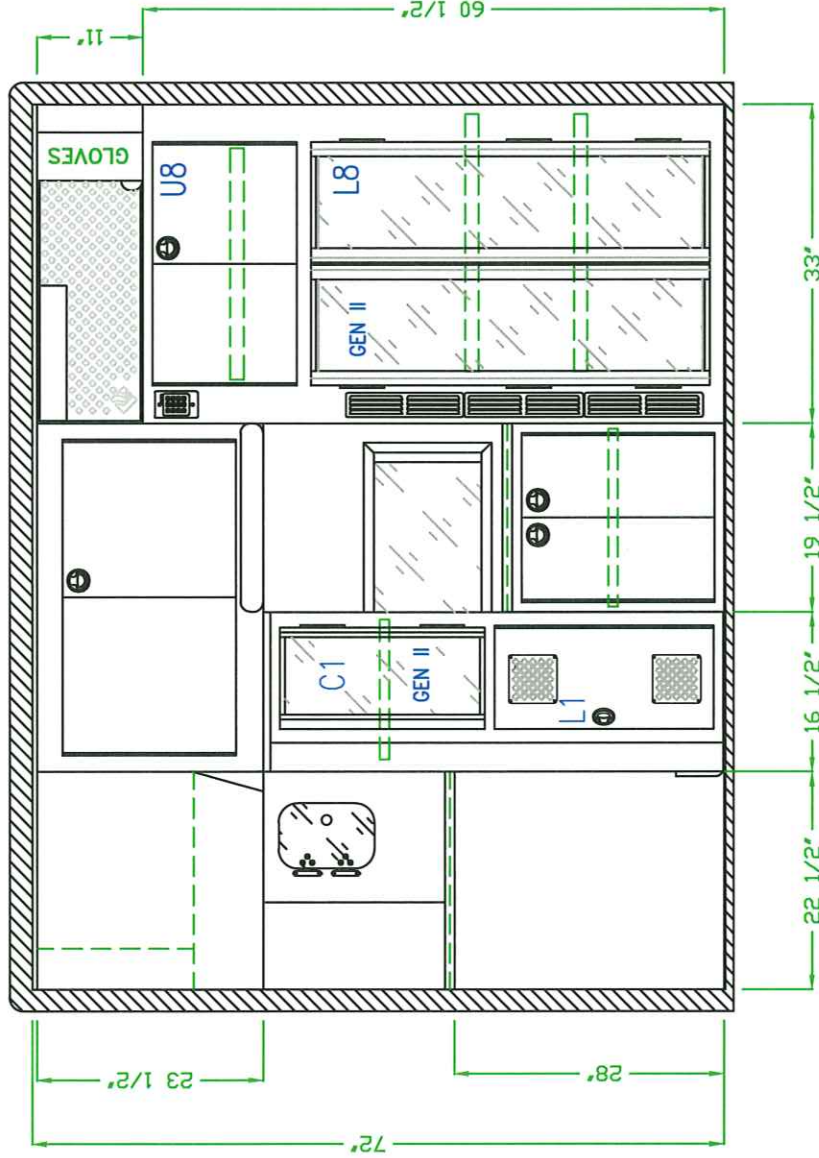

DOOR NO.	INTERIOR DIMENSIONS		NOTES	
	HEIGHT	WIDTH		DEPTH
U8	16.00"	28.00"	26.00"	DOUBLE SOLID DOORS, (1) ADJ. SHELF, ELECTRIC LOCK
L8	25.00"	28.00"	26.00"	GEN II OHO DOORS, (1) ADJ. SHELF

PROPRIETARY AND CONFIDENTIAL
THIS INFORMATION CONTAINED IN THIS DRAWING IS THE SOLE PROPERTY OF ROAD RESCUE ANY REPRODUCTION IN PART OR AS A WHOLE WITHOUT THE WRITTEN PERMISSION OF ROAD RESCUE IS PROHIBITED.

DETAILS ARE CONCEPTUAL ONLY. LAYOUT AND DIMENSIONS ARE APPROXIMATE AND SUBJECT TO MODIFICATION BY DESIGN ENGINEERING

Road Rescue 2737 N. Forsyth Rd. Winter Park, FL 32792
 PHONE 800-932-7077 FAX 800-513-2888
 DATE 06/21/2023 REVISION 1 08/08/2023

FRONT INTERIOR DETAIL BID NUMBER 619163

REVISION 2 REVISION 3 SCALE SHEET 6 OF 10

NOTE: THIS DRAWING IS SUBJECT TO CHANGE PENDING ROAD RESCUE PRODUCTION ENGINEERING APPROVAL. © ROAD RESCUE ALL RIGHTS RESERVED.



BURGESS DEMO F-550 4 X 4 ULTRAMEDIC PASS-THROUGH

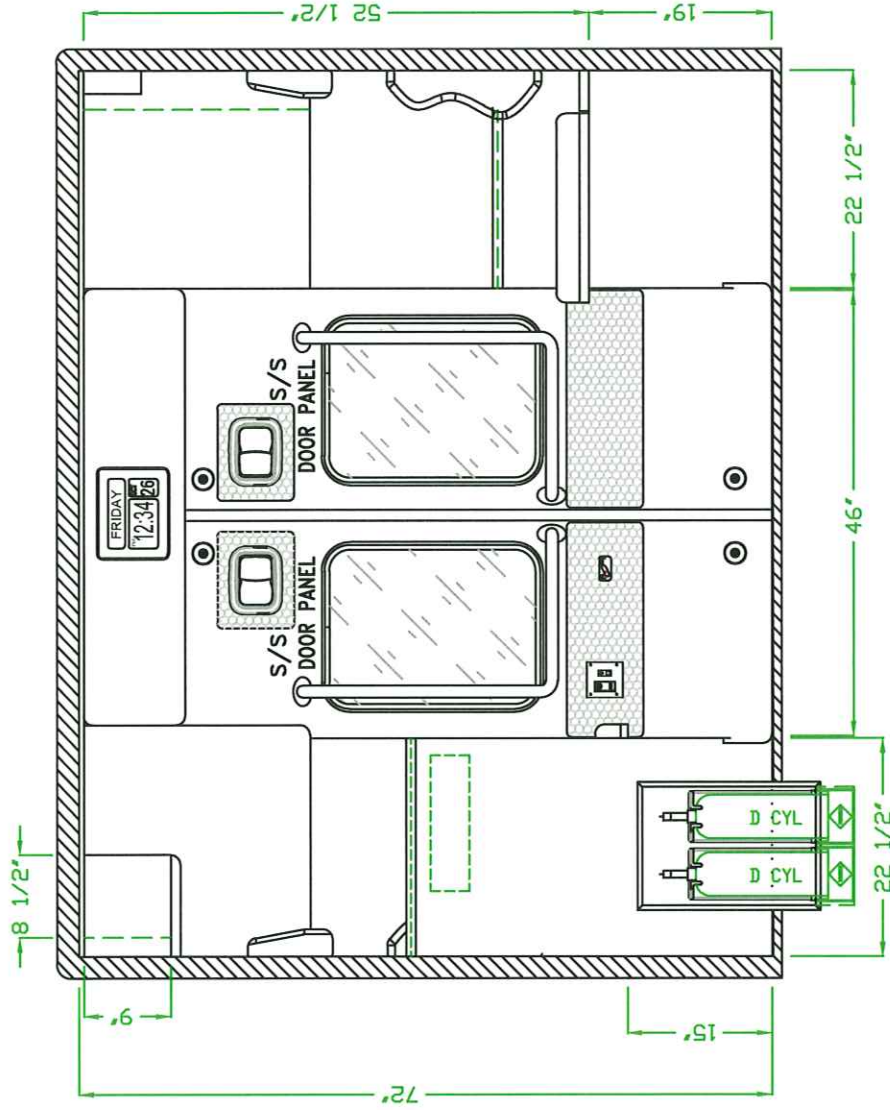

PROPRIETARY AND CONFIDENTIAL
THIS INFORMATION CONTAINED IN THIS DRAWING IS THE SOLE PROPERTY OF ROAD RESCUE ANY REPRODUCTION IN PART OR AS A WHOLE WITHOUT THE WRITTEN PERMISSION OF ROAD RESCUE IS PROHIBITED.

DETAILS ARE CONCEPTUAL ONLY. LAYOUT AND DIMENSIONS ARE APPROXIMATE AND SUBJECT TO MODIFICATION BY DESIGN ENGINEERING

BID NUMBER

REAR INTERIOR DETAIL

2737 N. Forsyth Rd.
Winter Park, FL 32792

www.roadrescue.com PHONE 800-932-7077 FAX 800-513-2888

RAWN BY DATE 06/21/2023

REVISION 1

REVISION 2

REVISION 3

SCALE

SHEET 7 OF 10



NOTE: THIS DRAWING IS SUBJECT TO CHANGE PENDING ROAD RESCUE PRODUCTION ENGINEERING APPROVAL. © ROAD RESCUE ALL RIGHTS RESERVED.



BURGESS DEMO F-550 4 X 4 ULTRAMEDIC PASS-THROUGH

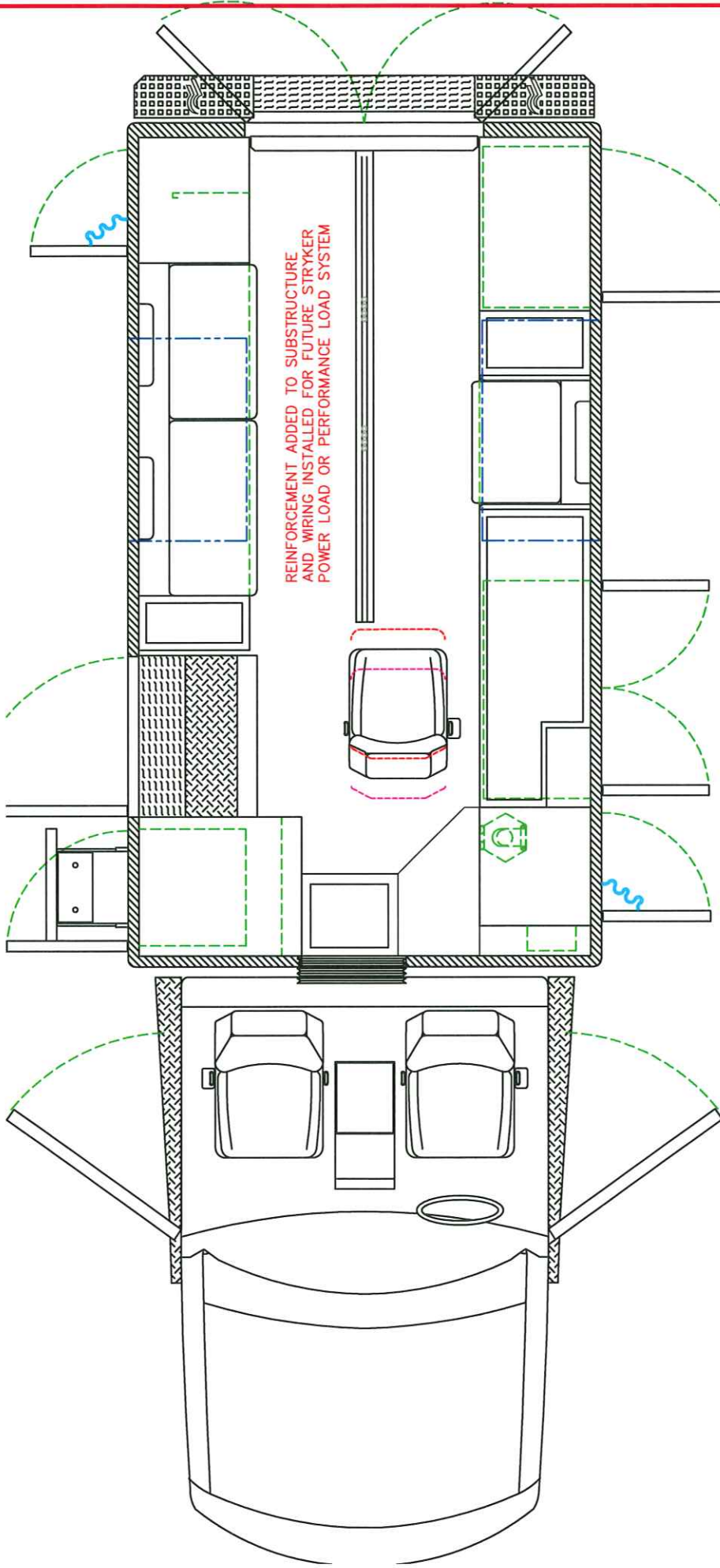

PROPRIETARY AND CONFIDENTIAL
THIS INFORMATION CONTAINED IN THIS DRAWING IS THE SOLE PROPERTY OF ROAD RESCUE ANY REPRODUCTION IN PART OR AS A WHOLE WITHOUT THE WRITTEN PERMISSION OF ROAD RESCUE IS PROHIBITED.

DETAILS ARE CONCEPTUAL ONLY LAYOUT AND ALL DIMENSIONS ARE APPROXIMATE AND SUBJECT TO MODIFICATION BY DESIGN ENGINEERING.

Road Rescue www.roadrescue.com PHONE 800-932-7077 FAX 800-513-2688		2737 N. Forsyth Rd. Winter Park, FL 32792	
RAWN BY DG	DATE 06/21/2023	REVISION 1 08/08/2023	REVISION 2
SCALE		REVISION 3	SHEET 8 OF 10
FLOOR DETAIL		BID NUMBER	619163

NOTE: THIS DRAWING IS SUBJECT TO CHANGE PENDING ROAD RESCUE PRODUCTION ENGINEERING APPROVAL. © ROAD RESCUE ALL RIGHTS RESERVED.



BURGESS DEMO F-550 4 X 4 ULTRAMEDIC PASS-THROUGH

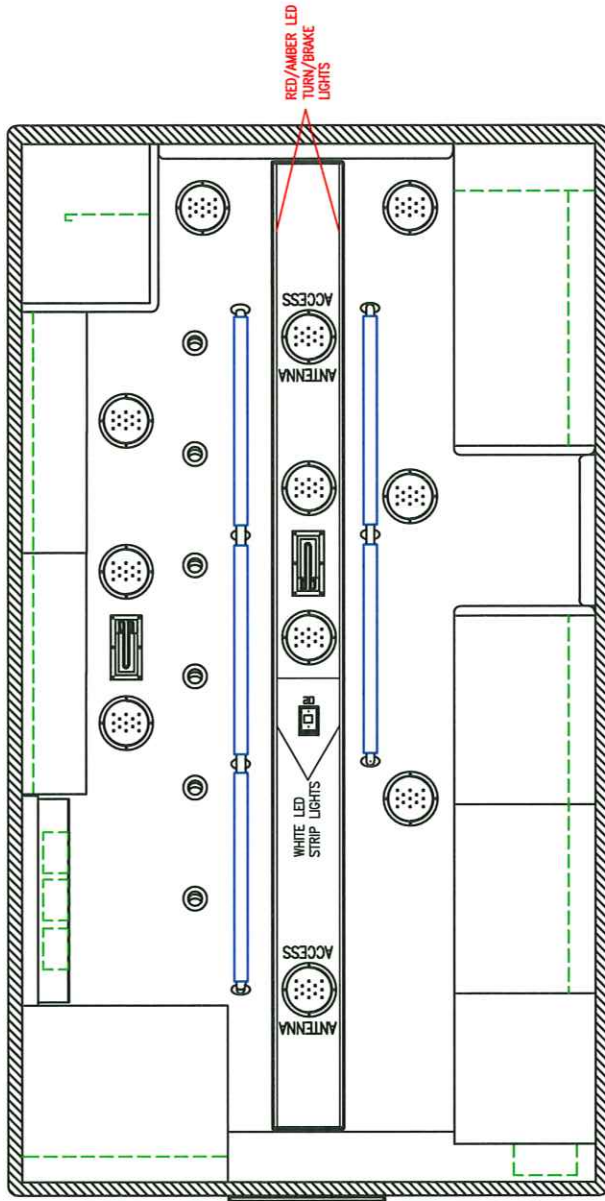
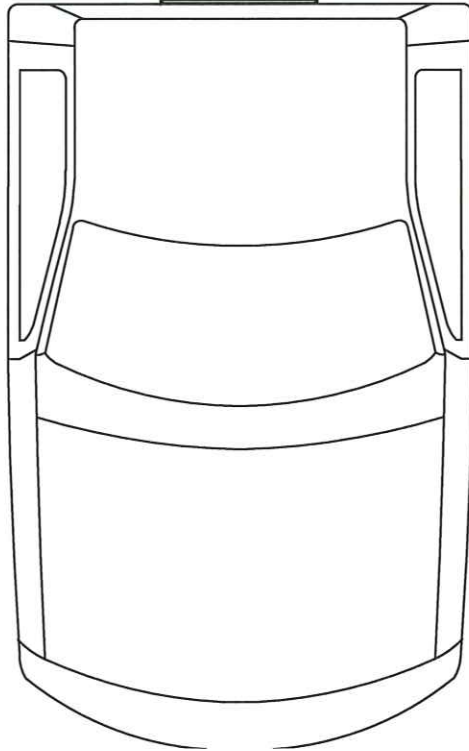

PROPRIETARY AND
CONFIDENTIAL
THIS INFORMATION
CONTAINED IN THIS
DRAWING IS THE SOLE
PROPERTY OF ROAD
RESCUE ANY
REPRODUCTION IN PART
OR AS A WHOLE
WITHOUT THE WRITTEN
PERMISSION OF ROAD
RESCUE IS PROHIBITED.

DETAILS ARE CONCEPTUAL ONLY LAYOUT AND ALL DIMENSIONS
ARE APPROXIMATE AND SUBJECT TO MODIFICATION BY DESIGN ENGINEERING.

Road Rescue		2737 N. Forsyth Rd. Winter Park, FL 32792		CEILING DETAIL		BID NUMBER	
w.roadrescue.com PHONE 800-932-7077 FAX 800-513-2688		REVISION 2		REVISION 3		619163	
RAWN BY	DATE	REVISION 1	SCALE	SHEET	OF		
DG	06/21/2023			9	10		

NOTE: THIS DRAWING IS SUBJECT TO CHANGE PENDING ROAD RESCUE PRODUCTION ENGINEERING APPROVAL. © ROAD RESCUE ALL RIGHTS RESERVED.



BURGESS DEMO F-550 ULTRAMEDIC // PASS-THROUGH



BLACK POLYURETHANE COATED

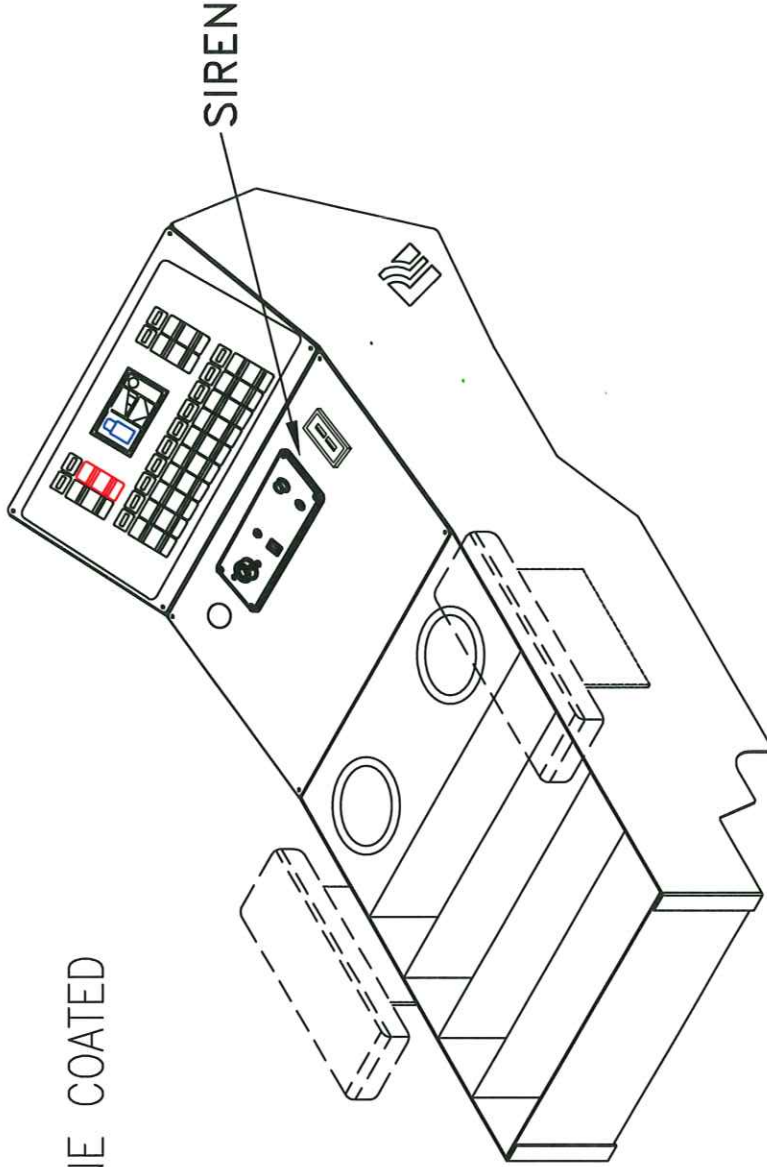

PROPRIETARY AND CONFIDENTIAL
THIS INFORMATION CONTAINED IN THIS DRAWING IS THE SOLE PROPERTY OF ROAD RESCUE ANY REPRODUCTION IN PART OR AS A WHOLE WITHOUT THE WRITTEN PERMISSION OF ROAD RESCUE IS PROHIBITED

DETAILS ARE CONCEPTUAL ONLY. LAYOUT AND ALL DIMENSIONS ARE APPROXIMATE AND SUBJECT TO MODIFICATION BY DESIGN ENGINEERING.

Road Rescue 2737 N. Forsyth Rd. Winter Park, FL 32792 www.roadrescue.com PHONE 800-932-7077 FAX 800-513-2688		BID NUMBER 619163	
DATE	REVISION 1	REVISION 2	REVISION 3
DRAWN BY		SCALE	SHEET 10 OF 10
CONSOLE CONFIGURATION			

NOTE: THIS DRAWING IS SUBJECT TO CHANGE PENDING ROAD RESCUE PRODUCTION ENGINEERING APPROVAL. © ROAD RESCUE ALL RIGHTS RESERVED.



CONTRACT

THIS AGREEMENT is made on October 24th, 2023, between the City of Parma Heights, Parma Heights, OH, and Burgess Ambulance Sales, Inc., of Loudonville, Ohio (“Contractor”).

Witnesseth:

That the parties, in consideration of the agreements contained below to be met by the respective parties, agree as follows:

Contractor agrees to sell, furnish, and deliver for the City of Parma Heights the following: (1) Road Rescue Ultramedic Module Demonstrator Unit # 619163, for the sum of **\$329,557.00**.

Contractor agrees to furnish and deliver said ambulance strictly in accordance with the quote supplied, hereto and made a part of this agreement.

IN WITNESS WHEREOF, The City of Parma Heights has caused this contract to be signed, and the contractor has executed this contract the day and year aforesaid.

BURGESS AMBULANCE SALES, INC.

CITY OF PARMA HEIGHTS



Matt Young: Sales Representative

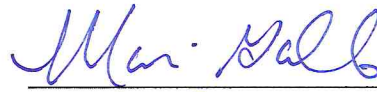

Marie Gallo - Mayor

