

**RESOLUTION NO. 2023 - 82**

**A RESOLUTION AUTHORIZING THE ADMINISTRATION TO PURCHASE ONE (1) FIRE PARAMEDIC VEHICLE FROM BURGESS AMBULANCE SALES AT A STATE PURCHASE PRICE OF \$329,557.00, AND DECLARING AN EMERGENCY**

**WHEREAS**, the City has been awarded a 2023 Community Development Block Grant (CDBG), and grant funds have been allocated in the amount of \$150,000.00 for the purchase of one (1) Fire Paramedic Vehicle; and

**WHEREAS**, in order to equip the Fire Department and expend the CDBG grant funds, the Fire Chief has solicited quotes for the assembly and purchase of a Fire Paramedic Vehicle from manufacturers authorized by the Ohio Department of Administrative Services aka the State Purchasing Program; and

**WHEREAS**, Burgess Ambulance Sales proposes to assemble and deliver one (1) Fire Paramedic Vehicle to the City of Parma Heights for a sum not to exceed Three Hundred and Twenty-Nine Thousand, Five Hundred and Fifty-Seven Dollars (\$329,557.00), as described in Exhibit "A", attached hereto and incorporated by reference; and

**WHEREAS**, Council may authorize the purchase pursuant to the State Purchasing Program without competitive bidding process based upon the authority granted to it in Article V Section 6 of the Charter, and Sections 145.08 and 145.09 of the Codified Ordinances.

**NOW, THEREFORE, BE IT RESOLVED** by the Council of the City of Parma Heights, County of Cuyahoga and State of Ohio:

Section 1: That the Administration is hereby authorized and directed to purchase from Burgess Ambulance Sales one (1) Fire Paramedic Vehicle and related safety equipment for the sum not to exceed \$329,557.00, as described in Exhibit "A", attached hereto and incorporated by reference.

Section 2: Council does hereby authorize the purchase pursuant to the State Purchasing Program without competitive bidding process pursuant to Article V Section 6 of the Charter, and Sections 145.08 and 145.09 of the Codified Ordinances.

Section 3: This Council finds and determines that all formal actions of this Council concerning and relating to the adoption of this Resolution were taken in an open meeting of this Council and that all deliberations of the Council and of any of its Committees comprised of a majority of the members of the Council that resulted in those formal actions were in meeting open to the public, in compliance with the law.

Section 4: This Resolution is declared to be an emergency measure necessary for the public peace, health and safety of the Municipality, and for the further reason it is necessary to place an immediate order to secure the vehicle and have the equipment installed for delivery for the efficient operation of the Fire Department; wherefore, this Resolution shall be in full force and effect immediately upon its passage by Council and approval by the Mayor.

PASSED: November 13, '23

Thomas Rounds  
PRESIDENT OF COUNCIL

ATTEST: Barbara Alled  
CLERK OF COUNCIL

November 13, 2023  
APPROVED

FILED WITH  
THE MAYOR: November 13, '23

Marie Gallo  
MAYOR MARIE GALLO

# EXHIBIT A



Parma Heights Fire Department  
Attn: Matt Bernard

Dear Chief Bernard,

If you wish to purchase through Burgess Ambulance Sales (STS Contract #800749), the following is a proposal for 1 (one) 2023 Road Rescue Ultramedic Module Demonstrator, mounted on a Ford F550 4x4 Diesel Chassis for the sum of **\$329,557.00**. This price includes all applicable manufacturers rebates, as well as all of the standard and additional options listed in the enclosed work order.

All Road Rescue ambulances come with the standard Road Rescue warranty. Delivery will be in September or October of 2024. Please call me with any questions or concerns at 800-541-9518. This quote is valid for 30 days from the above date.

Thank You,

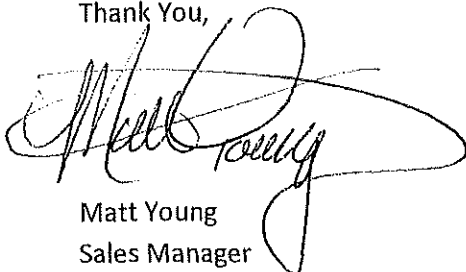

Matt Young  
Sales Manager



BASI Demo  
527 Wooster Road  
Loudonville, OH 44842

Burgess Ambulance  
Matt Young  
527 Wooster Road  
Loudonville, OH 44842  
MJP

Rev. Date: 10/05/2023  
Quote No: PINKED-0000  
Job/Order No: 619163  
10/06/2023 09:29:56

WO#: 619163

| PART NO    | S | DESCRIPTION  | QTY | REF. NO         |
|------------|---|--|-----|-----------------|
|            |   | <b>== RR-Road Rescue Boilerplate - 1.017 11/12/21 ==</b>   |     |                 |
|            |   | <b>ORDER COORDINATOR</b>   |     |                 |
| 00-00-0016 |   | Order Coordinator - Mitchell Pettis- (321) 441-8035  | 1   | BID INFORMATION |
|            |   | <b>INFORMATION</b>   |     |                 |
| 00-01-0999 |   | RR, Information - Scope, Purpose and Classification  | 1   |                 |
|            |   | <b>WARRANTY</b>  |     |                 |
| 00-02-8100 |   | RR, Warranty, Documentation  | 1   |                 |
| 00-02-8200 |   | RR, Warranty, Module Structural  | 1   | 00.02.8200-14   |
| 00-02-8300 |   | RR, Warranty, Electrical, Standard System  | 1   | 00.02.8300-14   |
| 00-02-8400 |   | RR, Warranty, Paint  | 1   | 0599997-14      |
| 00-02-8500 |   | RR, Warranty, Conversion   | 1   | 00.02.8500-14   |
|            |   | <b>== RR- Type 1 - UM 170" Module - 1.017 11/12/21 ==</b>  |     |                 |
| 00-05-0103 |   | RR, This unit built in accordance with KKK-A-1822F CN 10 Cabinet Requirements<br>This unit as specified meets all requirements of KKK-A1822-F Change notice 10.<br><br>All cabinets shall be labeled as to their capacity Rating.  | 1   |                 |
|            |   | <b>01- CHASSIS REQUIREMENTS</b>  |     |                 |
|            |   | <b>FORD CHASSIS</b>  |     |                 |
| 01-01-2632 | U | RR, 2023 Ford F550, XLT 4X4, 193" W/B, 19,500 GVWR (Special Order) Estimated<br>Auto throttle OEM Ford<br>Dual Alternators OEM Ford<br>Mirrors, OEM, Heated/Remote<br>Cab seats OEM 40/20/40 split bench (Center removed)<br>New for 2020- Sync 3<br>Enhanced voice recognition communication and entertainment system<br>8" LCD Capacitive Touch screen in center stack w/swipe Capability<br>Pinch to Zoom capability<br>AppLink<br>911 assist<br>Apple carPlay and Android Auto<br>Smart-charging USB-C Ports (2) | 1   | 1.1.220D        |
| 01-02-0100 |   | Domestic Chassis   | 1   |                 |
|            |   | <b>CHASSIS OPTIONS</b>   |     |                 |
|            |   | <b>ALTERNATORS</b>   |     |                 |
| 01-03-1001 |   | Alternator - Standard OEM  | 1   | 9980003         |
|            |   | <b>SUSPENSION</b>  |     |                 |
| 01-07-0120 |   | RR, Front Suspension, Ford F-Series (4x4)  | 1   |                 |
| 01-07-1009 |   | RR, Front Sway Bar, OEM  | 1   |                 |
| 01-07-8007 |   | RR, Rear Suspension, Liquid Spring- 2017+ F550, 19,500 GWV<br>Dump feature to be activated by the left rear entry door being opened.   | 1   | 1.7.8018        |

| PART NO    | S | DESCRIPTION   | QTY | REF. NO    |
|------------|---|---|-----|------------|
|            |   | The rear suspension shall only lower the module when the vehicle is in neutral or park and the parking brake is set.  |     |            |
| 01-07-9000 |   | RR, Rear Suspension Dump, Override Switch, (1), Momentary<br>Dump feature to be activated by the left rear entry door. Override switch to be on right rear entry door<br><br>Safety Triggers:<br>(1) Dump switch to be 'on' position<br>(2) Vehicle Must be in Park<br>(3) Emergency Brake must be set<br>(4) Module is to be in the 'On' position<br>(5) Open Street side rear entry door<br>(6) If Electric O2 lift, Door to that comp. must be closed. | 1   | 1.7.21.1   |
|            |   | <b>HIGH IDLE</b>  |     |            |
| 01-13-1535 |   | RR, Intermotive Module controllers, F series, Diesel ,2023+   | 1   | 1.13.15.35 |
|            |   | <b>FRONT END ALIGNMENT</b>  |     |            |
| 01-17-7501 |   | Front End Alignment, None- QC Check -Standard   | 1   |            |
|            |   | <b>CAB EXTERIOR OPTIONS</b>   |     |            |
| 01-19-0002 |   | RR, Road Rescue Stainless Grille Logo, with Diamond grade Blue reflective backin<br>Blue Diamond grade Reflective behind cut out.   | 1   | 1.19.0002  |
|            |   | <b>OUTSIDE REAR VIEW MIRRORS</b>  |     |            |
| 01-20-0100 |   | RR, Mirrors, OEM Standard   | 1   |            |
|            |   | <b>RR-CAB INTERIOR OPTIONS</b>  |     |            |
| 01-21-3500 |   | RR, Insulation, Cab, Thinsulate in Cab Ceiling (STANDARD)   | 1   | 1.21.35.0  |
|            |   | <b>RR-SAFETY OPTIONS</b>  |     |            |
|            |   | <b>RR-TIRES / WHEELS</b>  |     |            |
| 01-23-4100 |   | RR, Spare Tire Bracket, Delete<br>Spare tire will be shipped loose.   | 1   |            |
|            |   | <b>WHEEL COVERS</b>   |     |            |
| 01-24-2003 |   | RR, Wheel Covers, Phoenix w/ Lug Nut covers, F-Series   | 1   | 1.24.20.3  |
|            |   | <b>BASE CONVERSION</b>  |     |            |
| 01-45-0608 |   | RR, Conversion, Ultramedic, Type 1, 170 Module, Ford -23-1  | 1   |            |
|            |   | <b>02 - MODULE REQUIREMENTS</b>   |     |            |
| 02-01-1008 |   | RR, Ultramedic, 170"L x 96"W Type 1 Module<br>Ultramedic I - 170"L x 96"W Type I Aisle width to be 46". The interior headroom shall be 72"  | 1   | 2.1.7003.0 |
| 02-01-2100 |   | RR, Interior Headroom, 72"  | 1   |            |
| 02-01-9622 |   | RR, Aisle Space, 46" , Ultramedic I   | 1   |            |
|            |   | <b>MATERIALS</b>  |     |            |
| 02-02-0070 |   | RR, Sub floor Materials,  | 1   |            |
| 02-02-0120 |   | RR, Type I & Type III, Interior Materials   | 1   |            |
| 02-02-1000 |   | RR, Type I & Type III, Materials  | 1   |            |
|            |   | <b>03 - MODULE EXTERIOR</b>   |     |            |
|            |   | <b>UNDERCOATING</b>   |     |            |
| 03-02-0200 |   | RR, Undercoating Module (STANDARD)  | 1   | 3.2.2.0    |
|            |   | <b>EXTERIOR MODULE CONSTRUCTION</b>   |     |            |
| 03-03-0005 |   | RR, Exterior Module Construction Specifications   | 1   |            |
| 03-03-1400 |   | RR, Module Roof Radius, 3" High (STANDARD)  | 1   |            |
| 03-03-1500 |   | RR, Extreme Bonding Tape (STANDARD)   | 1   |            |
| 03-03-1600 |   | RR, Sub-floor Gusset Supports (STANDARD)  | 1   |            |
| 03-03-1700 |   | RR, One Piece Side Body Panels (STANDARD)   | 1   |            |
| 03-03-1800 |   | RR, Reinforce Rear Header (STANDARD)  | 1   |            |
| 03-03-1900 |   | RR, Single Sheet Module Roof Sheet (STANDARD)   | 1   |            |

| PART NO                                  | S | DESCRIPTION   | QTY | REF. NO  |
|--|---|---|-----|----------|
| <b>DROP SKIRTS</b>                       |   |   |     |          |
| 03-03-2010                               |   | RR, Drop Curbside Fwd Body Skirt, 5", Add Double Step, Light Duty Chassis<br><b>Drop Curbside Forward Body Skirt, Add Double Step ahead of the Curbside Wheelwell - Drop curbside forward body skirt a total of 5 Inches lower than the rearward skirt and Incorporate a Double Step in the Side Entry Step well.<br/>(Ultramedic, Promedic only)</b>   | 1   | 3.3.20.0 |
| 03-03-2110                               |   | RR, Drop Street side Fwd Body Skirt, 5", Light Duty Chassis   | 1   | 3.3.21.0 |
| <b>FUEL FILLS &amp; SPLASH PLATE</b>     |   |   |     |          |
| 03-03-8005                               |   | RR, Housing Fuel Fill, Pocket, Square   | 1   | 3.3.80.5 |
| <b>DEF FILL HOUSING AND SPLASH PLATE</b> |   |   |     |          |
| 03-03-8402                               |   | RR, DEF Fill, Housing, For Ford F series  | 1   | 3.3.84.1 |
| <b>SUB-FLOOR SYSTEM</b>                  |   |   |     |          |
| 03-04-0140                               |   | RR, 1 Inch Composite Floor Pan  | 1   |          |
| 03-04-0160                               |   | RR, Composite Floor Material  | 1   |          |
| 03-04-1700                               |   | RR, Sub-Floor Assembly, Installation  | 1   |          |
| 03-04-1800                               |   | RR, Sub-Floor Assembly, 1/8" PVC  | 1   |          |
| <b>MODULE ENTRANCE</b>                   |   |   |     |          |
| 03-05-0100                               |   | RR, Module Access, CS Door standard location  | 1   |          |
| 03-06-0100                               |   | RR, Entry Doors, Hidden Hinge, Seal on Door ,W/Push Button Fail Safe Latching<br>This includes the Fail Safe Latching mechanisms on all three entrance doors.   | 1   | 3.6.40.0 |
| 03-06-0700                               |   | RR, Hold Open Rear Door, Polished Cast Aluminum, Pin & Slot Style   | 1   | 3.6.7.0  |
| 03-06-0800                               |   | RR, Hold Open, Curb Side Entry Door, Heavy Duty Gas Spring<br>Curbside Door Restraint - Heavy Duty gas spring hold opens. - Attached by 1/4" x 20 SS Machine Screws with 1/4" x 20 Nut Inserts into Corner Gusset in Door Side entrance door to open to 90+ degrees. (STANDARD)   | 1   | 3.6.8.0  |
| 03-06-1013                               |   | RR, Entry Door Handles, Trimark Logo Chrome/Black (Interiors Located top of door)<br>*****<br>Relocate the Standard Interior Side and Rear Entrance Door Paddle Handles and Lock Boxes to the TOP of the doors.<br>With Push button Emergency Release top and bottom of each door.  | 1   | 3.6.80.0 |
| 03-06-1700                               |   | RR, Door Lubrication, Paddle Handles and Latches (STANDARD)<br>Lubricate all Door Hardware - All paddle handles, latches, rods and springs shall be lubricated prior to delivery.   | 1   |          |
| 03-06-2201                               |   | RR , Magnetic Entry Door Switches (STANDARD)  | 1   | 3.6.22.0 |
| 03-06-2202                               |   | RR, Door Panel Mounting Screws (STANDARD)   | 1   |          |
| 03-06-4200                               |   | RR, Coil Cords for Electrical Circuits (STANDARD)   | 1   |          |
| 03-06-6065                               |   | RR, Power Door Locks, Module Entry Doors,w/Hidden Switch<br><b>Install power door locks in side and rear entrance doors. Includes (2) lock/unlock switches, one at side door and one at rear door. Also includes (1) hidden switch in FRONT GRILLE for unlock function only. System will be tied to OEM chassis power locks, both systems to operate independently. Does not include wireless remote.<br/><br/>hidden switch to be located in the front GRILLE on the passenger's side.</b> | 1   | 3.6.66.0 |
| 03-06-6107                               |   | RR, Bracket to Move Stealth Switch from Standard Location<br><b>Relocate the Stealth switch to OEM grille area - curb side<br/><br/>See CA Drawings.</b>  | 1   | 3.6.61.7 |

| PART NO    | S | DESCRIPTION   | QTY | REF. NO   |
|------------|---|---|-----|-----------|
| 03-06-8010 |   | RR, Inner Door Panel - Stainless Steel , Two Piece (STANDARD)   | 1   | 3.6.15.0  |
| 03-06-8011 |   | RR, Lock Boxes, White Diamond Grade   | 1   | 3.6.40.1  |
|            |   | <b>SIDE DOOR STEP</b>   |     |           |
| 03-08-2000 |   | RR, Dual Side Entry Step Well, Increased Depth, Lower Grip, Upper Diamond Plate<br><br>Increase the depth of stepwell inboard as far as sub structure permits. Side surfaces to be Diamond Plate. Step surface to be a combination of NFPA Diamond Plate and removable 9" Grip Strut insert. The Diamond Plate section of the floor to be supported with rigid foam floor insulation in the same manner as the module floor. The lower step with grip strut will include a drain hole with plug.<br>The second step to be fabricated of NFPA Diamond Plate and installed so that the step surface is midway between the stepwell floor surface and the module floor surface making two equal steps into the vehicle.  | 1   | 3.8.20.0  |
| 03-08-3010 |   | RR, Light, Side Entry Step well, LED, Whelen OS Mini, Clear   | 1   | 3.8.5.0   |
|            |   | <b>WINDOWS</b>  |     |           |
| 03-09-0030 |   | RR, Module Window Requirements  | 1   |           |
|            |   | <b>WINDOW- Side Entry Door</b>  |     |           |
| 03-09-1110 |   | RR, Window, Side Entry Door, 18X18, Slider - Standard Glass   | 1   | 3.9.11.1  |
|            |   | <b>WINDOW - Rear Entry Doors</b>  |     |           |
| 03-09-1210 |   | RR, Window, Rear Entry Doors, (2) 18 x 24, Fixed, Standard Glass  | 1   | 3.9.12.1  |
|            |   | <b>MODULE TO CHASSIS MOUNTING SYSTEM</b>  |     |           |
| 03-10-1100 |   | RR, Module to chassis mounting system, Type 1 Ford Long WB  | 1   | 3.10.5000 |
| 03-11-2000 |   | RR, Bellows, Connecting, Type I   | 1   |           |
|            |   | <b>REAR BUMPER AND REAR STEP CONSTRUCTION</b>   |     |           |
| 03-12-1800 |   | RR, Rear Bumper, Recessed 9" Pocket, Flip-up  | 1   | 3.12.18.0 |
| 03-12-3020 |   | RR, Bumper Pods, CPI Cast Aluminum w/RR Logo. (UM & UM-150)<br>Cast Products Bumper Pods, High Polish Finish. Mounted on the outboard rear step bumper frame members. The CPI cast aluminum pod shall include a RR Logo embossed in the cast pattern on the step tread.   | 1   | 3.12.30.0 |
| 03-12-5600 |   | RR, Tow Eyes, Rear Chrome with 6" x 6"x 6" Deep Box<br>Mounted to Steel Reinforcement Plate bolted to the OEM Chassis Frame Rails. Tow Eyes to be Recessed In Rear Kick Panel in cast aluminum box's that are 6" x 6" x 6" deep. (Ultramedic, Promedic Only)  | 1   | 3.12.56.0 |
|            |   | <b>INSULATION</b>   |     |           |
| 03-13-2220 |   | RR, Whisper Quiet, Sound Dampening/Thermal Insulation Package (UM)<br><br>Whisper Quiet - Sound Dampening/Thermal Insulation Package. (ULTRAMEDIC AND PROMEDIC)   | 1   | 3.13.22.0 |
|            |   | <b>ELECTROLYSIS PREVENTION</b>  |     |           |
| 03-14-4000 |   | RR, Electrolysis Prevention, Fluid Film<br>Fluid Film is used at Every Point Where the Mounting Process has the Propensity to Break Paint (STANDARD)  | 1   |           |
|            |   | <b>COMBINATION RUB RAIL AND FENDER RING</b>   |     |           |
| 03-15-2000 |   | RR, Rub Rail, Skirt Line and Fender Ring<br><br>Extruded Black Rubber Rub Rail and Fender Ring - The lower body Rub Rail and Fender Ring to made of Black extruded rubber. The aluminum extrusion that the rubber rub rail and fender rings sets into for added strength will stand off of the exterior body with nylon spacer for ease of cleaning between the rub rail and the exterior body. The rub rail and fender ring assembly will then be through bolted to the lower body. The lower body rub rails will transition to the fender ring and will have polished aluminum corner caps. At each end of the rub rails there will be a polish aluminum end caps. The rubber rub rail extrusion to accept multiple selections of reflective vinyl color inserts. | 1   | 3.15.20.0 |

| PART NO                                  | S | DESCRIPTION   | QTY | REF. NO    |
|--|---|---|-----|------------|
| 03-15-5110                               |   | RR, White Scotchlite Insert for Rubber Rail   | 1   | 3.15.51.1  |
| <b>SPLASH GUARDS AND RUNNING BOARDS</b>  |   |   |     |            |
| 03-16-1521                               |   | RR, Running Boards, Diamond Plate, Type I , Ford 2017+  | 1   | 3.16.15.21 |
| 03-16-1800                               |   | RR, Mud Flaps, Rear, Black w/ Road Rescue Logo  | 1   | 3.16.18.0  |
|  |   | Heavy Duty Rubber Mud Flaps w/ RR Logo<br>- Heavy Duty Rubber Mud Flaps to be bolted to the wheel liner behind the rear duals with 1/4" x 20 Stainless Steel bolts, washer and nylon locknut for ease of maintenance and repair<br>(STANDARD)   |     |            |
| <b>DRIP RAILS</b>                        |   |   |     |            |
| 03-17-1000                               |   | RR, Drip Rails<br>Polished Aluminum Drip Rails - Above All Doors, Entry and Compartment (Standard)  | 1   |            |
| 03-18-1000                               |   | RR, Wheel well liners<br>Aluminum Wheelwell Liners - Extending to Bottom of Skirt (Standard)  | 1   |            |
| <b>CAB TO MODULE ACCESS</b>              |   |   |     |            |
| 03-19-1100                               |   | RR, Pass Thru Window, Type 1 Ford,GM or Dodge<br>Includes a Lexan sliding window in the module. The window shall have a positive latch on the cab side.   | 1   | 3.19.49.0  |
| 03-19-1113                               |   | RR, Pass Thru Opening, Type I   | 1   | 3.19.11.0  |
| <b>LICENSE PLATE HOLDER</b>              |   |   |     |            |
| 03-20-0550                               |   | RR, Rear License Holder Location, Center Recessed in Bumper Pocket  | 1   | 3.20.5.5   |
| <b>EXTERIOR COMPARTMENT CONSTRUCTION</b> |   |   |     |            |
| 04-01-0100                               |   | RR, Exterior Compartment Construction, Heavy Duty   | 1   |            |
| 04-01-3000                               |   | RR, Door Sill Protection, Stainless Steel.<br>Door Sill Protection - Install Stainless Steel sill protector on lower edge of all door frames to prevent paint damage. (STANDARD)  | 1   |            |
| <b>EXTERIOR COMPARTMENT DOORS</b>        |   |   |     |            |
| 04-02-0100                               |   | RR, Compartment Door, Hidden Hinge, Seal on Door (UM)   | 1   | 4.2.100    |
| 04-02-0715                               |   | RR, Compartment Handles, Exterior, TriMark Logo Chrome/Black (UM)<br>TriMark Two-Point Cast w/Polished Chrome Paddle Handle and Housing, Locking and Non-Locking, with floating cam - Mounted in CNC Cut Opening in Each Compartment Door Skin w/OEM Clamp Assembly.<br>(STANDARD ULTRAMEDIC) | 1   |            |
| 04-02-0741                               |   | RR, Compartment Handle, TriMark Logo Chrome/Black, Paddle, Street side, locking<br>For single doors or Leading doors Compartments #1, #2, and #4.   | 3   | 4.2.7.41   |
| 04-02-0746                               |   | RR, Compartment Handle, TriMark Logo Chrome/Black, Paddle, Street side, Non-Lock<br>For Trailing doors on the street side. Compartments #2 or #4.   | 1   | 4.2.7.46   |
| 04-02-0751                               |   | RR, Compartment Handle, TriMark Logo Chrome/Black, Paddle, Curbside, locking<br>For single doors or Leading doors on the curbside Compartments #6, #6.5, #8   | 2   | 4.2.7.51   |
| 04-02-0758                               |   | RR, Compartment Handle, TriMark Logo Chrome/Black ,Drop Door or Drawer, Locking<br>For Drop down doors or drawers on either side of unit.<br>Compartments #3 & #8.5   | 2   | 4.2.7.58   |
| 04-02-0850                               |   | RR, Compartment Door Locks, 2015 TriMark<br>Compartment Door Handle Manual Locks. - All doors shall incorporate   | 1   |            |



| PART NO    | S | DESCRIPTION   | QTY | REF. NO  |
|------------|---|---|-----|----------|
|            |   | double cut, non-directional tumbler assemblies that are keyed alike (STANDARD)  |     |          |
| 04-02-0900 |   | RR, Compartment Rotary Latches  | 1   |          |
| 04-02-1000 |   | RR, Compartment Door Nader Pin  | 1   |          |
| 04-02-1200 |   | RR, Compartment Door Lubrication, Door Handles and Latches  | 1   |          |
| 04-02-1300 |   | RR, Compartment Door Reflectors   | 1   | 4.2.13.0 |
|            |   | All exterior compartment doors shall have a red reflector mechanically attached to the lower outboard corner of the door.   |     |          |
| 04-02-1500 |   | RR, Compartment Door Switches, Magnetic   | 1   | 4.2.15.0 |
| 04-02-2010 |   | RR, Compartment Door Panel, Inner, Diamond Plate  | 1   | 4.2.20.1 |
| 04-02-2500 |   | RR, Compartment Door, Panel Mounting Screws   | 1   |          |
| 04-02-5999 |   | RR, Power Door Locks, Exterior Compartments   | 1   |          |
| 04-02-6010 |   | RR, Exterior Compartment #'s 1, 2, 4, 6 & 8, Only   | 1   | 4.2.61.0 |
| 04-02-6040 |   | RR, Add Power Door Lock to #3 Comp.   | 1   | 4.2.64.0 |
| 04-02-6050 |   | RR, Add Power Door Lock to #6.5 Comp.   | 1   | 4.2.65.0 |
| 04-02-7801 |   | RR, Compartment Door, Gas Struts  | 1   |          |
| 04-03-2300 |   | RR, Compartment Lights, Exterior, Additional Flexible LED Strip (Per Comp)  | 1   | 4.3.23.1 |
|            |   | Additionally #3   |     |          |
| 04-03-2400 |   | RR, All Standard Compartment Lights, LED, Flexible Strip  | 1   | 4.3.24.0 |
|            |   | Two (2) Vertical strips in each exterior compartment installed, one (1) on each side of the opening. The compartment #1 lights will be also wired to Oxygen light switch in action area.  |     |          |
|            |   | <b>EXTERIOR COMPARTMENT INTERIOR</b>  |     |          |
| 04-04-1000 |   | RR, Exterior Compartment, Interior Finish, Polyurethane Coated  | 1   |          |
|            |   | Exterior Compartment Interior Polyurethane Rubberized Liner Color Choice.   |     |          |
|            |   | Rubberized polyurethane coating applied to the surfaces of ALL exterior compartment walls and dividers. Does not include slide out battery tray or mounting angles. Battery Tray to be raw aluminum.  |     |          |
|            |   | NOTE: If there is not a slide out battery compartment in the order the #3.5 exterior compartment area will be Polyurethane lined.   |     |          |
| 04-04-1002 |   | RR, Color, Light Gray   | 1   | 4.4.10.2 |
| 04-04-2000 |   | RR, Exterior Compartment, Floor Matting "Turtle Tile"   | 1   | 4.4.20.0 |
|            |   | Compartments  |     |          |
|            |   | #1  |     |          |
|            |   | #2  |     |          |
|            |   | #3  |     |          |
|            |   | #4  |     |          |
|            |   | #6  |     |          |
|            |   | #6.5  |     |          |
|            |   | #8  |     |          |
| 04-04-2001 |   | RR, Color, Black  | 1   | 4.4.20.1 |
|            |   | <b>EXTERIOR COMPARTMENT SHELVING</b>  |     |          |
| 04-05-0001 |   | RR, Exterior Compartment Shelving and Unistrut  | 1   |          |
|            |   | All exterior shelving Unistrut shall be welded to the walls prior to any compartment wall finish. Where specified, exterior adjustable shelves shall be box pan formed of a minimum .125 inch Aluminum Diamond Plate and corners shall be welded. Shelves shall be infinitely adjustable, and securely mounted to heavy gauge aluminum Unistrut track. (Standard) |     |          |
| 04-05-1000 |   | RR, Compartment Shelving, Diamond Plate   | 1   |          |
|            |   | Diamond Plate Exterior Compartment Shelving. (STANDARD)   |     |          |

| PART NO  | S | DESCRIPTION  | QTY | REF. NO    |
|--|---|--|-----|------------|
| <b>COMPARTMENT #1 - STREETSIDE FWD</b>           |   |  |     |            |
| 04-06-0001                                       |   | RR, Compartment #1, EXTERIOR   | 1   |            |
| 04-06-0010                                       |   | RR, Compartment #1, Electrical Storage<br>#1 Compartment Electrical Storage - Recessed into the bulkhead side of compartment #1 shall be an enclosed area for the installation of miscellaneous electrical components. The aluminum cover for this area to be installed with 'J' molding The 'J' molding to be full length of panel on bottom and inboard side. Outboard side of panel to be secured with mechanical fasteners. (STANDARD) | 1   | 4.6.11.0   |
| 04-06-0020                                       |   | RR, Compartment #1, Full Height, Standard Configuration (UM)   | 1   | 4.6.12.0   |
| 04-06-1505                                       |   | RR, Compartment #1, Shelf, Fixed<br>L Shelf located above O2.<br><br>See CA Drawings.  | 1   | 4.6.155.0  |
| <b>COMPARTMENT #2 - STREETSIDE FWD WHEELWELL</b> |   |  |     |            |
| 04-07-0010                                       |   | RR, Compartment #2, EXTERIOR   | 1   |            |
| 04-07-0600                                       |   | RR, Compartment #2, Standard Configuration, (UM)<br>#2 Compartment to be directly behind the #1 compartment and below the interior action area shelf on the street side of the module. (STANDARD Ultramedic)   | 1   | 4.7.6.0    |
| 04-07-2610                                       |   | RR, Compartment #2, Shelf Adjustable, First Shelf<br>Standard (Ultramedic).  | 1   | 4.7.261.1  |
| <b>COMPARTMENT #3 - STREETSIDE WHEELWELL</b>     |   |  |     |            |
| 04-08-1000                                       |   | RR, Compartment #3, EXTERIOR   | 1   |            |
| 04-08-3320                                       |   | RR, Compartment #3, Drawer, 8.5"H x AWAP, Raise CPR Seat<br>#3 Compartment shall be directly over the wheel well on the street side of the module. The compartment door shall be attached to a slide out tray mounted with two slides.   | 1   | 4.8.332.0  |
| <b>COMPARTMENT #4 - STREETSIDE AFT</b>           |   |  |     |            |
| 04-09-0001                                       |   | RR, Compartment #4, EXTERIOR   | 1   |            |
| 04-09-3000                                       |   | RR, Compartment #4, 3/4 Height, Standard Configuration<br>Full Height #4 Compartment streetside rear of module with Interior Upper left #4 Cabinet - #4 Compartment to be full height to bottom of upper left #4 cabinet.  | 1   | 4.9.30.0   |
| 04-09-4505                                       |   | RR, Compartment #4, Shelf Adjustable, First Shelf<br>Approximately evenly spaced in the compartment with the other shelf.<br><br>See CA Drawings.  | 1   | 4.9.451.1  |
| 04-09-4520                                       |   | RR, Compartment #4, Shelf Adjustable, Additional, Each<br>Approximately evenly spaced in the compartment with the other shelf.<br><br>See CA Drawings.   | 1   | 4.9.452.0  |
| <b>COMPARTMENT #6 - CURBSIDE AFT</b>             |   |  |     |            |
| 04-11-0084                                       |   | RR, Compartment #6, EXTERIOR   | 1   |            |
| 04-11-0600                                       |   | RR, Compartment #6, Standard Configuration (UM)  | 1   | 4.11.6.0   |
| 04-11-2060                                       |   | RR, Compartment #6, Divider, Fixed (UM)<br>Installed centered in the compartment.  | 1   | 4.11.456.0 |
| 04-11-4510                                       |   | RR, Compartment #6, Shelf Adjustable, First shelf<br>(1) Located from the divider to wall #3 at the bottom of the INT/EXT access.  | 1   | 4.11.451.0 |

| PART NO    | S | DESCRIPTION   | QTY | REF. NO    |
|------------|---|---|-----|------------|
|            |   | See CA Drawings.  |     |            |
| 04-11-4520 |   | RR, Compartment #6, Shelf Adjustable, Additional, Each<br>(2) Approximately equally spaced from the bottom shelf to the top of the compartment from the divider to wall #3 in the INT/EXT access.<br><br>See CA Drawings.   | 2   | 4.11.452.0 |
| 04-11-4625 |   | RR, Compartment #6, Safety Bar across for Backboards<br>68" from floor height, Wall #1 to fixed divider<br>polyurethane coated to match compartment.  | 1   | 4.11.4625  |
| 04-11-4631 |   | RR, Compartment #6, Equipment Strap, Quick Release, Plastic Buckle, Each<br>(1) equipment restraint strap with Plastic quick release buckle<br><br>Location: Installed approximately mid height from wall #1 to the divider.<br><br>See CA Drawings.  | 1   | 4.11.463.0 |
| 04-14-1425 |   | <b>RR, Compartment #8, EXTERIOR</b><br>RR, Compartment #8, Reduced Height Door<br>Exterior compartment #8 shall be the forward most compartment on the curbside of the module allowing interior / exterior access to the interior ALS cabinet. This compartment shall be per the size and configuration shown in the CA Drawings. | 1   | 4.14.15.0  |
| 04-15-0400 |   | <b>RR, Compartment #8.5, EXTERIOR</b><br>RR, Compartment #8.5, Drawer Style Battery Box Configuration<br>Battery access door mounted slide out battery tray. The interior of the battery compartment to be made of POLYURETHANE COATED ALUMINUM. Battery Tray to be raw aluminum.   | 1   | 4.15.4.0   |
|            |   | <b>INTERIOR TRIM AND FEATURES</b><br>New Interior Trim - All cabinet and wall panel aluminum trim to be Gray anodized. (No Black trim to be used). All protective corner trim will be Opaque and will include a matching domed end cap. (STANDARD)  |     |            |
|            |   | <b>INTERIOR ADJUSTABLE SHELVES</b>  |     |            |
|            |   | <b>INTERIOR TRIM</b>  |     |            |
| 05-05-1000 |   | RR, Interior Trim, Standard   | 1   |            |
|            |   | <b>HEADLINER</b>  |     |            |
| 05-06-1100 |   | RR-Ceiling Medical Device Rail (UM & UM-150)  | 1   | 5.6.11.0   |
| 05-06-1210 |   | RR, Headliner, Vinyl Ceiling, No Seams (UM & UM-150)  | 1   | 5.6.12.0   |
| 05-06-1802 |   | RR, Ceiling Medical Device Rail. White LED Strip Lights,(UM & UM-150)   | 1   | 5.6.18.0   |
| 05-06-1902 |   | RR, Ceiling Medical Device Rail, Red/Amber LED Turn/Brake Strip Lights (UM & UM-  | 1   | 5.6.19.0   |
|            |   | <b>FLOORING</b>   |     |            |
| 05-07-1000 |   | RR, Flooring, Aluminum Floor/Wall Cove Molding (STANDARD)   | 1   | 5.7.5.0    |
| 05-07-1400 |   | RR, Flooring, Stainless Steel Rear Threshold, 45 Degree Chamfered (STANDARD)  | 1   | 5.7.14.0   |
| 05-07-3000 |   | RR, Flooring - Lonplate II Choice   | 1   |            |
| 05-07-3002 |   | RR, Color - 421 Mica  | 1   | 5.7.30.2   |
| 05-07-9895 |   | RR, Floor, Curbside Stainless Steel Threshold, 4"wide,Safety Walk Anti-Skid Tap   | 1   | 5.7.61.0   |
|            |   | <b>HEAD BUMPERS</b>   |     |            |
|            |   | <b>BACKRESTS</b>  |     |            |
|            |   | <b>Rear Entry Door Grab Handles</b>   |     |            |
| 05-10-1301 |   | RR, Rear Entry Door Grab Handles, "L" Bars, 16" Anti-Microbial "L" Bars - 16" Anti-Microbial. 1.25" Diameter stainless steel "L" Bars   | 1   | 5.10.13.1  |

| PART NO    | S | DESCRIPTION  | QTY | REF. NO    |
|------------|---|--|-----|------------|
|            |   | mounted to each rear door. Approximately 16" wide by 26" high. Clear Anti-Microbial finish.  |     |            |
|            |   | <b>Side Entry Door Grab Handle</b>   |     |            |
| 05-10-1401 |   | RR, Side Entry Door Grab Handle, "L" Bar - 19" Anti-Microbial "L" Bar - 19" Anti-Microbial. 1.25" Diameter stainless steel "L" Bars mounted to side entry door. Approximately 19" wide by 24" high. Clear Anti-Microbial finish.   | 1   | 5.10.14.1  |
|            |   | <b>Ceiling Grab Rail - Center</b>  |     |            |
| 05-10-1903 |   | RR, Ceiling Grab Rail, Center 108" Anti-Microbial  | 1   | 5.10.19.3  |
| 05-10-2201 | S | RR, Ceiling Grab Rail, Curbside over CPR Seat 72" Anti-Microbial   | 1   | 5.10.22.1  |
| 05-10-2217 |   | RR, Grab Rail, Vinyl Padding, Overhead, Over Cot   | 2   | 5.10.85.0  |
|            |   | <b>IV FLUID HANGERS</b>  |     |            |
| 05-11-4000 |   | RR, IV Hangers, CPI #IV2008 (STANDARD)   | 1   |            |
| 05-11-4002 |   | RR, IV Hangers, Quantity (2)<br><i>See CA Drawings.</i>  | 1   | 5.11.40.2  |
|            |   | <b>LEFT STACK AND BULKHEAD AREA #1</b>   |     |            |
| 05-12-0010 |   | RR, Interior Street side #1 - Left Stack and Bulkhead  | 1   |            |
| 05-12-0200 |   | RR, Upper Bulkhead Cabinet, Double Doors<br><i>Upper Bulkhead Electrical Cabinet, Double Doors</i><br><i>- Install double hinged Kydex Thermoplastic or multi-spec (picked in the proper section of work order) doors with locking latch on the right hand door and center mullion on the left hand door on the standard upper bulkhead electrical cabinet.</i><br><i>(STANDARD)</i>                                 | 1   | 5.12.20.0  |
| 05-12-02SR | U | Left Stack Venting<br><i>SR#2023361F</i><br><br><i>(2) Fans on the left stack located per mechanical engineering design. The 12V fans to the left stack radio/inverter cabinet to help move heat generated by inverters and chargers. The fan on the door shall operate as intake and the other fan shall be exhaust. Cover the fans with louvers.</i><br><br><i>Fans shall be wired ignition and shoreline hot.</i> | 2   | 10156335   |
| 05-12-1610 |   | RR, Left Stack, Storage Area #1, 45 Deg Angled, CN 10 Certified<br><i>A two section vertical cabinet shall be provided behind the attendant seat on the street side forward corner on a 45 degree bevel that includes the access doors to the cabinet. The lower cabinet door shall be aluminum with plastic laminate and the upper cabinet shall be a Single One Hand Operation hinged Polycarbonate door.</i>      | 1   | 5.12.1610  |
| 05-12-1640 |   | RR, Bulkhead Cabinet, Lower (2) Rear Facing Doors<br>The patient compartment shall include a lower bulkhead cabinet located between the existing vertical left storage/radio cabinet and the ALS cabinet. The cabinet shall include (2) hinged aluminum and Kydex Thermoplastic or multi-spec doors with locking latch, (1) adjustable shelf, and a solid surface countertop with retaining lip.                     | 1   | 5.12.164.0 |
| 05-12-1810 |   | RR, Shelf Adjustable, Left Stack, First Shelf<br><i>For C1.</i>  | 1   | 5.12.181.0 |
|            |   | <b>ACTION WALL AREA #2</b>   |     |            |
| 05-13-0010 |   | RR - INTERIOR STREETSIDE #2 - ACTION AREA  | 1   |            |
| 05-13-0700 |   | RR, Action Wall Area #2, Medical Device Rail   | 1   | 5.13.7.0   |
| 05-13-0802 |   | RR, Cabinets, Upper Left U2 and U2.5, Std Configuration (UM), CN 10 Certified<br><i>- (2) Cabinets over Action Area with sliding doors and restocking feature.</i>   | 1   | 5.13.0802  |

| PART NO                                       | S | DESCRIPTION  | QTY | REF. NO     |
|---|---|--|-----|-------------|
|   |   | The forward UL #2 and the rearward UL #2.5 cabinets to include (1) adjustable shelf in each cabinet. The attendant switch panel and environmental controls to be built into a separate 6" high section below the Upper Left #2.5 cabinet and tilted slightly down for ease of accessibility to the attendant.. (STANDARD Ultramedic, Promedic) |     |             |
| 05-13-2200                                    | S | RR Countertop, Forward & Rear action area, bulkhead counter, c/s work station  | 1   |             |
| 05-13-2217                                    |   | RR, Avonite New Concrete, 7842   | 1   | 5.13.22.17  |
| <b>RR-Interior Street side #3 - CPR Seat</b>  |   |  |     |             |
| 05-14-05SR                                    | U | Streetside - CPR Seat, Fixed Lid Configuration<br>SR#2023361F  | 1   | 10480094    |
|   |   | - The CPR seat shall include a fixed seat. The CPR seat shall include a 2" foam seat and backrest, the upper and lower sections will be padded on both sides for added protection.   |     |             |
|   |   | NOTE: The CPR seat will have a fixed lid.  |     |             |
| 05-14-2560                                    |   | RR, CPR Seat, Seat Belt, 4 Point (Per4Max) Black, Change Notice 8-Compliant<br>Above Lid mounted   | 1   | 5.14.102.31 |
| 05-14-4106                                    |   | RR, CPR Seat, RR Backrest and Head Cushion, RR Logo, (1) Set, Royal Blue   | 1   | 5.14.28.6   |
| <b>RR, INTERIOR STREETSIDE #4 - REAR AREA</b> |   |  |     |             |
| 05-15-1001                                    |   | RR, Cabinet, Upper Left U4, Standard Configuration- CN 10 Certified<br>Upper left U4 cabinet with sliding poly carbonate doors with spring loaded latching handles, restocking feature with spring loaded exterior integral latch and (1) adjustable shelf.  | 1   | 5.15.1020   |
| <b>SQUAD BENCH AREA</b>                       |   |  |     |             |
| 05-16-0010                                    |   | RR, INTERIOR CABINETS - SQUAD BENCH AREA   | 1   |             |
| 05-16-00SR                                    | U | Curbside Squad Bench - Two Piece Lid - (1) Hinged & (1) Fixed<br>SR#2023361F   | 1   | 10363163    |
|   |   | The rear squad bench lid will be fixed and the forward lid will be hinged.   |     |             |
|   |   | See CA drawings.   |     |             |
| 05-16-0146                                    |   | RR, Squad Bench, Curbside, One Piece Hinged Lid  | 1   | 5.16.50.1   |
| 05-16-0151                                    |   | RR, Squad Bench, Medical Device Rail   | 1   |             |
| 05-16-0153                                    |   | RR, Squad Bench, Latch, Lid, Tri Mark,   | 1   | 5.16.60.2   |
| 05-16-0158                                    |   | RR, Squad Bench, Seat Belts, Two 4-Point belts (Per4Max) Black, CN-8<br>Above the Lid Mounted  | 1   | 5.16.102.51 |
| 05-16-0176                                    |   | RR, Squad Bench, RR Backrest and Head Cushion, RR Logo, (1) Set, royal Blue  | 2   | 5.14.28.6   |
| 05-16-01SR                                    | U | Custom Cabinet - Head of Squad Bench<br>SR#2023361F  | 1   | 10551175    |
|   |   | Custom cabinet at head end of Squad Bench area with one drawer, opening towards the bench - Notched out under the drawer for access to the waste & sharps drawer (drawer picked separately in the order). This cabinet will have an avonite counter top, with no retaining lip.  |     |             |
|   |   | Drawer shall be 10" deep, and shall use 10" non locking slides. Face of the drawer to be finished with multispec or kydex (picked in the proper section of the order). Drawer shall use (1) round locking latch.   |     |             |

| PART NO  | S | DESCRIPTION   | QTY | REF. NO    |
|--|---|---|-----|------------|
| 05-16-8400                                     |   | RR, Upper Squad Bench, Cabinet, 9"H, 72" Headroom ONLY<br><b>There shall be a cabinet located above the squad bench. The cabinet will be approximately 9"H x 8-1/2"D and will be the same length as the squad bench. The cabinet shall be divided into two (2) separate sections by a fixed center divider. Each section will have 3/8" Lexan lift up doors with restocking feature and locking latches. Does not include shelves. The distance between the top of the squad bench cushion to the bottom of the cabinet cushion shall be a minimum of 43" in compliance with KKK-A-1822F requirements for head clearance.</b> | 1   | 5.16.84.0  |
| 05-16-9915                                     |   | KKK Compliancy Regarding Overhead Cabinetry<br>The inclusion of a cabinet over the squad bench or CPR seat on a unit with less than 72" headroom will result in the unit not meeting KKK specification requirements. The end user has been informed of the KKK requirements and this cabinet has been added at the request of, and according to the specifications of, the end user.  | 1   | CABINETRY  |
| <b>BIOHAZARD-<br/>RR, INTERIOR - BIOHAZARD</b> |   |   |     |            |
| 05-17-2000                                     |   | RR, Glove Butler(s)   | 1   |            |
| 05-17-2100                                     |   | RR, Glove Butler (3) Total, Over Curbside Entry, Drop down Door<br><b>(3) Glove Butler II glove boxes installed above the side module entrance door inside a cabinet with drop down door and (2) locking latches. Door to be Kydex Thermoplastic or multi-spec covered and bottom hinged to tip out for restocking. Access holes to be cut in door for glove removal.</b>   | 1   | 5.17.210.0 |
| 05-17-32SR                                     | U | RR, Access, Waste & Sharps, Through Top, Head of Squad Bench<br><b>SR#2023361F</b><br><br><b>Combination Waste and Sharps storage area at head of squad bench. Waste and Sharps to be removable through a lift up lid. Lid to have a locking latch. Includes 8 quart waste container and 1.7 8 quart top loading sharps container.</b><br><br><b>Sharps / Waste access setup in a drawer with 14" non locking slides, round southco locking latch, finish the face of the drawer with kydex thermoplastic or multispec (picked in the proper section of the order).</b>   | 1   | 10321568   |
| <b>CURBSIDE RIGHT STACK STORAGE #8</b>         |   |   |     |            |
| 05-18-0010                                     |   | RR, INTERIOR CURBSIDE - RIGHT STACK STORAGE #8  | 1   |            |
| 05-18-0600                                     |   | RR, RF ALS, Upper Heater, A/C Unit, Standard Configuration (UM & UM-150)  | 1   |            |
| 05-18-0810                                     |   | RR, RF ALS, Stainless Steel Vents for Air Intake  | 1   |            |
| 05-18-1010                                     |   | RR, RF ALS, "A" Style Standard, CN 10 Certified (UM & UM-150)   | 1   | 5.18.1010  |
| 05-18-51SR                                     | U | RR, U8, Drug Cabinet, 16" Dual Aluminum Doors, Interior Access<br><b>SR#2023361F</b><br><br><b>CABINET U8 - Below the top section area shall be a cabinet with a Kydex Thermoplastic or multi-spec covered , locking aluminum double doors that is hinged vertically the LH/RH. The height of the cabinet below the heat A/C shall be 16 in. high and will have (1) adjustable shelf. The RH door shall have (1) round locking latch, and the LH door shall have a center mullion.</b><br><br><b>See CA Drawings.</b>   | 1   |            |
| 05-18-5326                                     | S | RR, L8, Cabinet, ALS Gen II, OHO Polycarbonate Doors,(2) Adj Shelves, I/O CN10<br><b>CABINET L8 - The lower section of the right front ALS cabinet shall have interior and exterior access and shall contain (2) adjustable shelves. The double interior access doors shall be Gen II OHO polycarbonate double doors. The interior walls of this area to be lined with flooring material and</b>  | 1   |            |

| PART NO    | S | DESCRIPTION  | QTY | REF. NO    |
|------------|---|--|-----|------------|
|            |   | the floor of this section shall incorporate an angled stainless steel threshold designed to facilitate removal of equipment from the floor of the cabinet without catching on the lower frame edge.  |     |            |
|            |   | <b>ATTENDANT SEAT</b>  |     |            |
| 05-19-0500 |   | RR, Attendant's Seat, EVS 1880, Child safety, Comfort, Per4Max Belt-Black  | 1   |            |
| 05-19-0506 |   | RR, Color - Royal Blue   | 1   | 5.19.5.6   |
| 05-19-6501 |   | RR, Attendant's Seat Base, EVS Swivel 2 Pos  | 1   | 5.19.65.1  |
|            |   | <b>RR-INTERIOR COLORS</b>  |     |            |
| 05-20-2000 |   | RR, Multi-Spec Interior Surfaces   | 1   | 5.20.2000  |
| 05-20-2003 |   | RR, Color, Arctic Blue #99-604   | 1   | 5.4.12.3   |
| 05-20-5300 |   | RR, Upper Band Vinyl Color, Cabinets and Stitched Cushions<br>Upper Band Vinyl Color Choice for cabinets and stitched cushions.  | 1   |            |
| 05-20-5336 |   | RR, Color, Royal Blue  | 1   | 5.20.53.36 |
| 05-20-5500 |   | RR, Lower Band Vinyl Color, Vacuum Formed Cushions   | 1   |            |
| 05-20-5536 |   | RR, Color, Royal Blue  | 1   | 5.20.55.36 |
| 05-20-9850 |   | RR, Poly carbonate Color Choice  | 1   |            |
| 05-20-9851 |   | RR, Poly carbonate, Gray<br>1/4" poly carbonate  | 1   | 5.20.9851  |
|            |   | <b>RR-MISC. INTERIOR OPTIONS</b>   |     |            |
| 05-21-2520 |   | RR, Security Lock (1) RCI Electric Lock w/ Remote Keypad ,For Hinged Door<br><b>Locking top section of ALS Cabinet</b><br><br><b>Keypad located near the U8 cabinet as shown on the CA Drawings.</b>   | 1   | 5.21.252.0 |
| 05-21-5002 |   | RR, Squad Bench & Lower Left, 11 Inch Brushed Stainless Kick panels<br><b>There shall be a stainless steel kick panel on the face of the streetside lower left wall and curbside squad bench. The kick panel shall be approximately 11 inches high and shall run the full length of the squad bench and lower left wall.</b>   | 1   | 5.21.51.0  |
| 05-21-7050 |   | RR, Interior Access, #6 Compartment, w/ Hinged Poly carbonate Door, CN 10 Certif<br><b>The patient compartment shall include a inside/outside access to the #6 compartment. The access opening will include an Gen II OHO Polycarbonate door with an integral latch. The access will be installed at the forward portion of the #6 compartment, and facing the aisle. The door will extend from the highest possible/practical point of the compartment down to the level of the squad bench lids and will be full width from compartment wall to divider. Exterior shelf retaining lip to be aligned with door opening.</b> | 1   | 5.21.7050  |
| 05-21-8500 |   | RR, Cabinet Latch, Southco 2" Round, Stainless Locking, CN 10-Rated 10lb   | 17  | 5.21.85.0  |
| 06-01-0100 |   | RR, General Wiring, General Harness  | 1   |            |
|            |   | <b>CAMERAS</b>   |     |            |
| 06-06-1016 |   | RR, Camera - WHT Ext B/U, ZORG over Rear Doors for Ford F-series<br>Install one (1)Zorg white IR color camera. Exterior mounted and connected to vehicle's OEM display.  | 1   | 6.6.1016   |
|            |   | <b>RR-COMMUNICATION</b>  |     |            |
| 06-06-1601 |   | RR, Two Way Radio Routing Path Cab to Module (STANDARD)  | 1   |            |
| 06-06-1700 |   | RR, Two Way Radio Pre wire, 12VDC Power & Ground (STANDARD)<br><b>#8 gauge Red power and Black ground wiring will be labeled appropriately for future installation by a radio technician. The Black ground wire to be connected to a main ground point, the Red power wire to be left unconnected near a direct to battery connection point inside the power distribution cabinet. Both wires to route to the lower section of the Left</b>  | 1   | 6.6.17.0   |

| PART NO    | S | DESCRIPTION  | QTY | REF. NO   |
|------------|---|--|-----|-----------|
|            |   | Stack/Radio Cabinet and be of sufficient length to allow routing to the Cab Console as an alternate radio installation location. Wires to be labeled at both ends.   |     |           |
| 06-06-3002 |   | RR, Antenna UHF/VHF, (2) Bases and Cables<br>#1 Antenna base location: Port 1<br>Coax termination: L1 Cabinet<br><br>#2 Antenna base location: Port 2<br>Coax termination: L1 Cabinet  | 1   | 6.6.30.2  |
| 06-06-6000 |   | RR, Radio Power, (1) 8 Gauge 12VDC Power/Ground<br>The vehicle shall be equipped with (1) additional #8 gauge power and ground wire pair. The Black ground wire to be connected to a main ground point, the Red power wire to be left unconnected near a direct to battery connection point inside the power distribution cabinet. Both wires to route to the Cab Console.<br><br>Wires to be labeled at both ends | 1   | 6.6.60.0  |
|            |   | <b>RADIO AND CLOCKS</b>  |     |           |
| 06-07-6500 |   | RR, Clock, Digital Lacrosse Atomic, 12/24 Hour, Over Rear Doors  | 1   | 6.7.65.0  |
|            |   | <b>07 - ELECTRICAL 12 VOLT DC</b>  |     |           |
| 07-00-0121 |   | RR, Electrical System 12V, PC System, Type 1   | 1   |           |
| 07-01-0010 |   | RR, Crct Pwr Accs.,Ign/Shrline,1-20 amp 12VDC to 2 locs,W/O,PD9130 chrgr<br>(1) 10 amp lead shall be coiled up behind the A./A panel for future use.<br>(1) 10 amp lead shall be coiled up behind the drivers seat in the cab, for future use.<br>Note: This code will be used when and additional battery charger has already been installed, the PD9130 will not be used with this option.                       | 1   | 7.01.0010 |
| 07-02-1000 |   | RR, Voltmeter - Standard   | 1   |           |
| 07-02-1100 |   | RR, Alarm,Low Voltage,With Buzzer and Indicator,in cab console   | 1   |           |
| 07-03-1000 |   | RR, Ammeter - for PC System  | 1   |           |
|            |   | <b>BATTERY SYSTEM</b>  |     |           |
| 07-04-5305 |   | RR, Ignition Battery Shut off Timer, 5 minute,   | 1   | 7.4.53.5  |
| 07-05-0400 |   | RR, Batteries, Type I UM/UM-150, Ford or Dodge Ram (2) OEM (1) Additional<br>The two OEM batteries under the hood. One 700 CCA AC Delco additional battery shall be supplied by the manufacturer and located in the exterior compartment located below the right front ALS cabinet.  | 1   | 7.5.4.0   |
| 07-07-0400 |   | RR, Module Disconnect, PC System   | 1   |           |
| 07-08-0100 |   | RR-Battery Ground  | 1   |           |
| 07-09-6100 |   | RR, Battery Charger Included with Inverter - See Inverter Picked.  | 1   |           |
| 07-10-1000 |   | RR, Power Outlets 12V, (2) Power Point Style, On with Ignition<br>(1) outlet shall be mounted in the action area medical rail.<br><br>(1) outlet shall be mounted above the top shelf in cabinet L8  | 1   | 7.10.10.0 |
| 07-10-5301 |   | RR, (1) Additional 12V Outlet, Direct to Battery<br>(1) Driver's Console driver's side forward next to siren.  | 1   | 7.10.53.1 |
| 07-10-7230 |   | RR, Power Outlet, Kusmaul, USB Dual Port, 5VDC, 4.8 Amp, 091-219-5<br>Located in the cab switch panel per Electrical Engineering ignition hot standard   | 1   | 7.10.7230 |



| PART NO    | S | DESCRIPTION  | QTY | REF. NO   |
|------------|---|--|-----|-----------|
|            |   | <b>FRONT CONSOLE</b>   |     |           |
| 08-01-1601 |   | RR, Console, Drivers Switch & Radio, PC System, CN11<br>Console shall be finished with black polyurethane coating.<br><br>Engineering notice - Console has Havis C-ARM-102 (picked separately in the order). Console must be reduced in width to accommodate arm rests                           | 1   | 8.1.16.0  |
| 08-01-4200 |   | RR, Cup Holder, (2) Position Aluminum in the Cab, (Cups No Handles)<br>Black plastic cup holders to be forward of the map box storage.   | 1   | 8.1.42.0  |
| 08-01-6050 |   | RR, Armrest, (1) Side mount, Havis C-ARM-102<br>Installed on each side of the cab console.   | 2   | 8.1.6050  |
| 08-01-6210 |   | RR, Clipboard/Map box, (3) Dividers<br>Rear of the cup holders shall be a clipboard and map box storage with binning strips and lexan adjustable dividers.   | 1   | 8.5.51.0  |
| 08-02-0500 |   | RR, Driver's Control Panel, Carbon Fiber Graphics w/Visual Display, Carling Rock<br>Includes Carling rocker switches   | 1   |           |
| 08-02-5510 |   | RR, Door Open Indicators (PC Electrical System)<br>Door Open Indicators - Magnetic Proximity Switches located at the top of the compartment door / jamb will activate a door open indicator on the driver's control panel and activate the corresponding Interior compartment light. (STANDARD). | 1   |           |
| 08-02-9100 |   | RR, Map Light, Federal LED "Littlite" Gooseneck Light, 12", Fixed Mounted<br>Mounted to the right side of the switch console there shall be a 12 inch Little Lite high intensity gooseneck light. It shall have switchable red and white LEDs and shall include a switch in the lamp base.       | 1   | 8.2.91.1  |
|            |   | <b>ATTENDANT CONTROL PANEL</b>   |     |           |
| 08-03-0500 |   | RR, Attendant's Control Panel, Carbon Fiber Graphics, Carling<br>Includes Carling rocker switches  | 1   |           |
| 08-04-3904 |   | RR, Power Distribution, PC Board Electrical System 2015+ (UM & UM-150)   | 1   | 8.4.39.4  |
|            |   | <b>09 - EMERGENCY Systems- Sirens, Speakers and Air Horns</b>  |     |           |
| 09-03-0020 |   | RR, Warning Audible - Siren, Speakers, Air Horns- F-Series<br><b>SIREN ELECTRONIC - CONTROL HEADS / AMPS</b>   | 1   |           |
| 09-03-1150 |   | RR, Siren Electronic, Whelen 295HFSA7, Remote Head, California Compliant   | 1   | 9.3.35.0  |
|            |   | <b>SIREN SPEAKERS</b>  |     |           |
| 09-03-2023 |   | RR, Speakers, (2) CPI "Though-The-Bumper" for 2023-F-Series w/Fog Lts.   | 1   | 9.3.3.23  |
|            |   | <b>AIR HORNS</b>   |     |           |
| 09-03-3090 |   | RR, Air Horns, Buell, 10" & 12", Thru Bumper, Tank & Comp, F-Series<br>NO Air horns thru center of Front bumper type 1 FORDS per ECN1820<br><br>Compressor on compt #2 ceiling in the upper left hand corner of the compartment- With expanded metal cover                                       | 1   | 9.3.110.4 |
| 09-03-6010 |   | RR, Air Horns, Control Switch, Momentary Switch ILO std foot switch  | 1   | 9.3.140.0 |
| 09-05-0210 |   | RR, Backup Alarm, No Cutoff  | 1   | 9.5.2.1   |
| 09-06-0200 |   | RR, Emergency Sequencer/Load Manager   | 1   |           |
|            |   | <b>FRONT WARNING LIGHT CONFIGURATION</b>   |     |           |
| 09-50-1333 |   | RR, Visual Warning Front Upper - (5) "Cool Bar" (2) Front Wall Configuration   | 1   |           |

| PART NO    | S | DESCRIPTION   | QTY | REF. NO    |
|------------|---|---|-----|------------|
| 09-70-5310 |   | <p style="text-align: center;"><b>AUXILLARY EMERGENCY LIGHTS</b></p> <p>RR, Lights, Rear Chevron, Angled, LED Strip Lights in extruded channel, Per CAs<br/>                     #KFA-RR-CRA-1. Includes Chevron flasher set, KFA-CIO-01<br/>                     Punch slots in the rear body panel to accommodate.<br/>                     LED colors will be combination Red/Amber.</p> <p>This feature is similar to the flashing rub rail lights. Requires special flasher with two separate left and right modules.</p> <p>The Top, middle, and Lower angled lights are to be solid RED LED's only when the OEM brakes are applied. This will override the emergency light function. This feature also applies when not in emergency mode.</p> <p>The (2) angled light above and below the center angled light are to be flash AMBER LED's only when the corresponding OEM turn signals are applied. This will override the emergency light function. This feature also applies when not in emergency mode.</p> <p>Red and Amber LED's are to be wired to master emergency lights and alternate Red then Amber.</p> <p>Chevron strip lights to be centered in reflective chevron stripes (if ordered).</p> | 1   | 9.70.53.10 |
| 09-80-2110 |   | <p>RR, Warning Light Flasher, Vanner 9860GCPE, PC System Only<br/>                     Vanner 9860GCPE Halogen/LED electronic flasher to power specified lights. Four flash Patterns avail.( Alternate flash, Triple burst, Quad burst, double burst.)</p> <p>Standard will be dual Burst Flash unless otherwise noted.</p>   | 1   | 9.80.19.0  |
| 09-95-1504 |   | <p style="text-align: center;"><b>WARNING LIGHTS</b><br/> <b>LED Series - M9 (Flange Included)</b></p> <p>RR, Whelen M9 LED, w/Chrome Flange LED - WHITE (Internal Flasher)</p> <p><b>FRONT UPPER BODY LIGHTING</b><br/>                     Front Body - Upper Curbside Outer<br/>                     Front Body - Upper Center<br/>                     Front Body - Upper Street side Outer</p> <p>Internally flashed -Comet flash 75- Pri Only</p>   | 3   | 9.95.1504  |
| 09-95-1505 |   | <p>RR, Whelen M9 LED, w/Chrome Flange - RED / Clear Lens (Internal Flasher)</p> <p>Front Body - Upper Curbside Inner<br/>                     Front Body - Upper Streetside Inner</p> <p>Internally flashed -Comet flash 75- Pri/Sec</p> <p>Front Body - Upper Curbside Corner<br/>                     Front Body - Upper Streetside Corner<br/>                     Streetside Body - Upper Forward<br/>                     Streetside Body - Upper Rear<br/>                     Curbside Body - Upper Forward<br/>                     Curbside Body - Upper Rear</p> <p>Internally flashed -Comet flash 75- Pri/Sec</p> <p>Rear Body - Upper Streetside Corner<br/>                     Rear Body - Upper Curbside<br/>                     Set to steady burn for brake override - flash thru 9860 Flasher- Pri/sec</p>  | 10  | 9.95.1505  |

| PART NO    | S | DESCRIPTION  | QTY | REF. NO      |
|------------|---|--|-----|--------------|
| 09-95-2405 |   | <p><b>LED Series - M7 (Flange included RR)</b><br/>                     RR, Light, Whelen M7 LED, w/Chrome Flange, Red, Clear Lens<br/>                     (Internal Flasher)<br/> <b>FRONT FENDER INTERSECTION LIGHTING</b><br/>                     Front Fender Warning - Intersectors - LH Side<br/>                     Front Fender Warning - Intersectors - RH Side</p> <p>Internally flashed -Comet flash 75- Pri only</p> <p><b>REAR WHEEL WELL INTERSECTION LIGHTING</b><br/>                     Rear wheel well Warning - Intersectors - LH Side<br/>                     Rear wheel well Warning - Intersectors - RH Side</p> <p>Internally flashed -Comet flash 75- Pri/Sec</p> | 4   | 9.95.2405    |
| 09-95-2407 |   | <p>RR, Light, Whelen M7 LED, w/Chrome Flange, Amber, Clear Lens<br/>                     (Internal Flasher)<br/> <b>MODULE REAR LIGHTING</b><br/>                     Rear Body - Upper Center</p> <p>Internally flashed -Comet flash 75- Pri/Sec</p>  | 1   | 9.95.2407    |
| 09-95-4712 |   | <p><b>WHELEN ION WARNING LIGHTS (Flange Included)</b><br/>                     RR, Light, Whelen, ION, WIONSMCR, Red, Clear lens, w/chrome flange<br/> <b>FRONT GRILLE LIGHTING</b><br/>                     Grille - LH Upper Corner<br/>                     Grille - RH Lower Corner</p> <p>Internally flashed -Comet flash 75 Phase 1 CS/ Phase 2 Streetside- Pri only</p> <p>See CA Drawings.</p>   | 2   | 9.95.4712    |
| 09-95-4716 |   | <p>RR, Light, Whelen, ION, WIONSMCC, Clear, W/chrome flange<br/> <b>FRONT GRILLE LIGHTING</b><br/>                     Grille - LH Lower Corner<br/>                     Grille - RH Upper Corner</p> <p>Internally flashed -Comet flash 75 Phase 1 Streetside/ Phase 2 CS- Pri only</p> <p>See CA Drawings.</p>   | 2   | 9.95.4716    |
| 09-95-9237 |   | <p><b>Whelen 700 Light head Flanges / Options</b><br/>                     RR, Housings, Cast, 15 degree angled, M7, Intersection, 2017+<br/>                     F-series, Pair</p>   | 1   | 9.95.9236.17 |
| 10-01-0002 |   | <p><b>EXTERIOR AUTOMOTIVE LIGHTING</b><br/>                     RR, Tail Lights, Brake/Turn, Whelen M62-Series LED, Pair</p>   | 1   | 10.1.32.2    |
| 10-01-0007 |   | <p>RR, Back-up Lights, Whelen M62BU, LED Rear, Pair</p>  | 1   | 10.1.66.2    |
| 10-01-2010 |   | <p><b>ICC/MARKER LIGHTS</b><br/>                     RR, Marker/Clearance Lights, Front, Whelen OS Mini LED, Amber</p>   | 1   | 9.4.9.1      |
| 10-01-2110 |   | <p>RR, Marker/Clearance Lights, Side and Rear, Whelen OS Mini LED,<br/>                     Red/Amber</p>  | 1   | 10.1.23.0    |
| 10-01-3002 |   | <p>RR, Chrome Flange, (1) Whelen M6</p>  | 6   | 10.1.42.0    |
| 10-01-5020 |   | <p>RR, Outboard Rear Flashers, Wired to OEM Brake Lights<br/>                     The outboard rear emergency flashers shall be wired to the OEM brake lights. These lights shall NOT function as brake lights when Emergency Flashers are on.</p>   | 1   |              |
| 10-01-7300 |   | <p>RR, Front Turn, Whelen M6-Series LED Amber Arrow w/Flange</p>   | 1   | 10.1.73.0    |

| PART NO                             | S | DESCRIPTION   | QTY | REF. NO   |
|-------------------------------------|---|---|-----|-----------|
| 10-01-8010                          |   | RR, Relocate Brake/Tail & Backup Lights to rear Diamond Plate, Amber Turns above  | 1   | 10.1.60.0 |
| <b>FLOOD AND LOAD SYSTEMS</b>       |   |   |     |           |
| 10-02-1020                          |   | RR, Scene Lighting, (4) Whelen M9 Series Super LED  | 1   | 10.2.45.0 |
| 10-02-2040                          |   | RR, Rear Load Lights, (2) Whelen M7 Series Super LED, Gradient Scene Light  | 1   | 10.2.52.0 |
| 10-02-3010                          |   | RR, Lighting Operation, Side Scene, Rear Load & Back-Up Lights<br>The electrical system shall be wired so that the rear module load lights and the lower back-up lights will operate when the rear doors are open, the switch on the front panel is activated, or when the vehicle is placed in reverse. With the module power switch "off", both the lower back-up lights and the upper load lights will operate when the vehicle is placed in reverse. The curbside scene lights will operate when the curbside door is opened.   | 1   |           |
| <b>Cab Entry - Lighting</b>         |   |   |     |           |
| <b>11 - INTERIOR LIGHTING</b>       |   |   |     |           |
| 11-01-1400                          |   | RR, Dome Lights - (11) Kinequip 8" Round LED<br>The interior lighting system shall consist of (11) Kinequip 8" Round LED Dome Lights fixtures in the following configuration:<br>(3) Cot lights In the medical device rail over the primary cot<br>(2) Bench lights over the squad bench<br>(3) Dome lights Street side<br>(1) Dome light Curbside over head of squad bench<br>(1) Dome light Curbside rear<br>(1) Dome Light over the walkway<br><br>The four outside corner lights and the (1) light over the CPR seat area and the (1) over the walkway shall be designated module dome lights and be activated when the side or rear module entrance doors are opened or by a three-way circuit allowing these lights to be turned on and off from cab or module. The lights over the primary cot and squad bench shall have switches in the module that will allow independent high/low/off control. | 1   | 11.1.40.0 |
| 11-01-9000                          |   | RR, Timer -15 minute- Restocking<br>The vehicle shall be equipped with a momentary switch that will activate a fifteen minute timer, wired direct to battery, to allow operation of the module dome lights while the vehicle is off. The momentary switch shall be located on the curbside wall near the side entrance door in the medical device rail.   | 1   |           |
| <b>SPOTLIGHTS / HANDHELD LIGHTS</b> |   |   |     |           |
| <b>ATTENDANT LIGHT</b>              |   |   |     |           |
| 11-03-1500                          |   | RR, Attendant Light - LED Strip Under UL2-2.5 Cabinets, Action Wall   | 1   | 11.3.8.1  |
| <b>SHORELINE INLET</b>              |   |   |     |           |
| 12-01-5400                          |   | RR, Shoreline Inlet, Kussmaul Super Auto-Eject, 20A Shore Inlet, 20 AMP, Auto Eject ILOS.<br>20 AMP/125VAC shoreline inlet in lieu of standard 15 amp. Includes mating female connector body for inlet and 20 amp GFI circuit breaker combo in lieu of standard 15 amp.<br>Install the breaker box installed behind the driver's seat.  | 1   | 12.1.54.0 |
| 12-01-6200                          |   | RR, Kussmaul, Eject,Cover,15 or 20A,White   | 1   | 12.1.62.0 |
| 12-01-9020                          |   | RR, GFI Box Location- Behind Driver's Seat  | 1   |           |
| 12-02-0200                          |   | RR, Outlets, Interior, 125V-15A (1) Action Wall, (1) Right Stack<br>(1) outlet shall be mounted on the action area medical rail<br><br>(1) outlet shall be mounted above the top shelf in cabinet L8  | 1   | 12.2.2.0  |
| 12-02-2050                          |   | RR, Outlets, Interior, Each, Additional, 125V-15A, Action Area Wall<br>Installed near the CPR side seat on the medical device rail.<br><br>See CA Drawings.   | 1   | 12.2.50.0 |

| PART NO                                     | S | DESCRIPTION  | QTY | REF. NO    |
|---|---|--|-----|------------|
| <b>BLOCKHEATERS</b>                         |   |  |     |            |
| 12-02-4001                                  |   | Block Heater - With OEM Plug<br>This option does not include a switch.<br>(STANDARD).  | 1   |            |
| <b>INVERTER - 125VAC</b>                    |   |  |     |            |
| 12-03-1110                                  |   | RR, Inverter Charger - Vanner LifeSine, with charger indicator on Console<br>Install the inverter in the interior L1 cabinet.  | 1   | 12.3.124.0 |
| <b>13 - ENVIRONMENTAL SYSTEMS</b>           |   |  |     |            |
| <b>ENVIRONMENTAL CLIMATE CONTROL SYSTEM</b> |   |  |     |            |
| 13-01-1200                                  |   | RR, HVAC - Central Air Flow Discharge (UM & UM-150)  | 1   |            |
| 13-01-2000                                  |   | RR, Climate Control - (UM & UM-150)  | 1   |            |
| 13-02-0100                                  |   | RR, Exhaust Fan - 100 CFM Standard Location  | 1   | 13.2.20.0  |
| <b>HVAC BASE SYSTEM - HOSELINE</b>          |   |  |     |            |
| 13-02-5602                                  |   | RR, HVAC Aux Front Wall Coolbar, Hoseline, Ford F-series PC Elec   | 1   | 13.2.56.2  |
| 13-02-5702                                  |   | RR, Cover, Cool Bar, (5) M9 Series lights<br><b>Drawing # 303347</b><br><b>(5) M9 series lights only.</b><br><b>Note: Will be painted same color as the mount location on box front.</b>   | 1   | 13.2.57.2  |
| 13-03-1000                                  |   | RR, Return Air System  | 1   |            |
| 13-03-2000                                  |   | RR, Return Air Central Plenum  | 1   |            |
| 13-03-3000                                  |   | RR, Heat/AC Cabinet  | 1   |            |
| <b>14 - MEDICAL SYSTEMS</b>                 |   |  |     |            |
| <b>COT MOUNTING PROVISIONS</b>              |   |  |     |            |
| 14-01-1010                                  |   | RR, Cot Mounting, Hardware   | 1   |            |
| 14-01-1110                                  |   | RR, Post & Wheel Cups, None  | 1   |            |
| 14-01-1210                                  |   | RR, Safety Hook, Ship Loose  | 1   |            |
| 14-01-1220                                  |   | RR, Safety Hook, Ferno with bolts, Shipped Loose.  | 1   | 14.1.12.1  |
| 14-01-1622                                  |   | RR, Stryker Power Load/ Performance Load, Floor Plates and Wiring for Future Ins<br>Additional floor structure for future installation of a Stryker #6390 Power-LOAD system or 9392 Performance Load.<br><br>Includes pre-wire which will terminate under the attendant's seat | 1   | 14.1.16.22 |
| 14-01-1926                                  |   | RR, Cut Floor and Install Cot Mount Floor plate, 6390-700-001A For Powerload or Performance Load Cot mounts.   | 1   | 14.1.3093  |
| 14-01-4028                                  |   | Center Mount   | 1   |            |
| <b>OXYGEN AND AIR SYSTEMS</b>               |   |  |     |            |
| 14-02-0050                                  |   | RR, O2 System, PC System   | 1   |            |
| 14-02-1000                                  |   | RR, O2 Cylinder Wrench   | 1   | 14.2.15.0  |
| 14-02-2000                                  |   | RR, O2 Cylinder Bracket - Zico #QR-MV  | 1   | 14.2.16.0  |
| 14-02-3000                                  |   | RR, O2 Control - Electric with Manual Bypass on Action Wall.   | 1   | 14.2.30.0  |
| 14-02-3160                                  |   | RR, O2 Regulator, Wall Mount with 24" braided hose extension (PC)  | 1   | 14.2.67.0  |
| 14-02-4000                                  |   | RR, O2 Outlets, Ohio Style, (2) Action Wall, (1) Squad Bench<br>(2) O2 outlets in Action area medical device rail<br><br>(1) O2 outlet CS Wall head of squad bench in medical device rail<br><br>*** NOTE ***<br>O2 outlets MUST be at least 12" from any 125V AC outlet.      | 1   | 14.2.31.0  |
| 14-02-4100                                  |   | RR, O2 Outlet, Relocate (1) Action Wall Outlet to Ceiling<br><b>See CA Drawings.</b>   | 1   | 14.2.43.0  |
| 14-02-6120                                  |   | RR, O2 Cylinder Holder, (2) FW-521 Universal, CN 10 Certified<br><b>Installed at the head of the squad bench.</b>  | 1   | 14.2.115.2 |

| PART NO  | S | DESCRIPTION  | QTY | REF. NO   |
|--|---|--|-----|-----------|
| <b>SUCTION SYSTEM</b>  |   |  |     |           |
| 14-03-1010   |   | RR, Suction System, SSCOR On-Board<br>Conforms to J3043 requirements   | 1   | 14.3.40.0 |
| <b>MISC MEDICAL</b>  |   |  |     |           |
| 14-04-1000   |   | RR, Fire Extinguisher, 5# ABC w/ Mounting Bracket<br>HD Amerex Bracket #861H with Amerex 5LB fire extinguisher. SHIPPED<br>LOOSE   | 1   | 14.4.2.0  |
| <b>15 - PAINT / DECALS AND NOMENCLATURE<br/>PAINT AND FINISH</b> |   |  |     |           |
| 15-00-0100   |   | RR, Road Rescue Paint Process  | 1   | 15.1.30.0 |
| 15-01-2000   |   | Module Paint, Single Color, OEM White  | 1   |           |
| <b>Ford white: FA91:YZ</b>                                       |   |  |     |           |
| 15-01-5000   |   | Cab Paint - Single Color, OEM White  | 1   |           |
| 15-02-3001   | S | RR, Fine Line Paint Edge   | 1   | 1251006   |
| <b>GRAPHICS AND LETTERING</b>                                    |   |  |     |           |
| 15-03-3900   |   | RR, Badge Logos  | 1   |           |
| 15-03-4000   |   | RR, Logos and Model Name   | 1   |           |
| 15-03-4001   |   | RR, Ultramedic - Black Logos   | 1   | 15.3.40.1 |
| 15-04-1000   |   | RR, Nomenclature Plaques. DIESEL.  | 1   | 15.4.1000 |
| 16-01-0200   |   | RR, Owner's Manual   | 1   | 16.1.2.0  |
| 74-09-0099   |   | Indemnification Statement<br>The purchaser agrees to defend, indemnify and hold Rev Ambulance<br>Group harmless from any claims, costs (including actual attorneys' fees),<br>damages and liabilities caused in whole or in part by any alteration or<br>modification of, or changes or additions to the purchased products OR use<br>of product for purposes it was not designed or intended for. | 1   |           |
| <b>== Factory Ship Loose - EMS Equipment - 1.017 11/12/21 ==</b> |   |  |     |           |



# BURGESS DEMO F-550 4 X 4 ULTRAMEDIC PASS-THROUGH

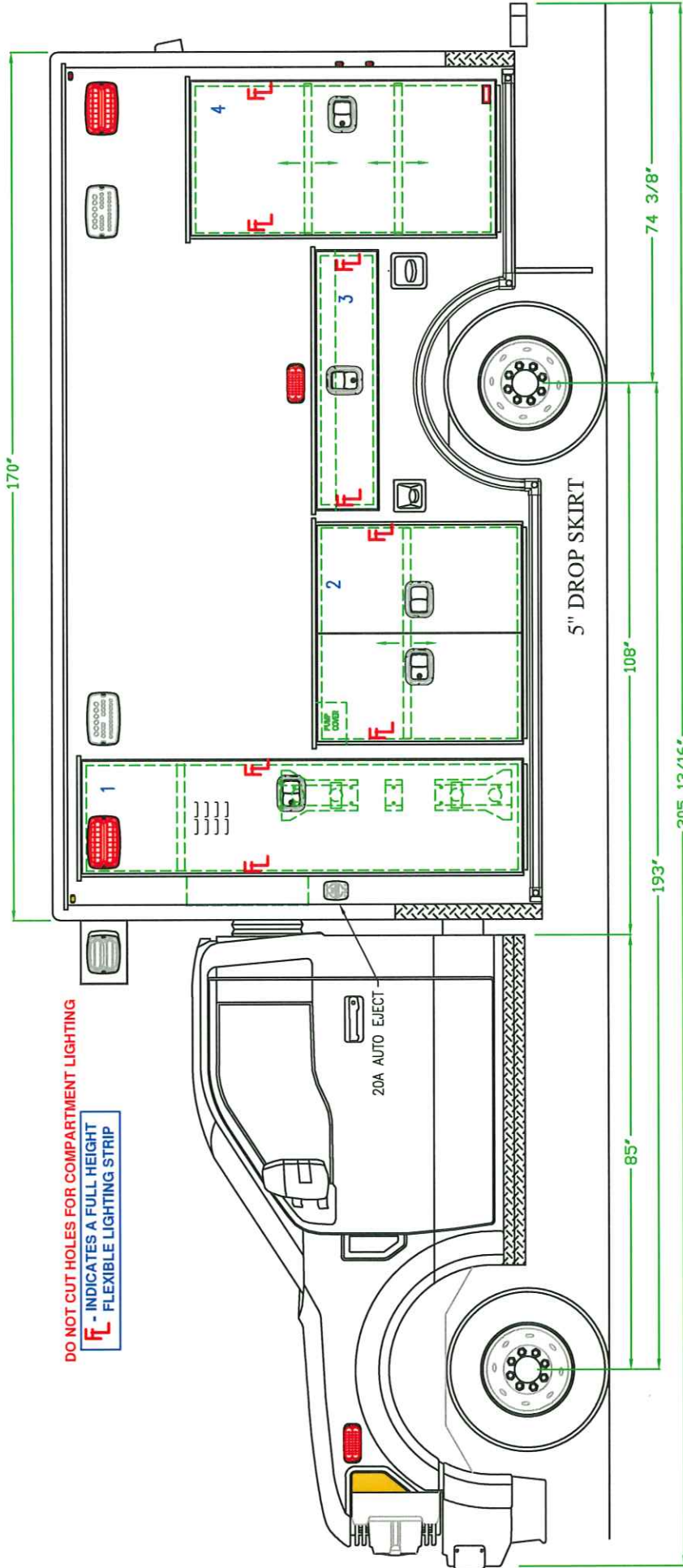

PROPRIETARY AND CONFIDENTIAL  
THIS INFORMATION CONTAINED IN THIS DRAWING IS THE SOLE PROPERTY OF ROAD RESCUE ANY REPRODUCTION IN PART OR AS A WHOLE WITHOUT THE WRITTEN PERMISSION OF ROAD RESCUE IS PROHIBITED.

NOTES:  
DETAILS ARE CONCEPTUAL ONLY LAYOUT AND ALL DIMENSIONS ARE APPROXIMATE AND SUBJECT TO MODIFICATION BY DESIGN ENGINEERING.

| 100R NO. | INTERIOR DIMENSIONS |        | NOTES  |                                       |
|----------|---------------------|--------|--------|---------------------------------------|
|          | HEIGHT              | WIDTH  |        | DEPTH                                 |
| 1        | 86.50"              | 23.25" | 22.00" | FIXED SHELF, DOOR LOUVERS, O2 STORAGE |
| 2        | 40.50"              | 43.88" | 21.25" | SPARE TIRE STORAGE                    |
| 4        | 59.06"              | 31.00" | 21.25" | (2) ADJ. SHELVES                      |

**Road Rescue**  
2737 N. Forsyth Rd  
Winter Park, FL 32792  
PHONE 800-932-7077 FAX 800-513-2688  
www.roadrescue.com

DATE: 06/21/2023  
REVISION 1: 08/08/2023

REVISION 2  
REVISION 3

SCALE: SHEET 1 OF 10

BID NUMBER: 619163

STREETSIDE EXTERIOR DETAIL

NOTE: THIS DRAWING IS SUBJECT TO CHANGE PENDING ROAD RESCUE PRODUCTION ENGINEERING APPROVAL. © ROAD RESCUE ALL RIGHTS RESERVED.



# BURGESS DEMO F-550 4 X 4 ULTRAMEDIC PASS-THROUGH

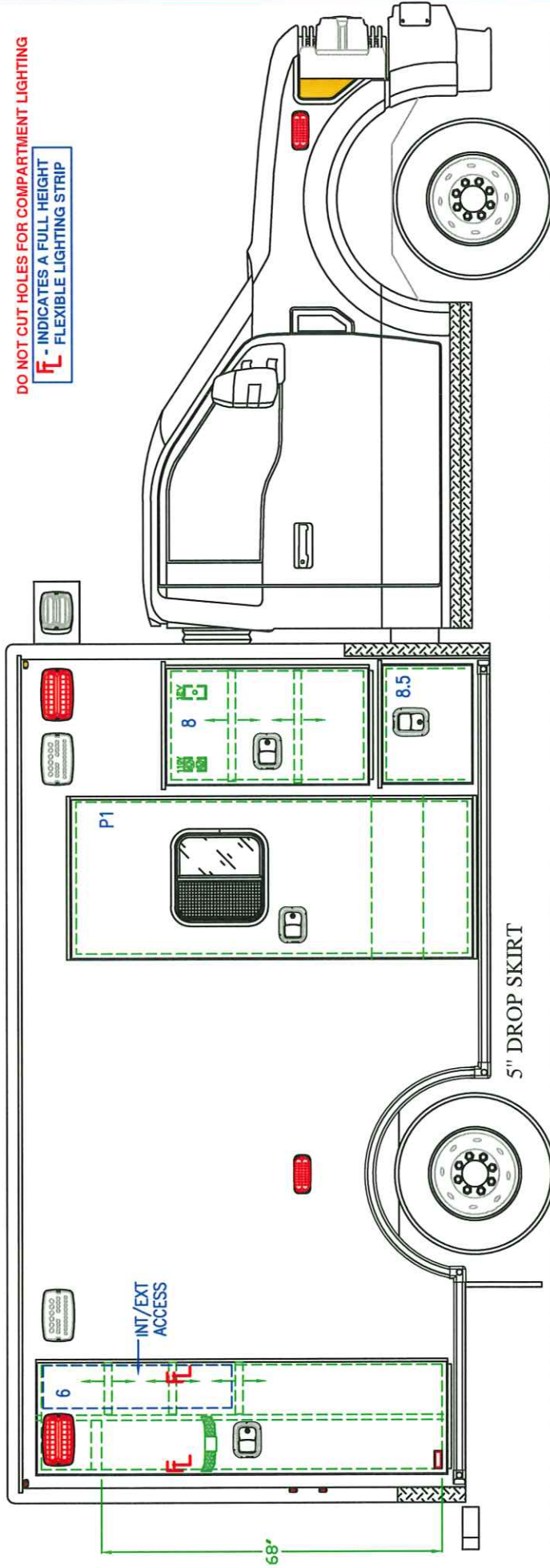

| DOOR NO.   | INTERIOR DIMENSIONS |        | DOOR DIMENSIONS |        | MISC. NOTES                         |
|--|---------------------|--------|-----------------|--------|-------------------------------------|
|  | HEIGHT              | WIDTH  | HEIGHT          | WIDTH  |                                     |
| 6  | 81.50"              | 22.75" | 40.00"          | 23.00" | (1) FIXED DIVIDER, (3) ADJ. SHELVES |
| 8.5  | 17.50"              | 23.00" | 80.00"          | 30.06" | BATTERY DRAWER                      |
| DETAILS ARE CONCEPTUAL ONLY LAYOUT AND ALL DIMENSIONS ARE APPROXIMATE AND SUBJECT TO MODIFICATION BY DESIGN ENGINEERING. |                     |        |                 |        |                                     |

PROPRIETARY AND CONFIDENTIAL  
THIS INFORMATION CONTAINED IN THIS DRAWING IS THE SOLE PROPERTY OF ROAD RESCUE ANY REPRODUCTION IN PART OR AS A WHOLE WITHOUT THE WRITTEN PERMISSION OF ROAD RESCUE IS PROHIBITED.

**Road Rescue** 2737 N. Forsyth Rd Winter Park, FL 32792  
 PHONE 800-932-7077 FAX 800-513-2688  
 DATE 06/21/2023 REVISION 1 08/08/2023

**Road Rescue** CURBSIDE EXTERIOR DETAIL  
 SHEET 2 OF 10

BID NUMBER 619163

NOTE: THIS DRAWING IS SUBJECT TO CHANGE PENDING ROAD RESCUE PRODUCTION ENGINEERING APPROVAL. © ROAD RESCUE ALL RIGHTS RESERVED.





# BURGESS DEMO F-550 4 X 4 ULTRAMEDIC PASS-THROUGH

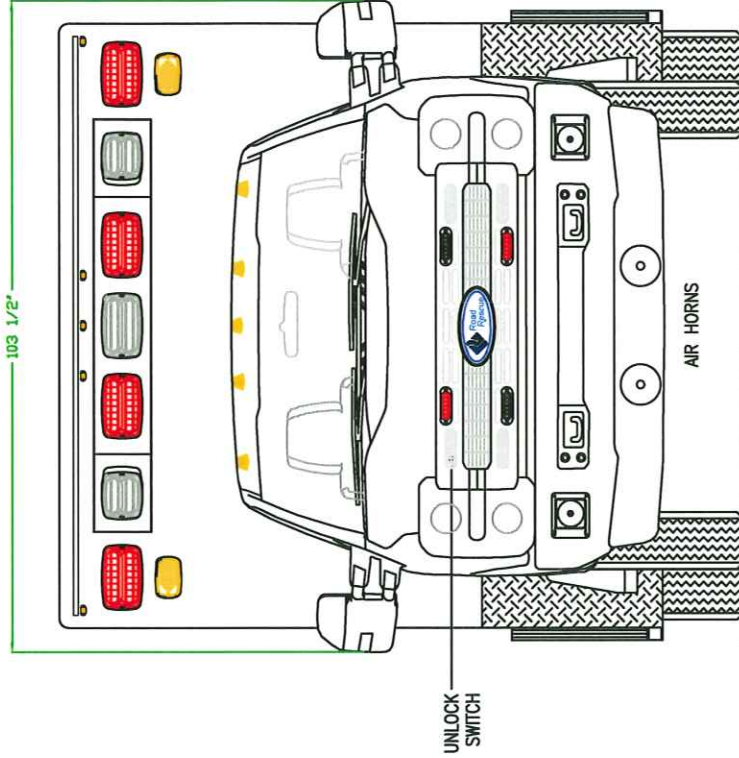
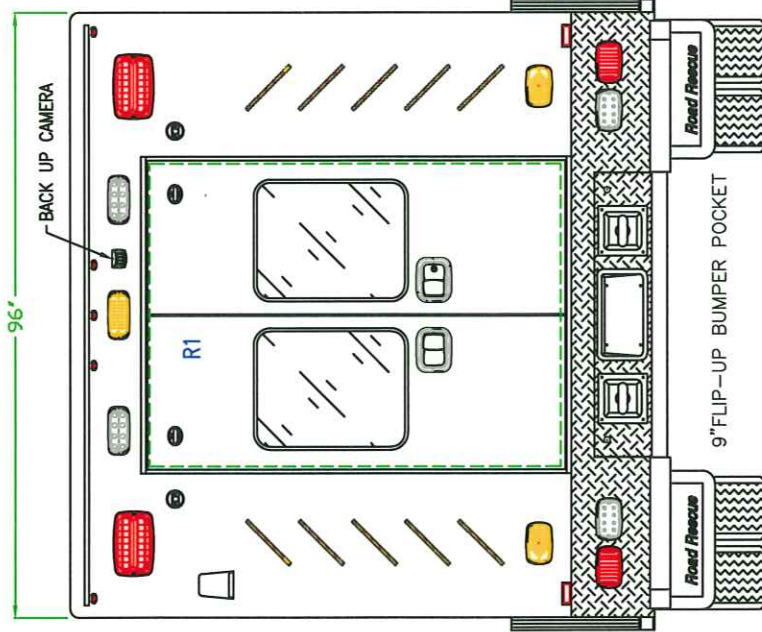

PROPRIETARY AND CONFIDENTIAL  
THIS INFORMATION CONTAINED IN THIS DRAWING IS THE SOLE PROPERTY OF ROAD RESCUE ANY REPRODUCTION IN PART OR AS A WHOLE WITHOUT THE WRITTEN PERMISSION OF ROAD RESCUE IS PROHIBITED.

DETAILS ARE CONCEPTUAL ONLY LAYOUT AND ALL DIMENSIONS ARE APPROXIMATE AND SUBJECT TO MODIFICATION BY DESIGN ENGINEERING.

| DOOR NO. | CLEAR OPENING HEIGHT | WIDTH  | DEPTH     | NOTES                |
|----------|----------------------|--------|-----------|----------------------|
| R1       | 61.44"               | 50.25" | 18" X 24" | FIXED TINTED WINDOWS |
|          |                      |        |           |                      |
|          |                      |        |           |                      |

**Road Rescue** 2737 N. Forsyth Rd. Winter Park, FL 32792  
 PHONE 800-932-7077 FAX 800-513-2688  
 DATE 06/21/2023 REVISION 1 08/08/2023

## FRONT & REAR EXTERIOR DETAIL

BID NUMBER **619163**

SHEET 3 OF 10

NOTE: THIS DRAWING IS SUBJECT TO CHANGE PENDING ROAD RESCUE PRODUCTION ENGINEERING APPROVAL. © ROAD RESCUE ALL RIGHTS RESERVED.



# BURGESS DEMO F-550 4 X 4 ULTRAMEDIC PASS-THROUGH

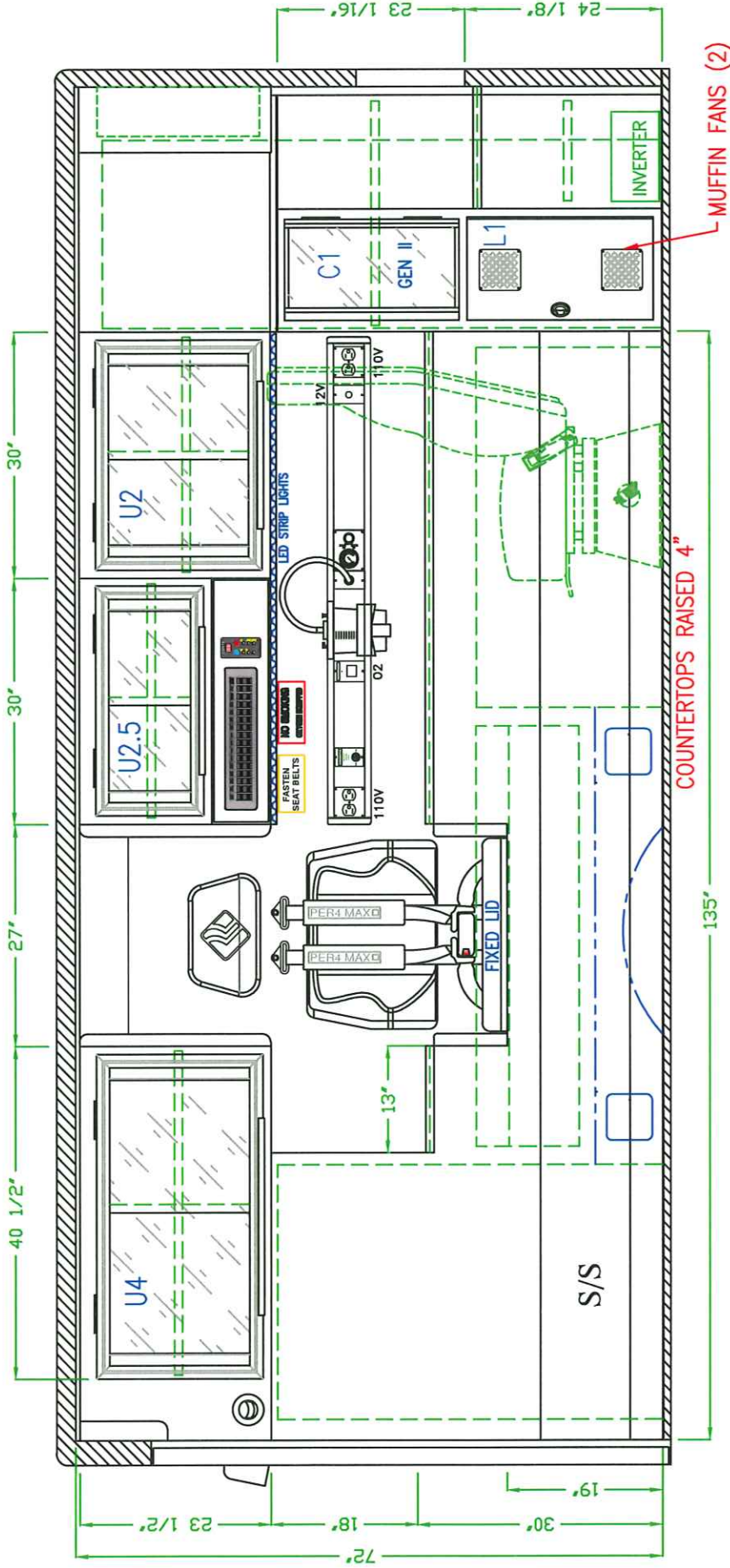

| DOOR NO. | INTERIOR DIMENSIONS |        | DOOR NO. | INTERIOR DIMENSIONS |        | MISC. NOTES                                    |
|----------|---------------------|--------|----------|---------------------|--------|--|
|          | HEIGHT              | WIDTH  |          | HEIGHT              | DEPTH  |  |
| C1       | 23.00"              | 28.50" | U4       | 23.50"              | 40.50" | SLIDING POLY DOORS, (1) ADJ. SHELF, RESTOCKING |
| L1       | 23.62"              | 28.50" |          |                     |        | SINGLE ALUM. DOOR,                             |
| U2       | 23.50"              | 29.62" |          |                     |        | SLIDING POLY DOORS, (1) ADJ. SHELF, RESTOCKING |
| J2.5     | 16.00"              | 29.62" |          |                     |        | SLIDING POLY DOORS, (1) ADJ. SHELF, RESTOCKING |

PROPRIETARY AND CONFIDENTIAL  
THIS INFORMATION CONTAINED IN THIS DRAWING IS THE SOLE PROPERTY OF ROAD RESCUE ANY REPRODUCTION IN PART OR AS A WHOLE WITHOUT THE WRITTEN PERMISSION OF ROAD RESCUE IS PROHIBITED.

DETAILS ARE CONCEPTUAL ONLY. LAYOUT AND DIMENSIONS ARE APPROXIMATE AND SUBJECT TO MODIFICATION BY DESIGN ENGINEERING

**Road Rescue**  
 2737 N. Forsyth Rd.  
 Winter Park, FL 32792  
 www.roadrescue.com PHONE 800-932-7077 FAX 800-513-2688

RAWN BY DATE 06/21/2023  
 REVISION 1 08/08/2023

REVISION 2  
 REVISION 3

SCALE SHEET 4 OF 10

BID NUMBER 619163

STREETSIDE INTERIOR DETAIL

NOTE: THIS DRAWING IS SUBJECT TO CHANGE PENDING ROAD RESCUE PRODUCTION ENGINEERING APPROVAL. © ROAD RESCUE ALL RIGHTS RESERVED.



# BURGESS DEMO F-550 4 X 4 ULTRAMEDIC PASS-THROUGH

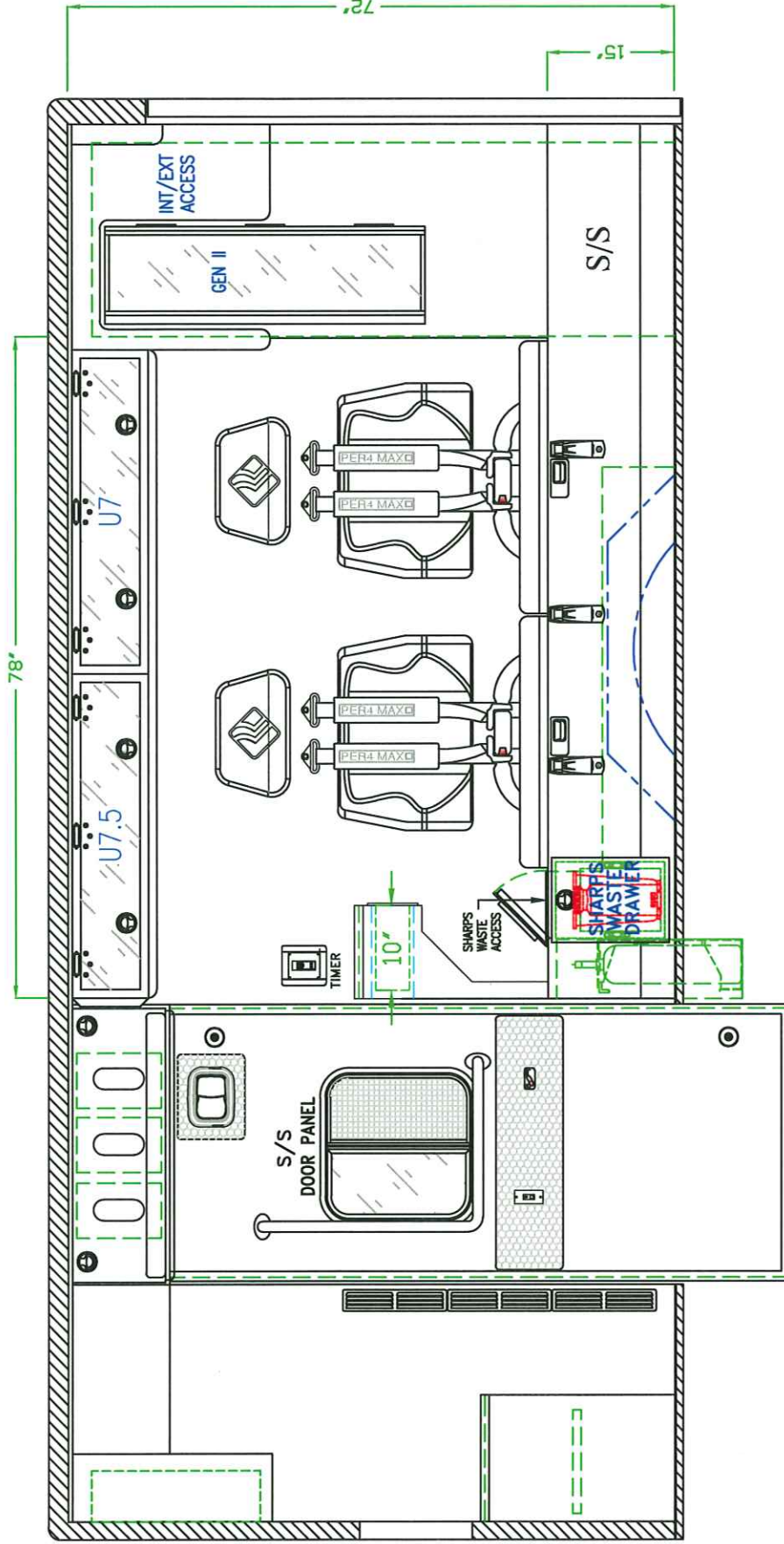

PROPRIETARY AND CONFIDENTIAL  
THIS INFORMATION CONTAINED IN THIS DRAWING IS THE SOLE PROPERTY OF ROAD RESCUE ANY REPRODUCTION IN PART OR AS A WHOLE WITHOUT THE WRITTEN PERMISSION OF ROAD RESCUE IS PROHIBITED.

DETAILS ARE CONCEPTUAL ONLY. LAYOUT AND DIMENSIONS ARE APPROXIMATE AND SUBJECT TO MODIFICATION BY DESIGN ENGINEERING

| ROOM NO. | INTERIOR DIMENSIONS | NOTES  |       |                               |
|----------|---------------------|--------|-------|-------------------------------|
| NO.      | HEIGHT              | WIDTH  | DEPTH |                               |
| U7       | 9.00"               | 40.00" | 8.50" | LIFT UP POLY DOOR, RESTOCKING |
| J7.5     | 9.00"               | 38.00" | 8.50" | LIFT UP POLY DOOR, RESTOCKING |

**Road Rescue** 2737 N. Forsyth Rd. Winter Park, FL 32792  
 www.roadrescue.com PHONE 800-932-7077 FAX 800-513-2688

DATE 06/21/2023 REVISION 1 08/08/2023  
 DRAWN BY DG

REVISION 2 REVISION 3 SCALE SHEET 5 OF 10

**BID NUMBER** 619163

**CURBSIDE INTERIOR DETAIL**

NOTE: THIS DRAWING IS SUBJECT TO CHANGE PENDING ROAD RESCUE PRODUCTION ENGINEERING APPROVAL. © ROAD RESCUE ALL RIGHTS RESERVED.



# BURGESS DEMO F-550 4 X 4 ULTRAMEDIC PASS-THROUGH

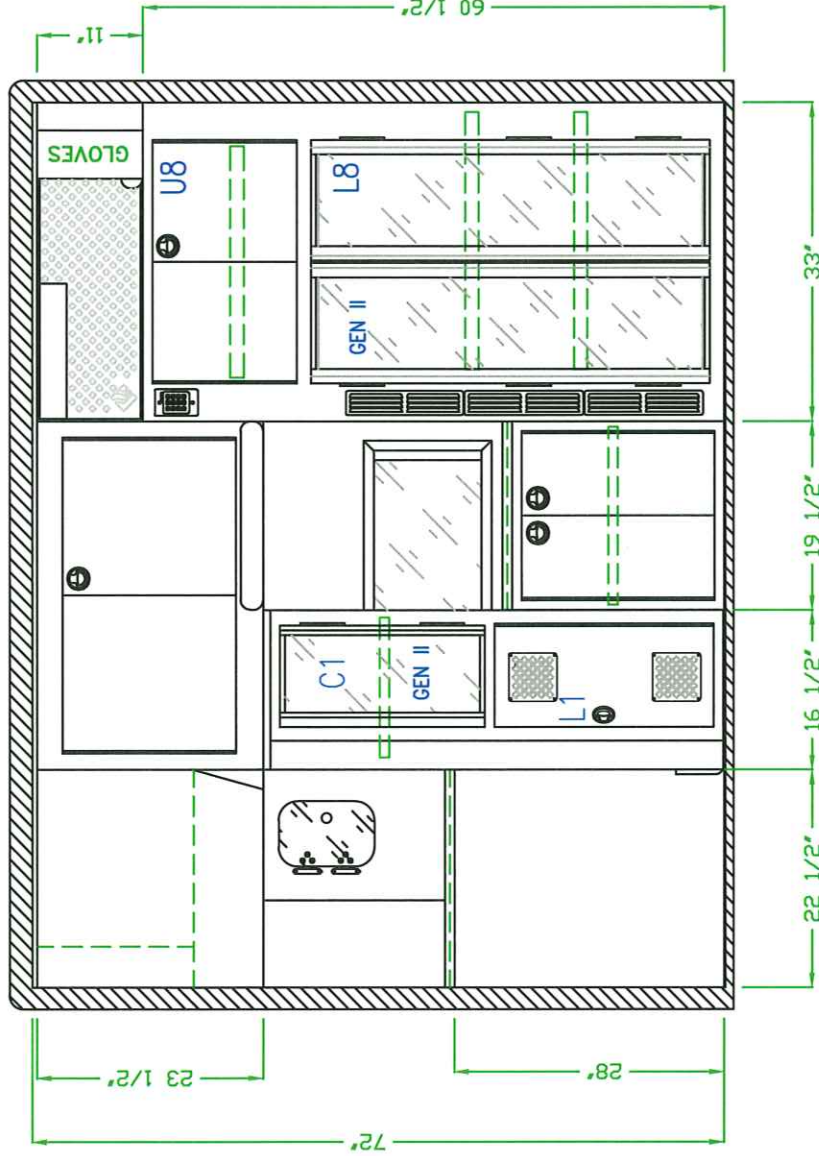

PROPRIETARY AND CONFIDENTIAL  
THIS INFORMATION CONTAINED IN THIS DRAWING IS THE SOLE PROPERTY OF ROAD RESCUE ANY REPRODUCTION IN PART OR AS A WHOLE WITHOUT THE WRITTEN PERMISSION OF ROAD RESCUE IS PROHIBITED.

DETAILS ARE CONCEPTUAL ONLY. LAYOUT AND DIMENSIONS ARE APPROXIMATE AND SUBJECT TO MODIFICATION BY DESIGN ENGINEERING

| DOOR NO. | INTERIOR DIMENSIONS | NOTES  |        |   |
|----------|---------------------|--------|--------|---|
| NO.      | HEIGHT              | WIDTH  | DEPTH  |   |
| U8       | 16.00"              | 28.00" | 26.00" | DOUBLE SOLID DOORS, (1) ADJ. SHELF, ELECTRIC LOCK |
| L8       | 25.00"              | 28.00" | 26.00" | GEN II OHO DOORS, (1) ADJ. SHELF                  |

BID NUMBER  
**619163**

**FRONT INTERIOR DETAIL**

SHEET 6 OF 10

|  |                          |            |            |       |
|--|--------------------------|------------|------------|-------|
| 2737 N. Forsyth Rd.<br>Winter Park, FL 32792 | REVISION 1<br>08/08/2023 | REVISION 2 | REVISION 3 | SCALE |
| PHONE 800-932-7077                           | DATE<br>06/21/2023       |            |            |       |
| FAX 800-513-2888                             |                          |            |            |       |

**Road Rescue**  
www.roadrescue.com

NOTE: THIS DRAWING IS SUBJECT TO CHANGE PENDING ROAD RESCUE PRODUCTION ENGINEERING APPROVAL. © ROAD RESCUE ALL RIGHTS RESERVED.



# BURGESS DEMO F-550 4 X 4 ULTRAMEDIC PASS-THROUGH

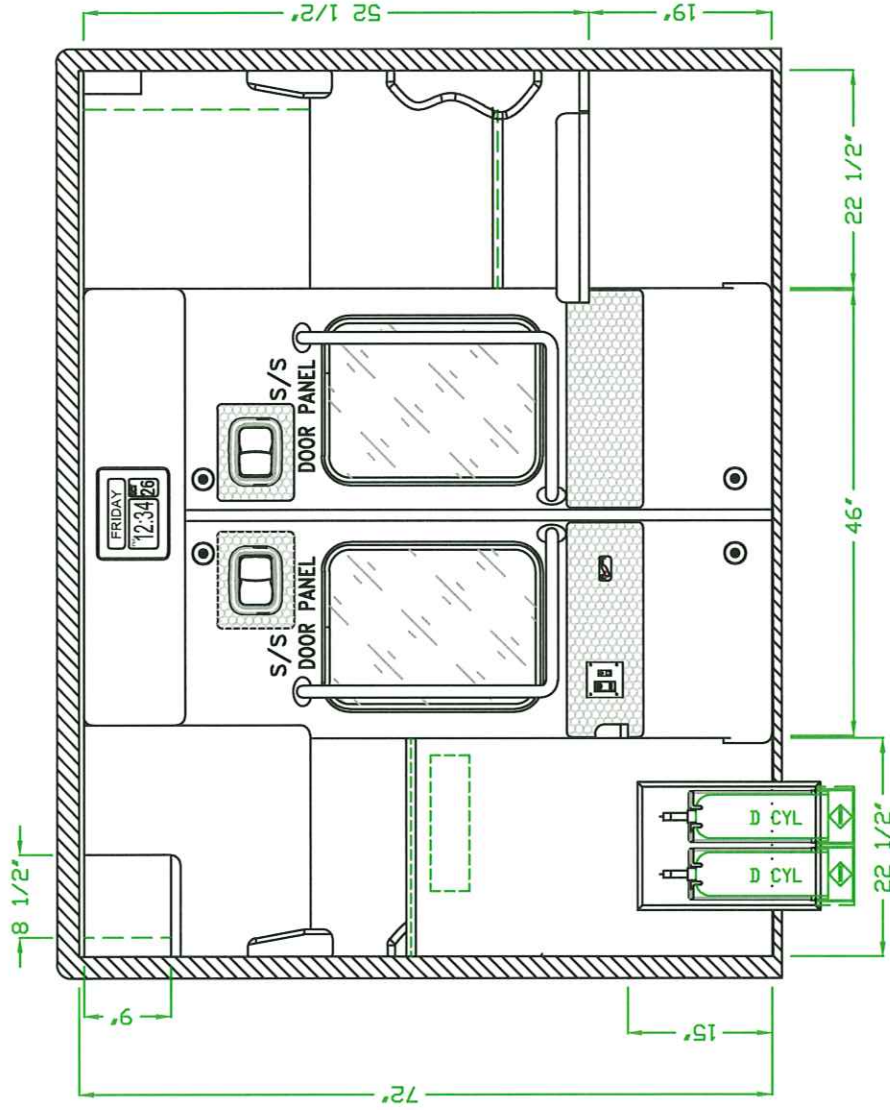

PROPRIETARY AND CONFIDENTIAL  
THIS INFORMATION CONTAINED IN THIS DRAWING IS THE SOLE PROPERTY OF ROAD RESCUE ANY REPRODUCTION IN PART OR AS A WHOLE WITHOUT THE WRITTEN PERMISSION OF ROAD RESCUE IS PROHIBITED.

DETAILS ARE CONCEPTUAL ONLY. LAYOUT AND DIMENSIONS ARE APPROXIMATE AND SUBJECT TO MODIFICATION BY DESIGN ENGINEERING

BID NUMBER

## REAR INTERIOR DETAIL

2737 N. Forsyth Rd.  
Winter Park, FL 32792

www.roadrescue.com PHONE 800-932-7077 FAX 800-513-2888

RAWN BY DATE 06/21/2023

REVISION 1

REVISION 2

REVISION 3

SCALE

SHEET 7 OF 10



NOTE: THIS DRAWING IS SUBJECT TO CHANGE PENDING ROAD RESCUE PRODUCTION ENGINEERING APPROVAL. © ROAD RESCUE ALL RIGHTS RESERVED.



# BURGESS DEMO F-550 4 X 4 ULTRAMEDIC PASS-THROUGH

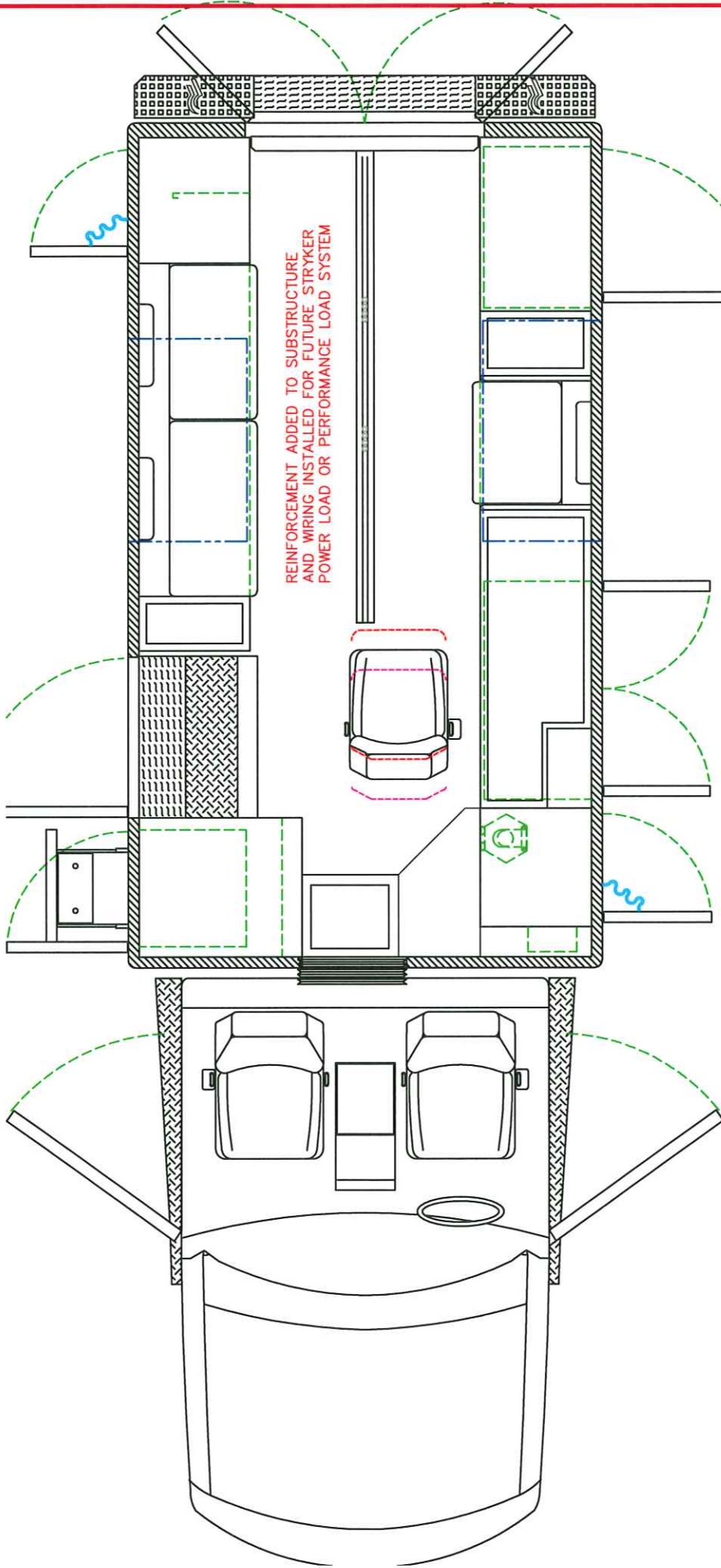

PROPRIETARY AND CONFIDENTIAL  
THIS INFORMATION CONTAINED IN THIS DRAWING IS THE SOLE PROPERTY OF ROAD RESCUE ANY REPRODUCTION IN PART OR AS A WHOLE WITHOUT THE WRITTEN PERMISSION OF ROAD RESCUE IS PROHIBITED.

DETAILS ARE CONCEPTUAL ONLY LAYOUT AND ALL DIMENSIONS ARE APPROXIMATE AND SUBJECT TO MODIFICATION BY DESIGN ENGINEERING.

|  |                    |  |               |
|--|--------------------|--|---------------|
| <b>Road Rescue</b><br>www.roadrescue.com PHONE 800-932-7077 FAX 800-513-2688 |                    | 2737 N. Forsyth Rd.<br>Winter Park, FL 32792 |               |
| RAWN BY<br>DG  | DATE<br>06/21/2023 | REVISION 1<br>08/08/2023                     | REVISION 2    |
| REVISION 3   |                    | SCALE  | SHEET 8 OF 10 |
| <b>FLOOR DETAIL</b>  |                    | BID NUMBER                                   | <b>619163</b> |

NOTE: THIS DRAWING IS SUBJECT TO CHANGE PENDING ROAD RESCUE PRODUCTION ENGINEERING APPROVAL. © ROAD RESCUE ALL RIGHTS RESERVED.



# BURGESS DEMO F-550 4 X 4 ULTRAMEDIC PASS-THROUGH

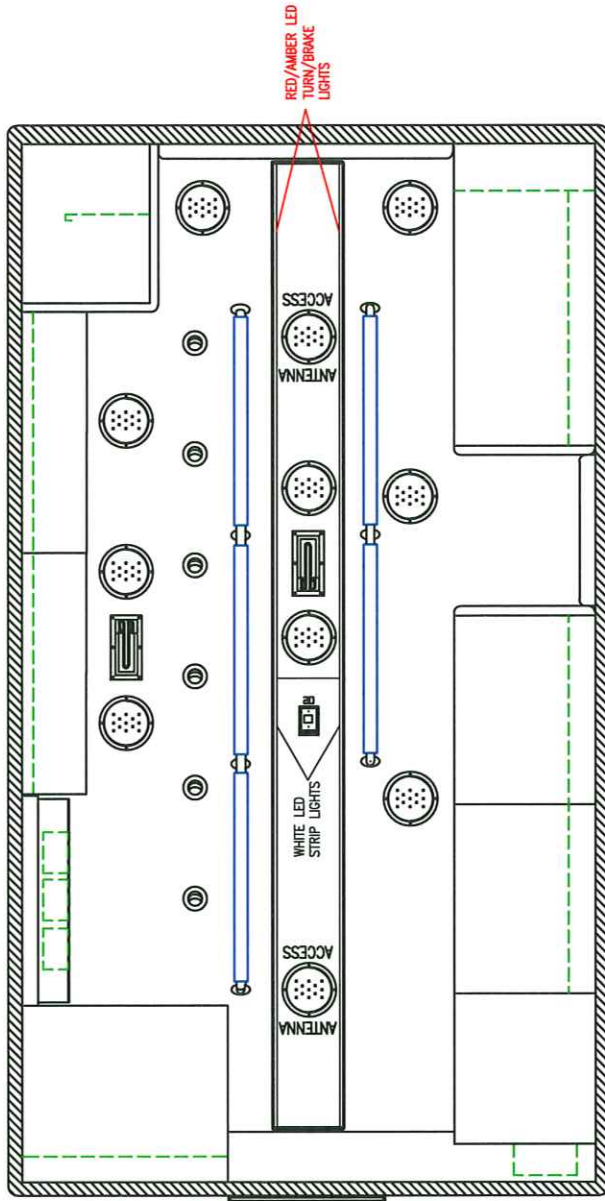
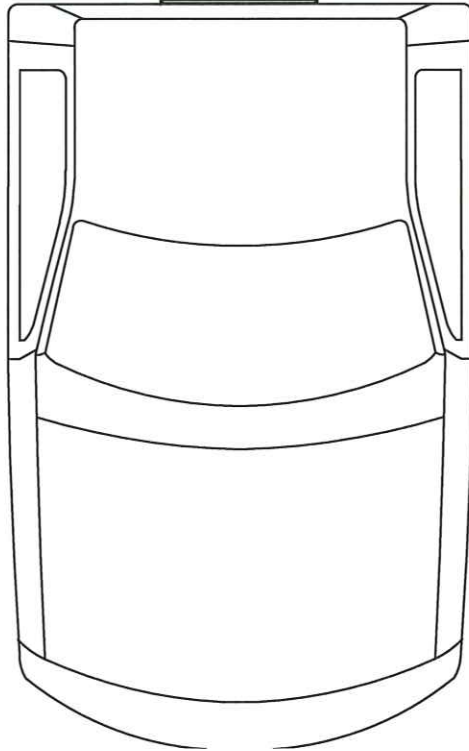

PROPRIETARY AND CONFIDENTIAL  
THIS INFORMATION CONTAINED IN THIS DRAWING IS THE SOLE PROPERTY OF ROAD RESCUE ANY REPRODUCTION IN PART OR AS A WHOLE WITHOUT THE WRITTEN PERMISSION OF ROAD RESCUE IS PROHIBITED.

DETAILS ARE CONCEPTUAL ONLY LAYOUT AND ALL DIMENSIONS ARE APPROXIMATE AND SUBJECT TO MODIFICATION BY DESIGN ENGINEERING.

|                    |            |  |                  |                       |            |            |        |
|--------------------|------------|--|------------------|-----------------------|------------|------------|--------|
| <b>Road Rescue</b> |            | 2737 N. Forsyth Rd.<br>Winter Park, FL 32792 |                  | <b>CEILING DETAIL</b> |            | BID NUMBER |        |
| www.roadrescue.com |            | PHONE 800-932-7077                           | FAX 800-513-2688 | REVISION 2            | REVISION 3 | SCALE      | 619163 |
| RAWN BY            | DATE       | REVISION 1                                   |                  |                       |            |            |        |
| DG                 | 06/21/2023 |  |                  |                       |            |            |        |

NOTE: THIS DRAWING IS SUBJECT TO CHANGE PENDING ROAD RESCUE PRODUCTION ENGINEERING APPROVAL. © ROAD RESCUE ALL RIGHTS RESERVED.



# BURGESS DEMO F-550 ULTRAMEDIC // PASS-THROUGH



BLACK POLYURETHANE COATED

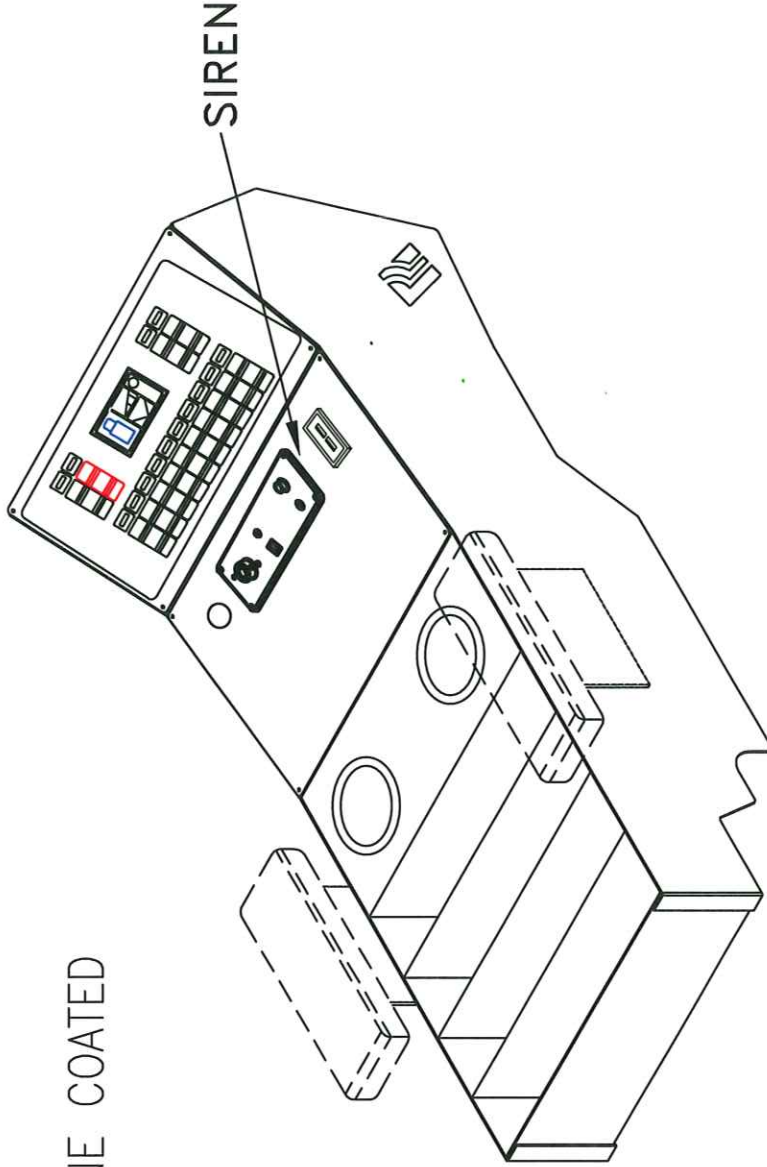

PROPRIETARY AND CONFIDENTIAL  
THIS INFORMATION CONTAINED IN THIS DRAWING IS THE SOLE PROPERTY OF ROAD RESCUE ANY REPRODUCTION IN PART OR AS A WHOLE WITHOUT THE WRITTEN PERMISSION OF ROAD RESCUE IS PROHIBITED

DETAILS ARE CONCEPTUAL ONLY. LAYOUT AND ALL DIMENSIONS ARE APPROXIMATE AND SUBJECT TO MODIFICATION BY DESIGN ENGINEERING.

|                              |      |  |            |                   |                |
|------------------------------|------|--|------------|-------------------|----------------|
| <b>Road Rescue</b>           |      | 2737 N. Forsyth Rd.<br>Winter Park, FL 32792 |            | <b>BID NUMBER</b> |                |
| www.roadrescue.com           |      | PHONE 800-932-7077 FAX 800-513-2688          |            | 619163            |                |
| DRAWN BY                     | DATE | REVISION 1                                   | REVISION 2 | REVISION 3        | SCALE          |
|                              |      |  |            |                   | SHEET 10 OF 10 |
| <b>CONSOLE CONFIGURATION</b> |      |  |            | <b>BID NUMBER</b> |                |
|                              |      |  |            | 619163            |                |

NOTE: THIS DRAWING IS SUBJECT TO CHANGE PENDING ROAD RESCUE PRODUCTION ENGINEERING APPROVAL. © ROAD RESCUE ALL RIGHTS RESERVED.